



WESTSHORE
CITY CENTER

1111 - 1411 N. WESTSHORE BOULEVARD
TAMPA, FL 33607

WESTSHORE FACTS

-  4,000 BUSINESSES
-  100,000 EMPLOYEES
-  13.2 MILLION SF OF OFFICE
-  45 HOTELS WITH 8,000+ ROOMS
-  250+ RESTAURANTS
-  350 STORES
-  15,000 RESIDENTS & GROWING
-  TAMPA INTERNATIONAL AIRPORT

PROPERTY HIGHLIGHTS

- » Westshore City Center, formerly known as the Austin Center, hosts 300,000 square feet of the bustling area's office space in its 5 office towers along North Westshore Boulevard.
- » With the most competitive rates in Westshore, your office will benefit from the ease of access to I-275 and other major corridors, close proximity to shopping and dining, as well as major residential and commercial growth.
- » Over 4,000 businesses draw employees and customers to the Westshore District each day. Not only do more people work in the Westshore business district than downtown Tampa, but it is also the largest office market in all of Florida.

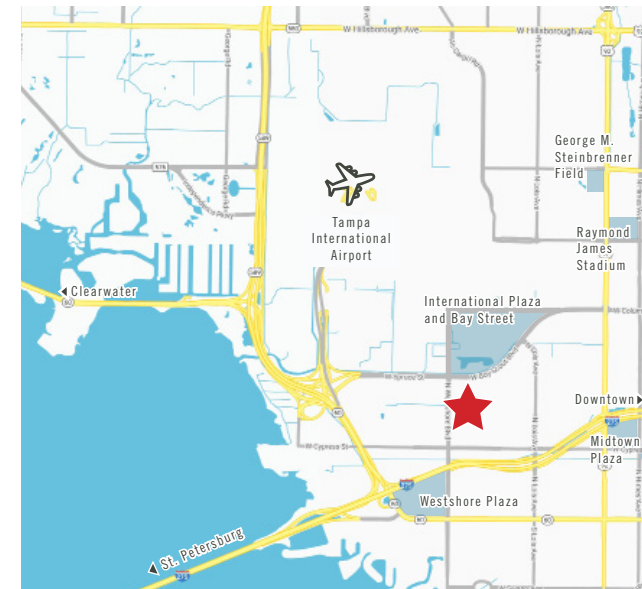

MATT ALEXANDER | DIRECTOR
MATTHEW.ALEXANDER@FRANKLINST.COM | 813.559.2006

LORENZO GONZALEZ | SENIOR ASSOCIATE
LORENZO.GONZALEZ@FRANKLINST.COM | 813.793.8461



Licensed Real Estate Broker | FranklinSt.com

1111 NORTH WESTSHORE BOULEVARD



SUITES AVAILABLE SF

208	870
215	1,564
307	2,966
510	3,765

1211 NORTH WESTSHORE BOULEVARD



SUITES AVAILABLE SF

110	3,015
310	789 (Feb. 1, 2025)
402	1,745 (Jan. 1, 2025)
404	625
411	628 (Jan. 1, 2025)
500	1,545
511	1,524
650	3,013
700	6,000 - 11,224

1311 NORTH WESTSHORE BOULEVARD



**NO SUITES
CURRENTLY AVAILABLE**

1401 NORTH WESTSHORE BOULEVARD



**NO SUITES
CURRENTLY AVAILABLE**

1411 NORTH WESTSHORE BOULEVARD



**NO SUITES
CURRENTLY AVAILABLE**



**WESTSHORE
CITY CENTER**

**LEARN MORE AT
WESTSHORECITYCENTER.COM**

WESTSHORE CITY CENTER SITE PLAN

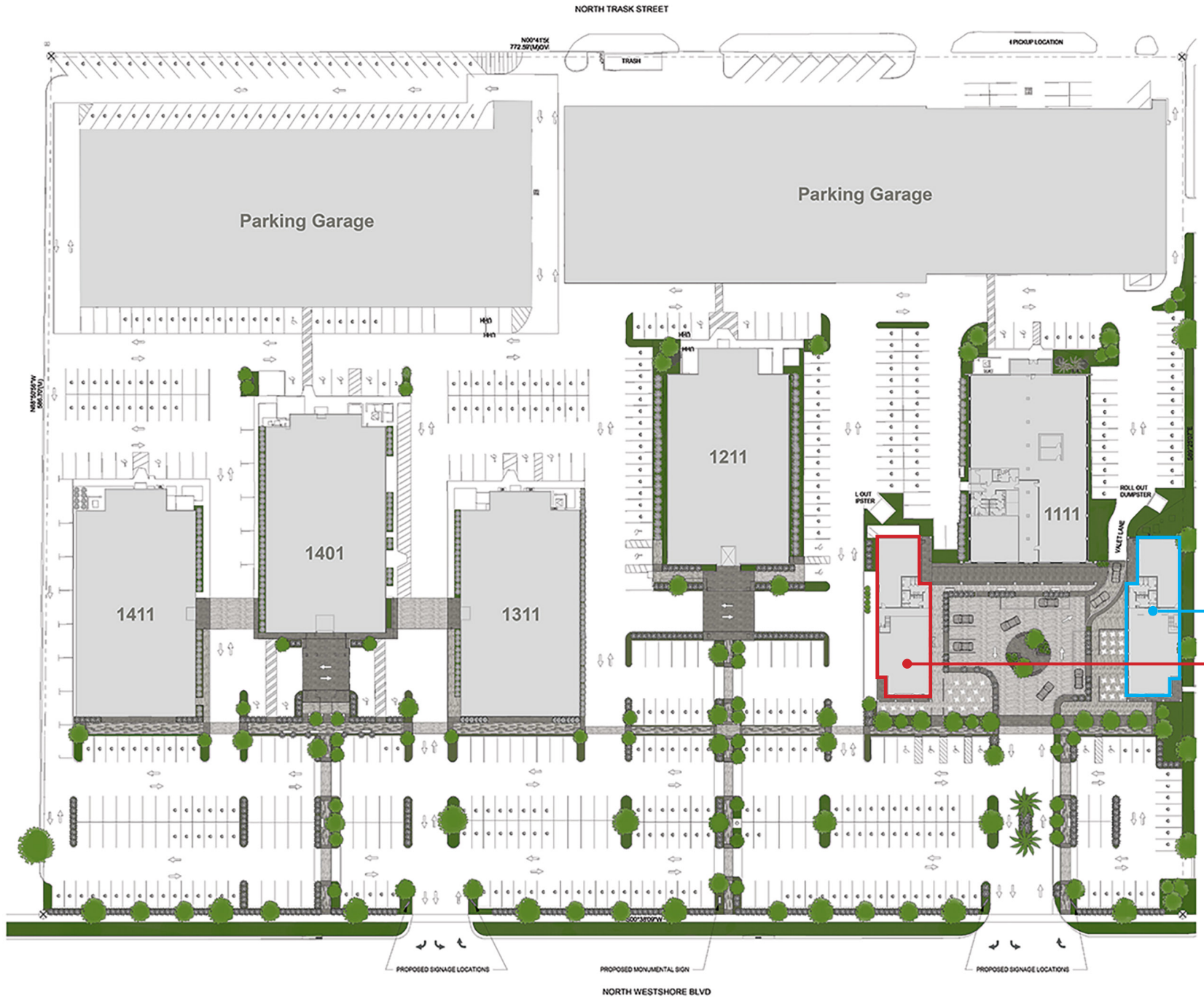

MATT ALEXANDER | DIRECTOR
 MATTHEW.ALEXANDER@FRANKLINST.COM | 813.559.2006

LORENZO GONZALEZ | SENIOR ASSOCIATE
 LORENZO.GONZALEZ@FRANKLINST.COM | 813.793.8461

FranklinStreet
 Licensed Real Estate Broker | FranklinSt.com