



# For lease

1106-1128 Solana Avenue, Winter Park, FL  
5,000 RSF available

 SEE A BRIGHTER WAY

# Property details

## Unit 1118

- 5,000 SF
- 400 SF of office
- One 14' x 14' grade door
- One rail door
- 16' - 18' clear height
- Available February 1, 2025
- Please call for lease rate

## Building specifications

- 76,655 SF
- Grade level
- Front load
- Clear span
- Built in 1950
- Zoning I-1, City of Winter Park

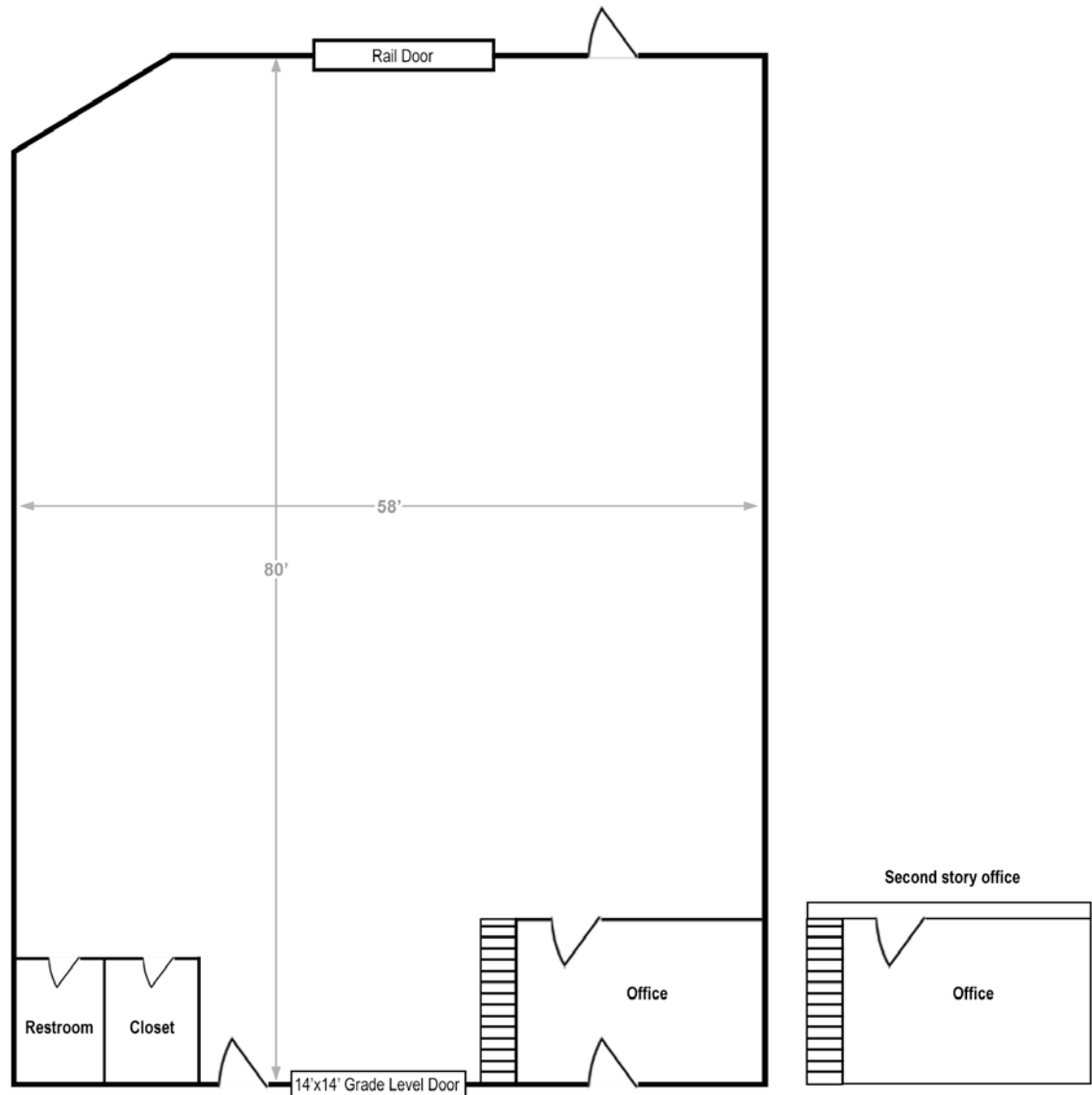



# Area amenities



## Location

### Advantages

- Offers immediate access to US Highway 17-92 and historic downtown Winter Park
- Less than 20 minutes to Interstate 4, Central Florida Greenway (SR 417), East-West Expressway (SR 408), and Florida's Turnpike, providing access to all of Central Florida and beyond
- Nearby points of interest include Winter Park Village, Rollins College, the new Winter Park Library and Events Center, Orlando Science Center, Orlando Museum of Art, AdventHealth Orlando and Winter Park, Mead Botanical Garden, Harry P Leu Gardens, and Maitland Center
- Over 1.5 million people within a 30 minute drive time

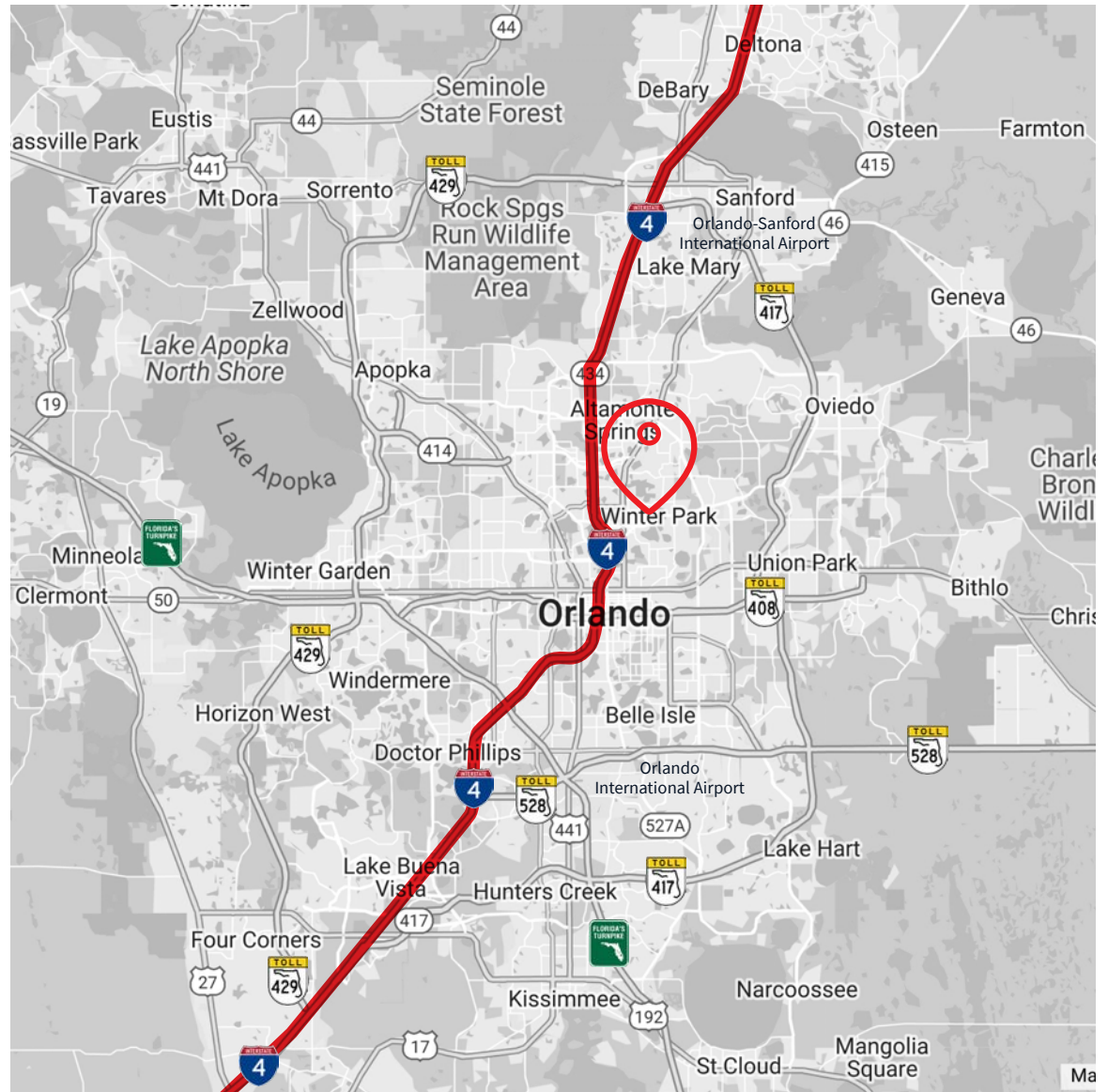



**JLL**

**Kristin Bailey**

*Senior Associate*

Kristin.Bailey@jll.com

+1 407 739 8285

Although information has been obtained from sources deemed reliable, JLL does not make any guarantees, warranties or representations, express or implied, as to the completeness or accuracy as to the information contained herein. Any projections, opinions, assumptions or estimates used are for example only. There may be differences between projected and actual results, and those differences may be material. JLL does not accept any liability for any loss or damage suffered by any party resulting from reliance on this information. If the recipient of this information has signed a confidentiality agreement with JLL regarding this matter, this information is subject to the terms of that agreement. ©2024. Jones Lang LaSalle Brokerage, Inc. All rights reserved.

Jones Lang LaSalle Brokerage, Inc., a licensed real estate broker across the US | 250 South Orange Avenue, Suite 700P, Orlando, FL 32801