

PROPERTY FEATURES

SIZE: ±2,460 SF on 11,322 SF Lot

PRICE: \$1,150,000

ZONING: [LAC1.5](#)

APN: 7421-021-031 & 7421-021-030

- Large Fenced & Paved Yard
- Freestanding Industrial Building
- Major Street Frontage
- Drive Through Capability
- Two (2) Oversized GL Doors (15' x 8')
- Minutes to 405, 110 & 710 Freeways

LOCAL EXPERTISE. INTERNATIONAL REACH. WORLD CLASS.

Brandon Carrillo

Principal | Cal DRE# 01745362

P: +1(562) 354-2510

E: bcarrillo@leelalb.com

Garrett Massaro, SIOR

Principal | Cal DRE# 01771471

P: +1(562) 354-2516

E: gmassaro@leelalb.com

Max P. Eddy

Associate | Cal DRE# 02163858

P: +1(562) 354-2538

E: meddy@leelalb.com

Copyright © Lee & Associates. All rights reserved. No part of this work may be reproduced or distributed without written permission of the copyright owner. The information contained in this report was gathered by Lee & Associates from sources believed to be reliable. Lee & Associates, however, makes no representation concerning the accuracy or completeness of such information and expressly disclaims any responsibility for any inaccuracy contained herein.

INDUSTRIAL FOR SALE

1559 N. AVALON BLVD, WILMINGTON, CA 90744



LOCAL EXPERTISE. INTERNATIONAL REACH. WORLD CLASS.

Brandon Carrillo

Principal | Cal DRE# 01745362

P: +1(562) 354-2510

E: bcarrillo@leelalb.com

Garrett Massaro, SIOR

Principal | Cal DRE# 01771471

P: +1(562) 354-2516

E: gmassaro@leelalb.com

Max P. Eddy

Associate | Cal DRE# 02163858

P: +1(562) 354-2538

E: meddy@leelalb.com

Copyright © Lee & Associates. All rights reserved. No part of this work may be reproduced or distributed without written permission of the copyright owner. The information contained in this report was gathered by Lee & Associates from sources believed to be reliable. Lee & Associates, however, makes no representation concerning the accuracy or completeness of such information and expressly disclaims any responsibility for any inaccuracy contained herein.

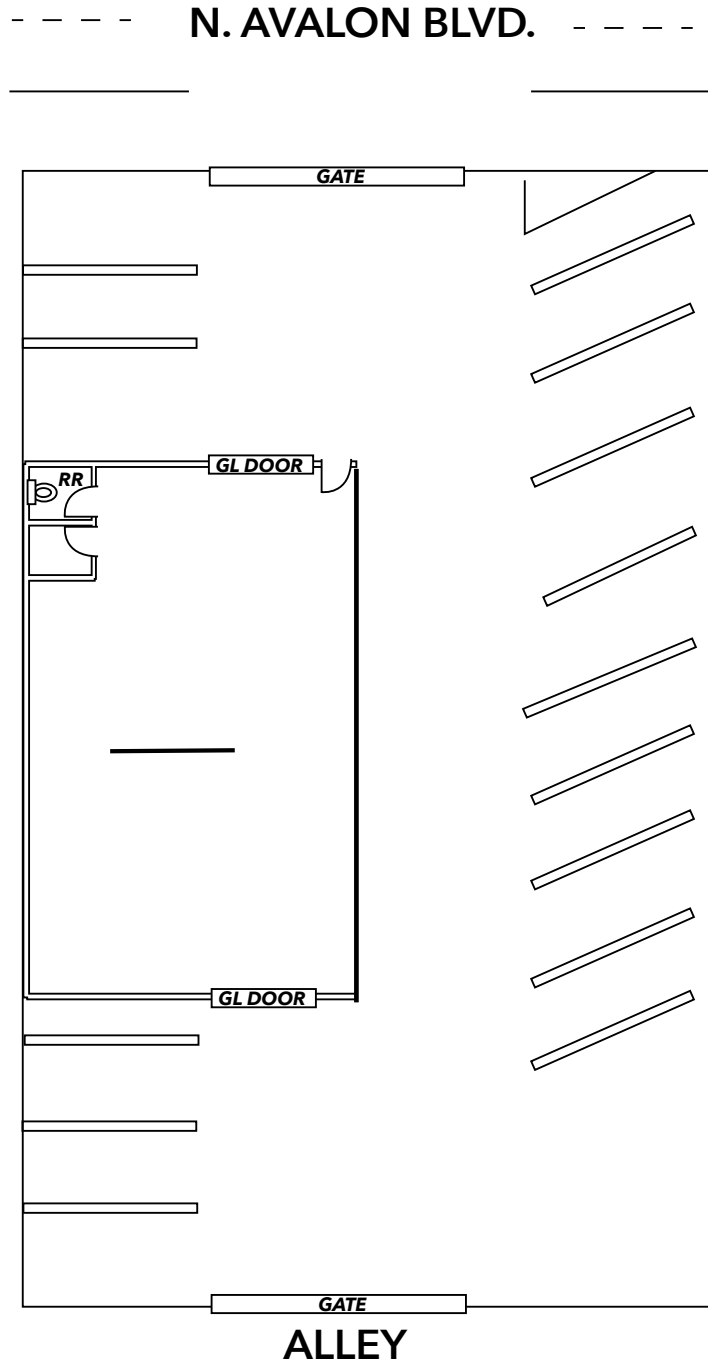

LOCAL EXPERTISE. INTERNATIONAL REACH. WORLD CLASS.

Brandon Carrillo

Principal | Cal DRE# 01745362

P: +1(562) 354-2510

E: bcarrillo@leelalb.com

Garrett Massaro, SIOR

Principal | Cal DRE# 01771471

P: +1(562) 354-2516

E: gmassaro@leelalb.com

Max P. Eddy

Associate | Cal DRE# 02163858

P: +1(562) 354-2538

E: meddy@leelalb.com

Copyright © Lee & Associates. All rights reserved. No part of this work may be reproduced or distributed without written permission of the copyright owner. The information contained in this report was gathered by Lee & Associates from sources believed to be reliable. Lee & Associates, however, makes no representation concerning the accuracy or completeness of such information and expressly disclaims any responsibility for any inaccuracy contained herein.