

Publix #0836 - Publix at Northgate

1395 6th Street NW
Winter Haven, FL 33881
Lat 28.034, Long -81.734

FOR LEASE



1,815 - 10,443 SF AVAILABLE

PROPERTY HIGHLIGHTS

- Polk County Market
- Publix-Anchored Center
- Attractive Façade Design
- Great Mix of Local and National Tenants
- Signalized Intersection
- Traffic Count: 24,500 VPD

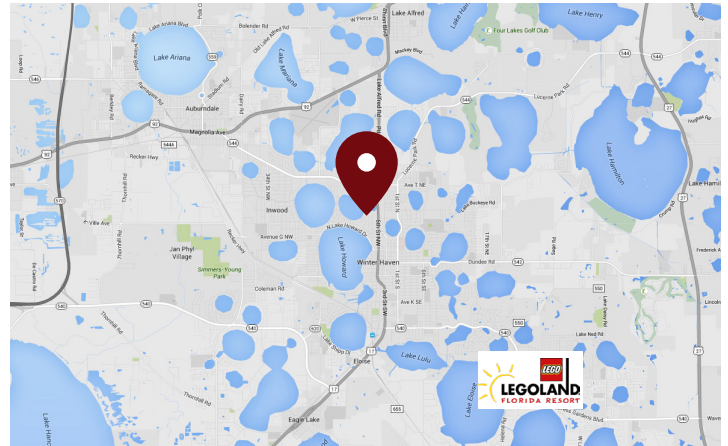

DEMOGRAPHICS	1 Mile	3 Miles	5 Miles
Total Population	6,251	53,242	113,594
Daytime Population	42,261	90,529	147,303
Total Households	2,942	21,069	43,589
Avg. HH Income	\$66,067	\$70,972	\$80,034

Data provided by Placer Labs Inc. (www.placer.ai) & Esri

Sandra Woodworth

813.210.7509 | swoodworth@crossmanco.com
9950 Princess Palm Avenue, Suite 340, Tampa, FL

Licensed Real Estate Broker. No warranty expressed or implied has been made to the accuracy of the information provided herein, no liability assumed for error or omission.



www.crossmanco.com

Publix #0836 - Publix at Northgate

1395 6th Street NW
 Winter Haven, FL 33881
 Lat 28.034, Long -81.734

SITE PLAN

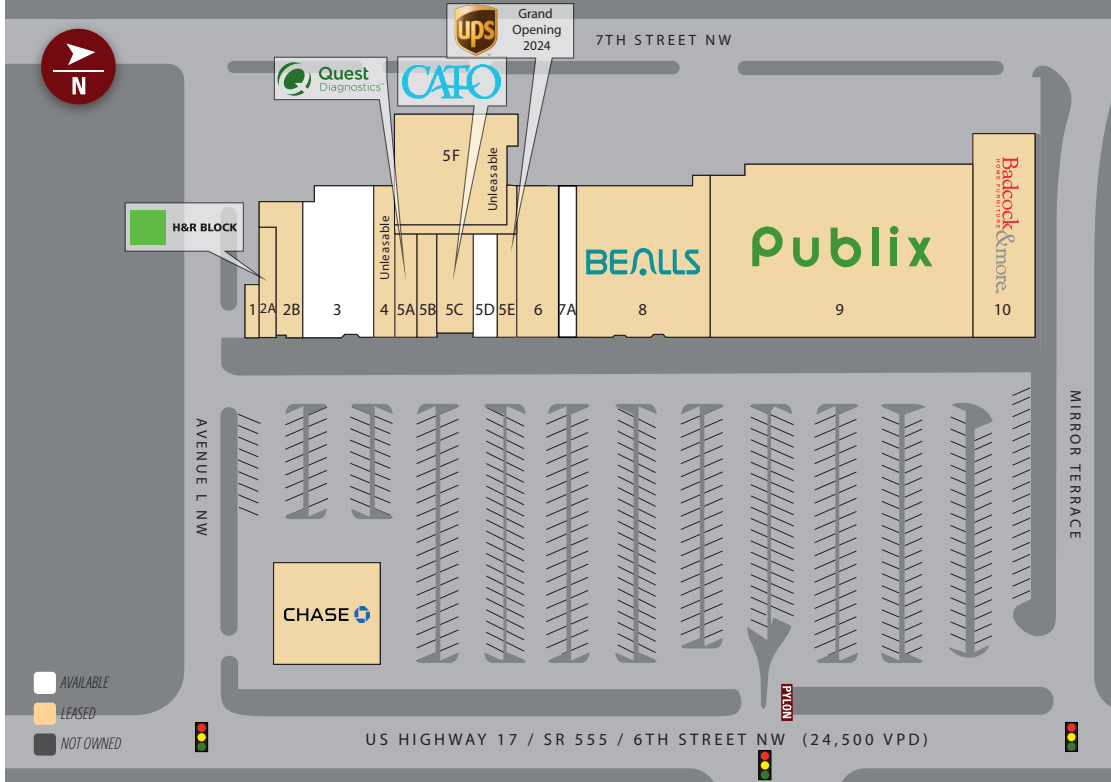

Suite	Tenant	Size
9	Publix	44,270
1	Crown Dry Cleaners and Alterations	956
2A	Golden Wok Chinese Restaurant	1,800
2B	H&R Block Tax Services	3,886
3 #1382	AVAILABLE	10,443
5A	Quest Diagnostics	1,980
5B	Pinky Nails & Spa	1,992
5C	Cato Fashions Clothing	4,000
5D	AVAILABLE (20X100)	1,997
5E	UPS (Grand Opening 2024)	2,009
6	Florida Blue	6,000
7A	AVAILABLE (20X90)	1,815
8	Bealls	19,500
10	Badcock Furniture & more	12,102
OP	JP Morgan Chase Bank	1 AC

TOTAL 113,159



Sandra Woodworth

813.210.7509 | swoodworth@crossmanco.com
 9950 Princess Palm Avenue, Suite 340, Tampa, FL

Licensed Real Estate Broker. No warranty expressed or implied has been made to the accuracy of the information provided herein, no liability assumed for error or omission.



Crossman & Company

www.crossmanco.com

Publix #0836 - Publix at Northgate

1395 6th Street NW
Winter Haven, FL 33881
Lat 28.034, Long -81.734

FOOT TRAFFIC OVERVIEW

EST. # OF CUSTOMERS ANNUALLY

 **202,300**

EST. # OF VISITS ANNUALLY

 **1.2 Million**

AVG. VISITS / CUSTOMER

 **5.81**

AVG. LENGTH-OF-STAY / VISIT

 **28 MIN**

TOP 3 DAYS



Friday	179,242
Thursday	172,868
Wednesday	169,545

OF VISITS

TOP 3 HOURS



5-6 PM	164,331
12-1 PM	163,259
4-5 PM	158,318

OF VISITS

Data provided by Placer Labs Inc. (www.placer.ai) June 1, 2023 - May 31, 2024

SITE VISIT DENSITY

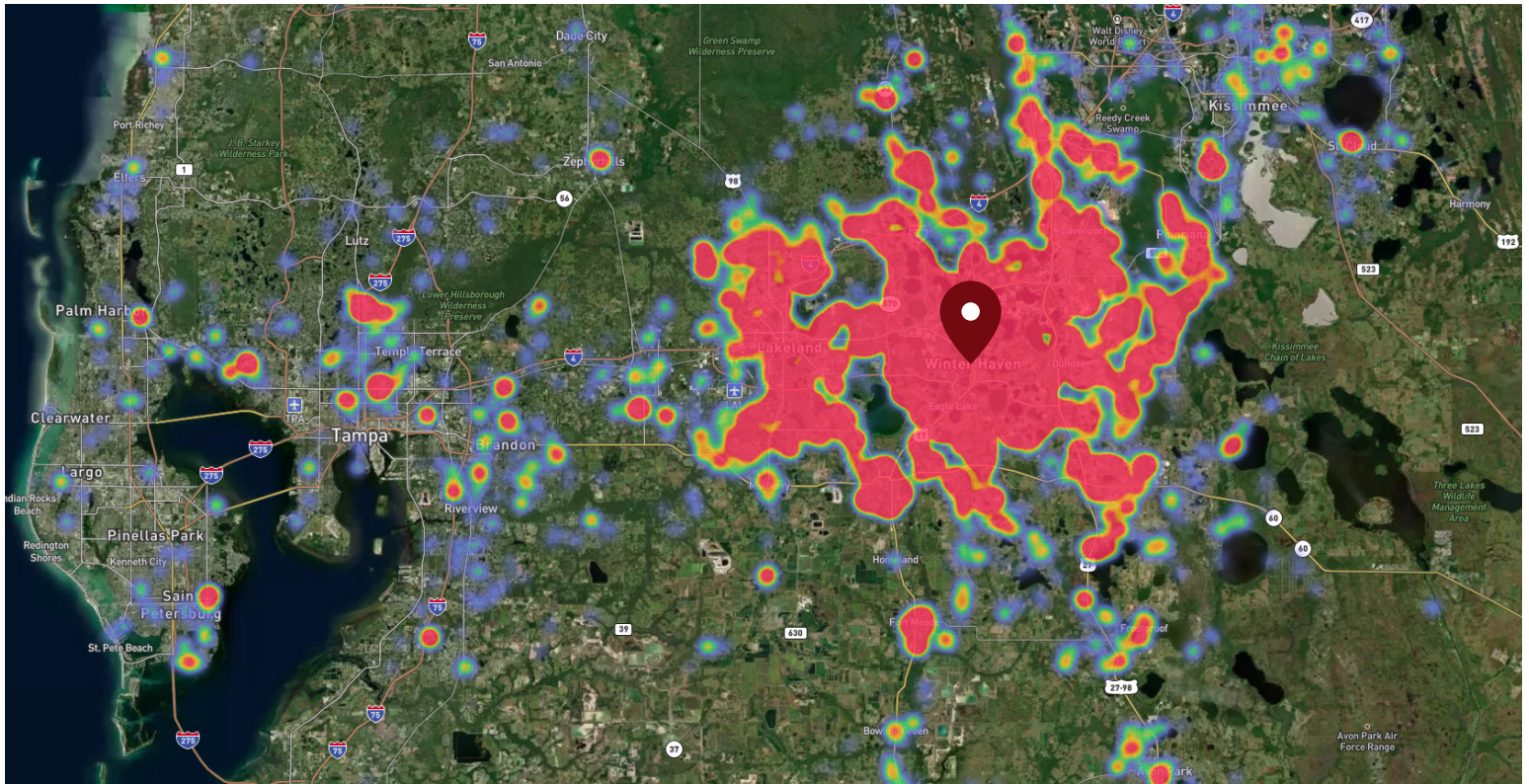

Red, orange, and yellow colors represent the location of 60% of site visitors

Data provided by Placer Labs Inc. (www.placer.ai)

Sandra Woodworth

813.210.7509 | swoodworth@crossmanco.com
9950 Princess Palm Avenue, Suite 340, Tampa, FL

Licensed Real Estate Broker. No warranty expressed or implied has been made to the accuracy of the information provided herein, no liability assumed for error or omission.



Crossman & Company

www.crossmanco.com