

Industrial | For Lease

# 5333 S Laramie Ave

Chicago, Illinois

CBRE

## Property Specs

Total Building Size (includes industrial & office space)	192,515 SF
Office Portion Size	77,299 SF
Available SF	1st Floor - 7,449 SF • 2,343 SF & 5,106 SF Units 2nd Floor - 15,540 SF (divisible)
Parking	Heavy
Ward/Alderman	23rd Ward/Alderman Silvana Tabares
Lease Rate	\$16.00/USF

## Property Highlights

- Hard to find office space for this submarket
- Can deliver space to tenant's specific requirements
- Next door to Midway International Airport, just minutes to I-55 & 10 miles to the Loop
- Bus stop in front of building & within walking distance to CTA Orange Line
- Multiple retail amenities in the immediate area
- Professionally managed building

## OFFICE SPACE AVAILABLE FOR LEASE



## Contact Us

**Matt Cowie**

First Vice President  
+1 312 334 7203  
Matt.Cowie@cbre.com

**Larry Goldwasser, SIOR**

Executive Vice President  
+1 312 334 7201  
Larry.Goldwasser@cbre.com

**CBRE Inc.**

321 N. Clark St.  
Suite 3400  
Chicago, IL 60654

# 1st Floor - 7,449 SF Available

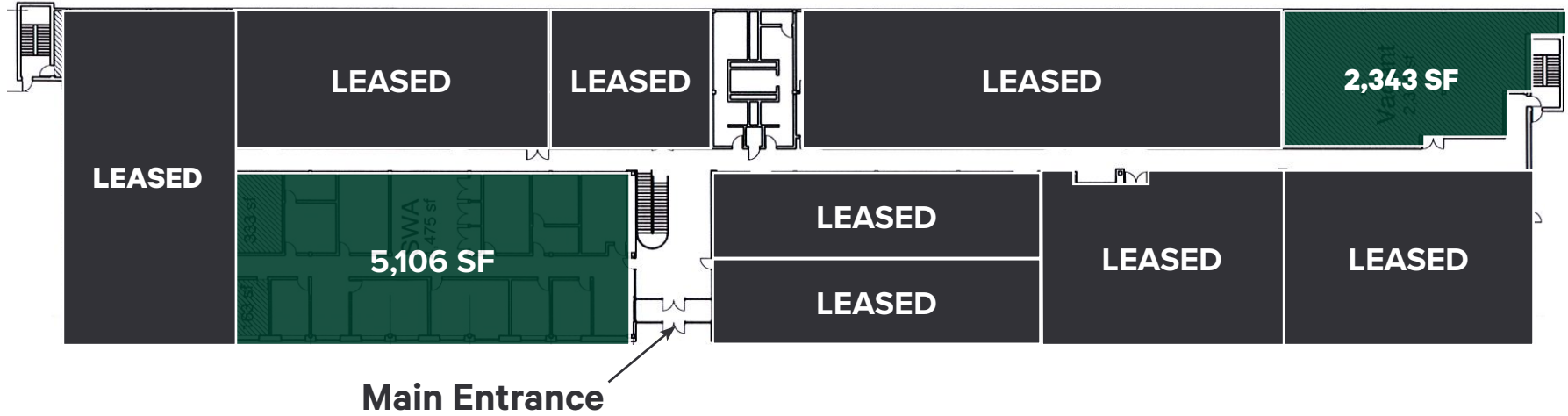

## 2nd Floor - 15,540 SF Available (Units Ranging from 650 - 1,770 SF)

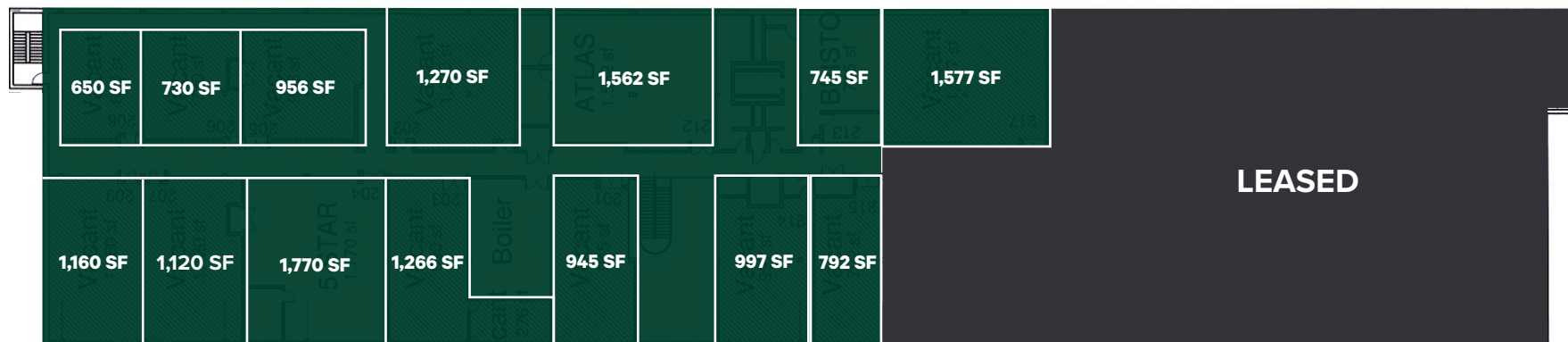

Midway Business Center  
5333 S Laramie Avenue | Chicago, Illinois

## Aerial Overview



## Contact Us

**Matt Cowie**  
First Vice President  
+1 312 334 7203  
Matt.Cowie@cbre.com

**Larry Goldwasser, SIOR**  
Executive Vice President  
+1 312 334 7201  
Larry.Goldwasser@cbre.com

**CBRE Inc.**  
321 N. Clark St.  
Suite 3400  
Chicago, IL 60654

© 2022 CBRE, Inc. All rights reserved. This information has been obtained from sources believed reliable, but has not been verified for accuracy or completeness. You should conduct a careful, independent investigation of the property and verify all information. Any reliance on this information is solely at your own risk. CBRE and the CBRE logo are service marks of CBRE, Inc. All other marks displayed on this document are the property of their respective owners, and the use of such logos does not imply any affiliation with or endorsement of CBRE. Photos herein are the property of their respective owners. Use of these images without the express written consent of the owner is prohibited.

**CBRE**