

287 Lorton Avenue

Downtown Burlington

FOR SUBLEASE
±5,850 SF



Hilary Barte
+1 650 480 2132
Hilary.Barte@jll.com
RE License # 01995196

Derek Johnson
+1 415 533 3049
Derek.Johnson@jll.com
RE License #01512762

Hugh Scott
+1 650 468 8688
Hugh.Scott@jll.com
RE License #01414759



Space highlights

287 Lorton Avenue
Downtown Burlingame



Modern tech space with exclusive ~5,000 SF roof deck



Flexible configuration to accommodate meeting/event space and private conference rooms



±5,850 SF available



2 large conference rooms, 2 medium conference rooms, 5 phone rooms



Open break area, access to roof deck



Plug & Play



LED 7/27/2027

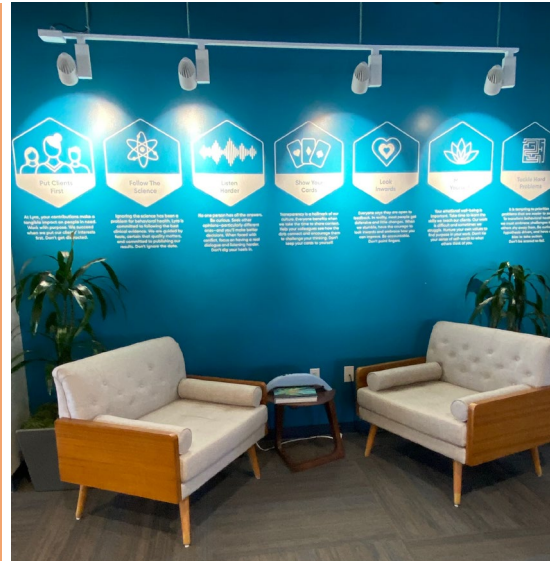

Floor plan

±5,850 RSF | 2nd floor

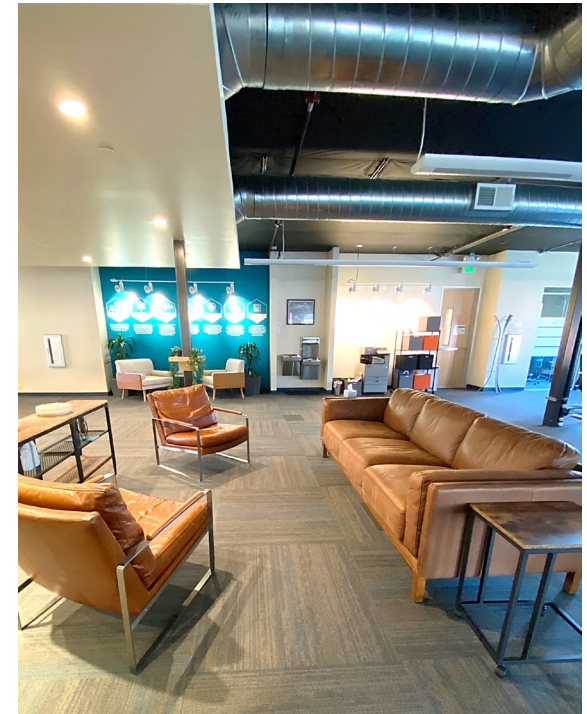
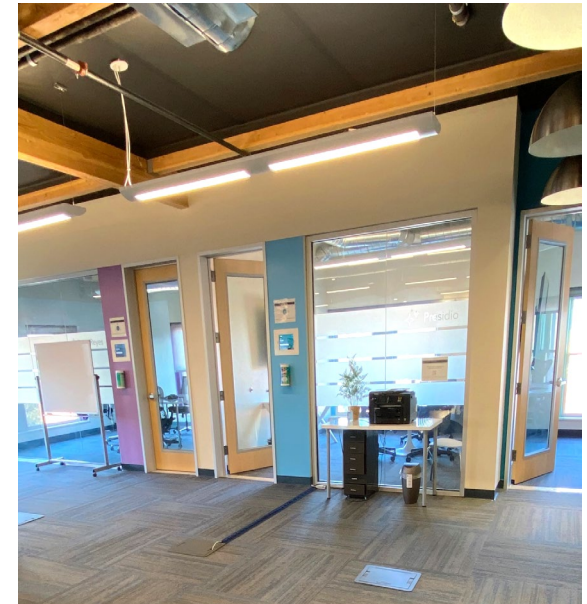
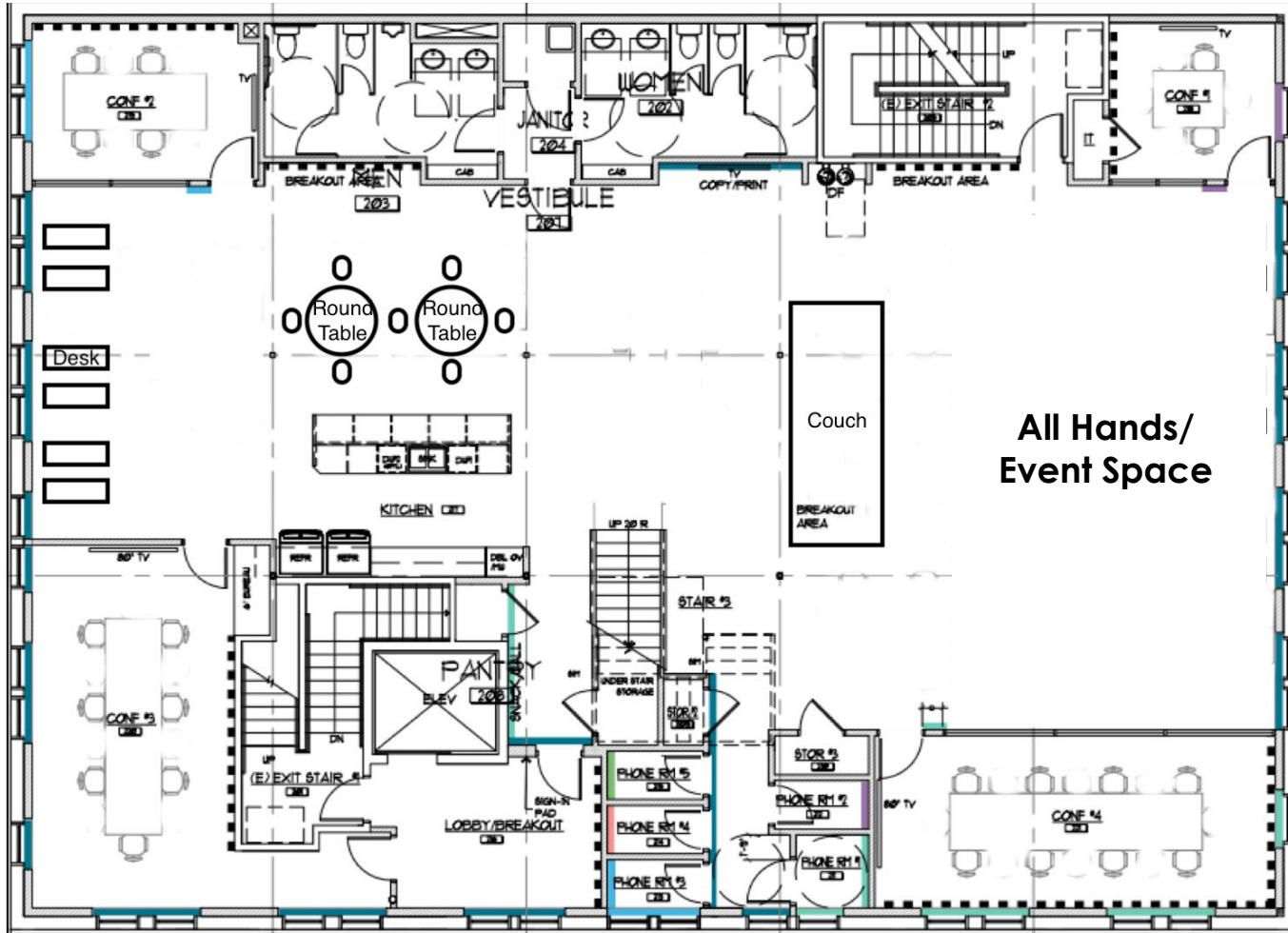

287 Lorton Avenue
Downtown Burlingame

Location highlights

- Downtown Burlingame
Walkable to over 20 coffee shops and restaurants
- 7 min. drive to SFO airport
- 1 block to Burlingame Caltrain Station
- Convenient Mid-Peninsula location
Similar employee commute times from San Francisco and the South Bay

287 Lorton Ave.

