

AVAILABLE

**Insite**  
COMMERCIAL  
REAL ESTATE

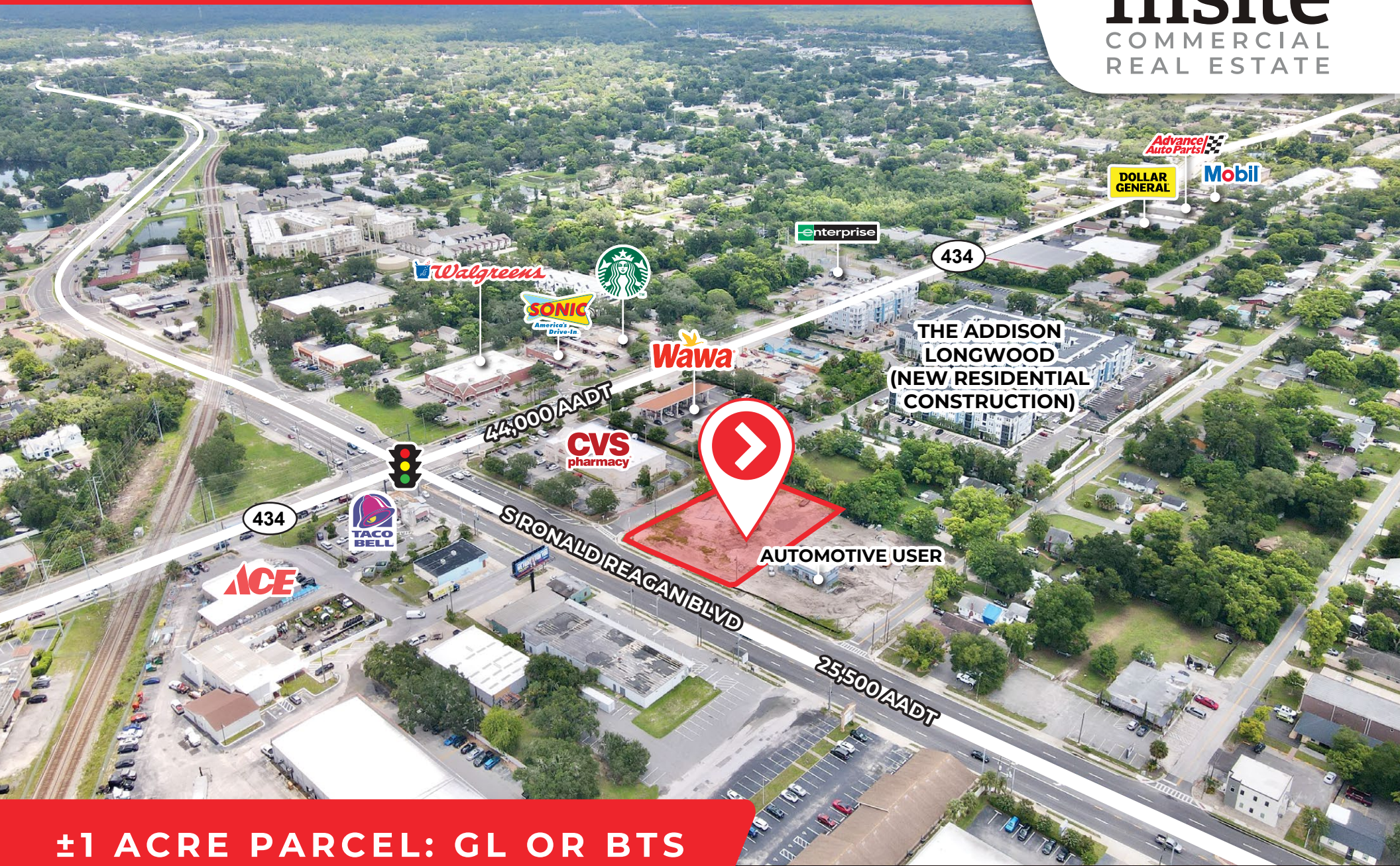

±1 ACRE PARCEL: GL OR BTS

185 S. RONALD REAGAN BLVD, LONGWOOD, FL 32750

**ALEX BISBEE**  
407-864-6444

**PAYTON FOSTER**  
407-461-8080





## PROPERTY HIGHLIGHTS

- ± 1 Acre parcel available for Gound Lease or Build-To-Suit.
- Ideal uses include coffee, QSR, retail, oil, medical.
- Located less than 1 mile from Orlando Health South Seminole Hospital and Lyman High School.
- Multiple site plan options available including a multi-tenant retail building
- Multiple points of ingress and egress.

## 2024 DEMOGRAPHICS



Population	1 Mile	9,390
	3 Mile	76,310
	5 Mile	207,929



Employees	1 Mile	16,273
	3 Mile	52,470
	5 Mile	124,955



Average Household Income	1 Mile	\$98,867
	3 Mile	\$102,935
	5 Mile	\$114,154



Households	1 Mile	3,777
	3 Mile	32,004
	5 Mile	87,931



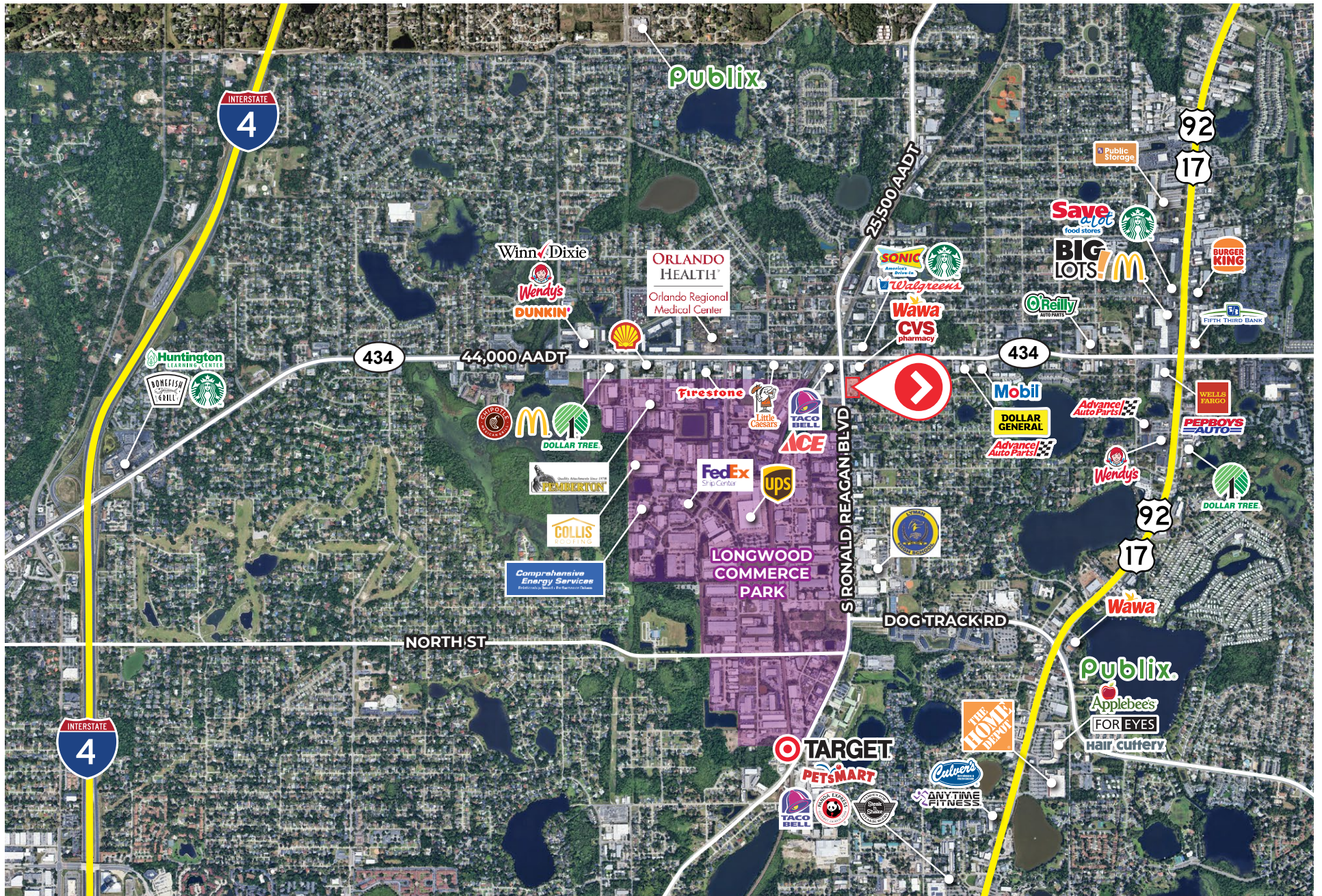



## QSR LAYOUT

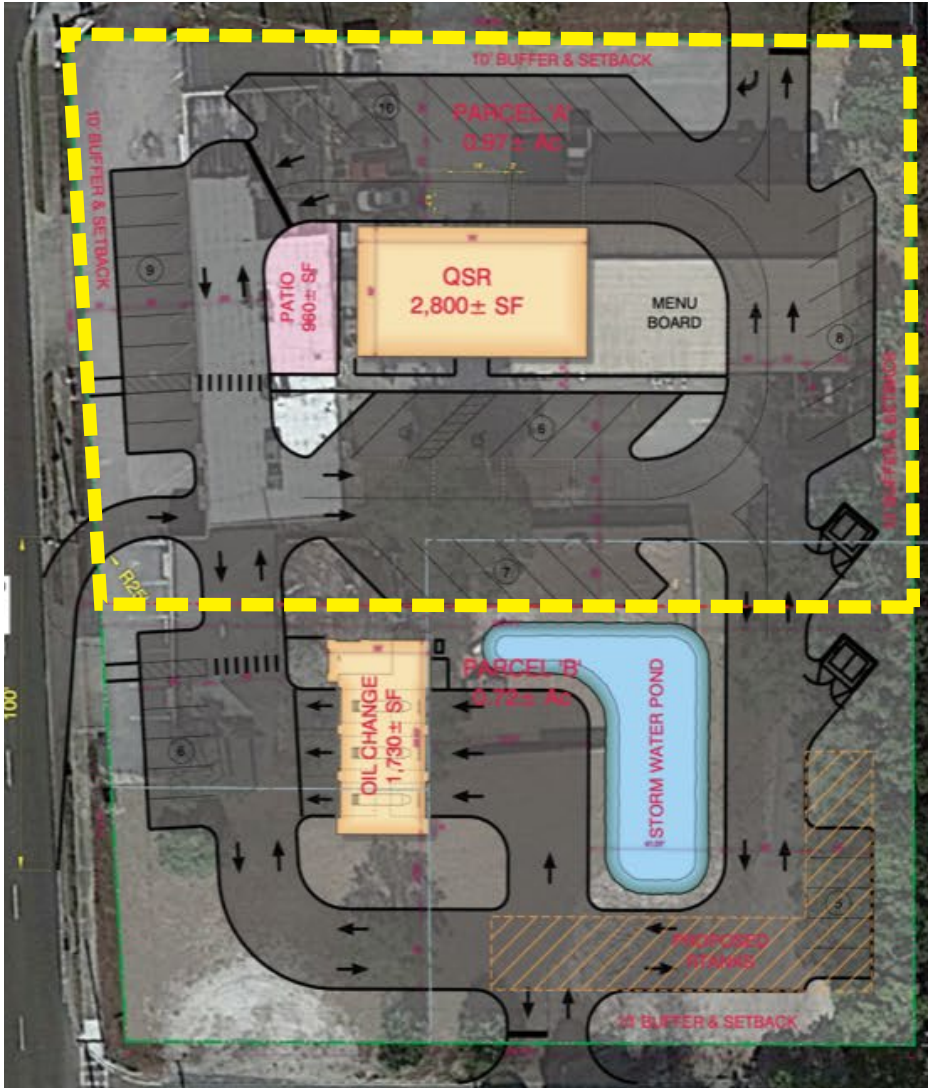

## COFFEE LAYOUT

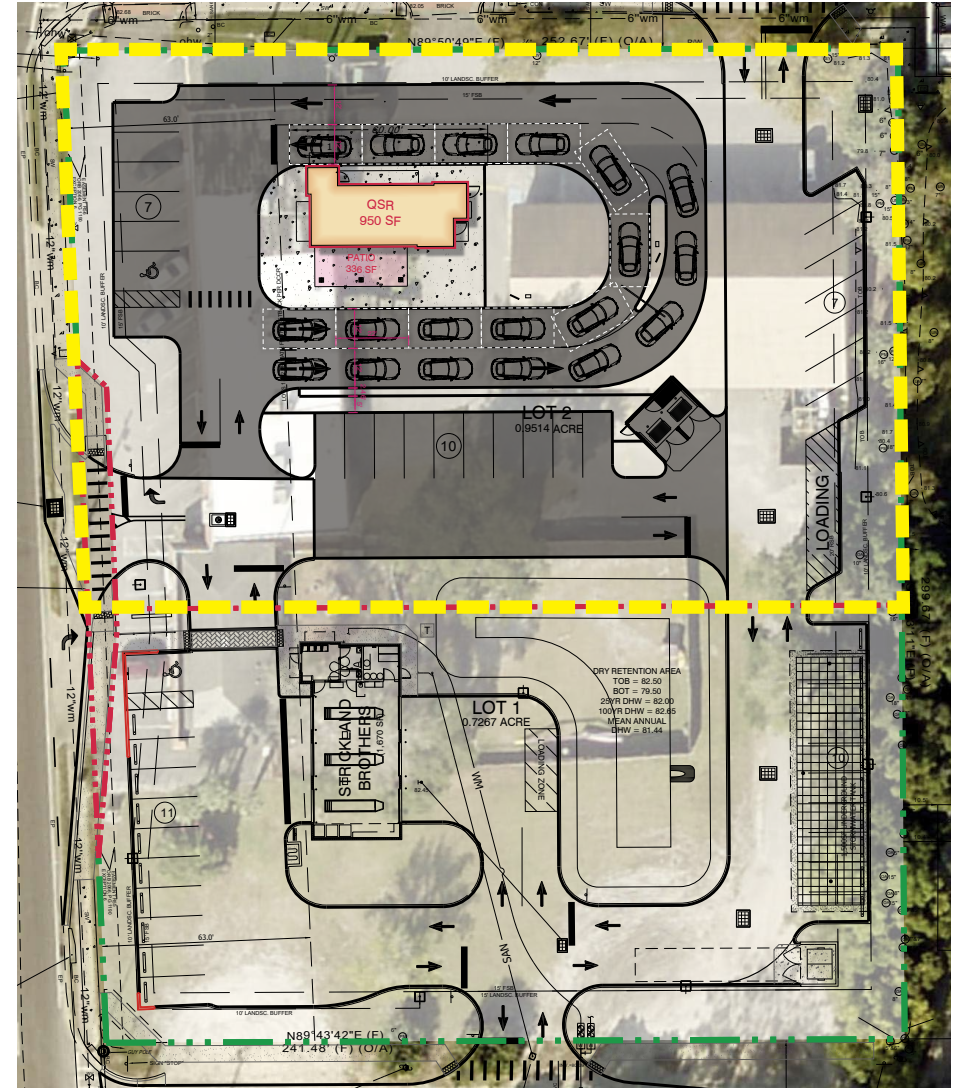

## RETAIL BUILDING

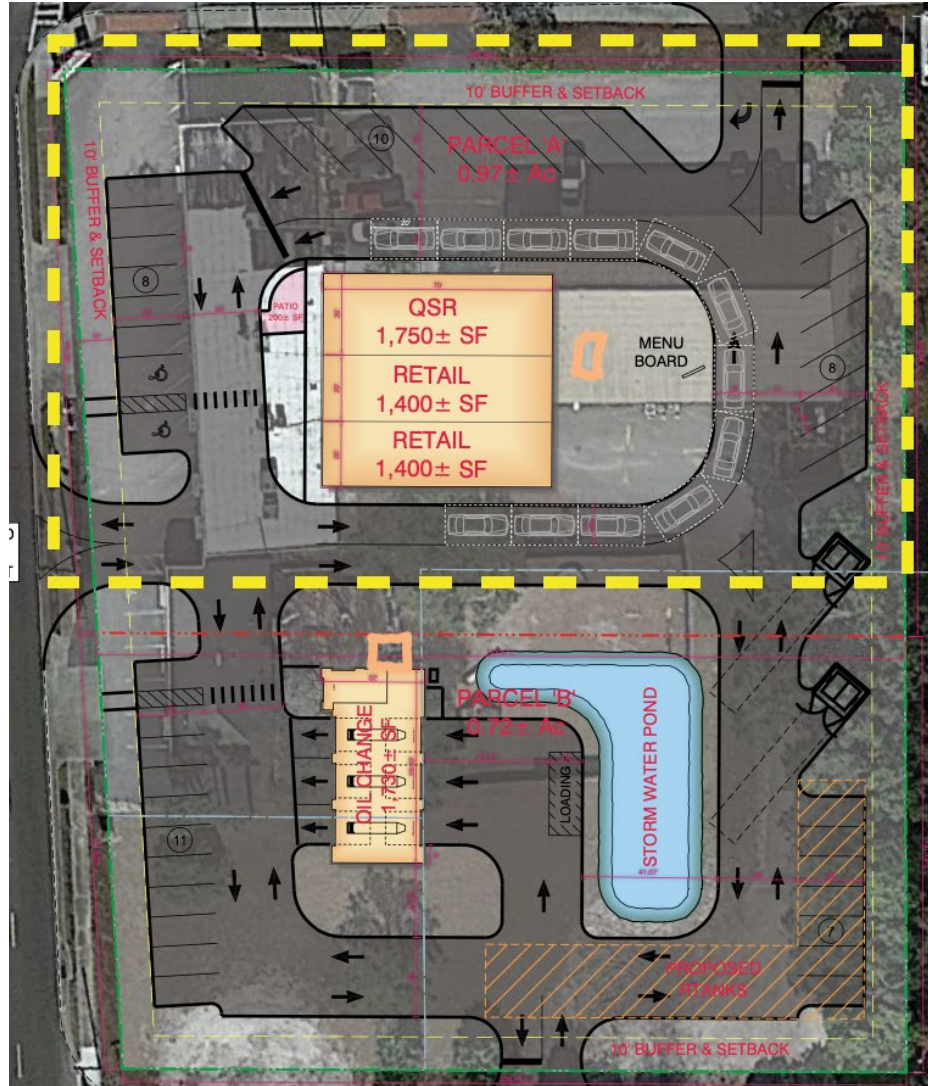

FOR MORE  
INFORMATION  
PLEASE CONTACT

**ALEX BISBEE**

407-864-6444

ABISBEE@INSITEREI.COM

**PAYTON FOSTER**

407-461-8080

PFOSTER@INSITEREI.COM

