

# Build-to-Suit or Sale

## Maple Grove & Ustick Pad

3212 N. Maple Grove Road | Boise, ID

### Highlights

- Pad available for development on heavily traveled Ustick Road & Maple Grove Road - 21,000 VPD (Ustick Rd), 16,000 VPD (Maple Grove)
- On-site parking
- Great visibility
- Signage available
- Pad can accommodate a +/- 5,000 SF building



**SITE**

**Lew Manglos, CCIM, SIOR**  
+1 208 472 2841  
[lew.manglos@colliers.com](mailto:lew.manglos@colliers.com)



755 West Front Street, Suite 300  
Boise, Idaho 83702  
+1 208 345 9000  
[colliers.com/idaho](http://colliers.com/idaho)



# Property Overview

Property Type	Land — Office/Retail
Building Size	Can accommodate up to a 5,000 <sup>SF</sup> building
Lease Rate/Sale Price	Contact Agent
Zoning	MX-1 <a href="#">See allowed uses here</a>



# Site Plan

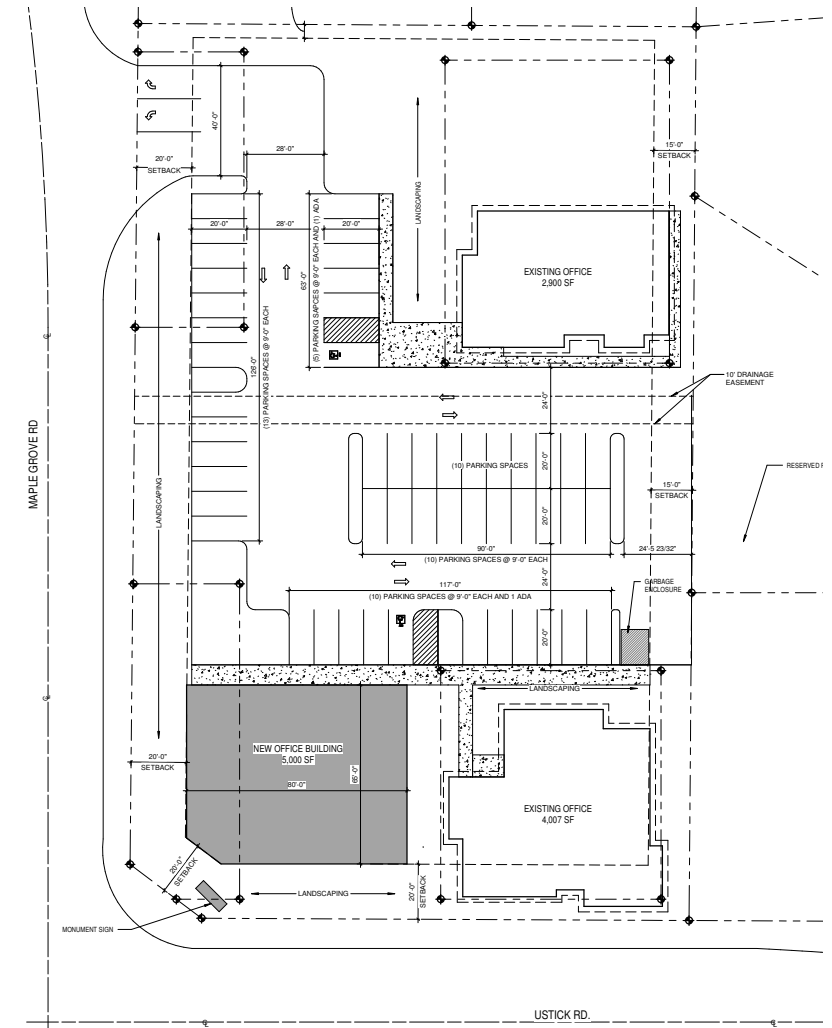

Demos 2025	1 Miles	3 Miles	5 Miles
Population	17,044	107,242	239,784
Households	6,943	44,592	100,236
Avg. Income	\$78,119	\$78,695	\$84,502



## Area Overview

