

DETAIL
SCALE 1" = 20'

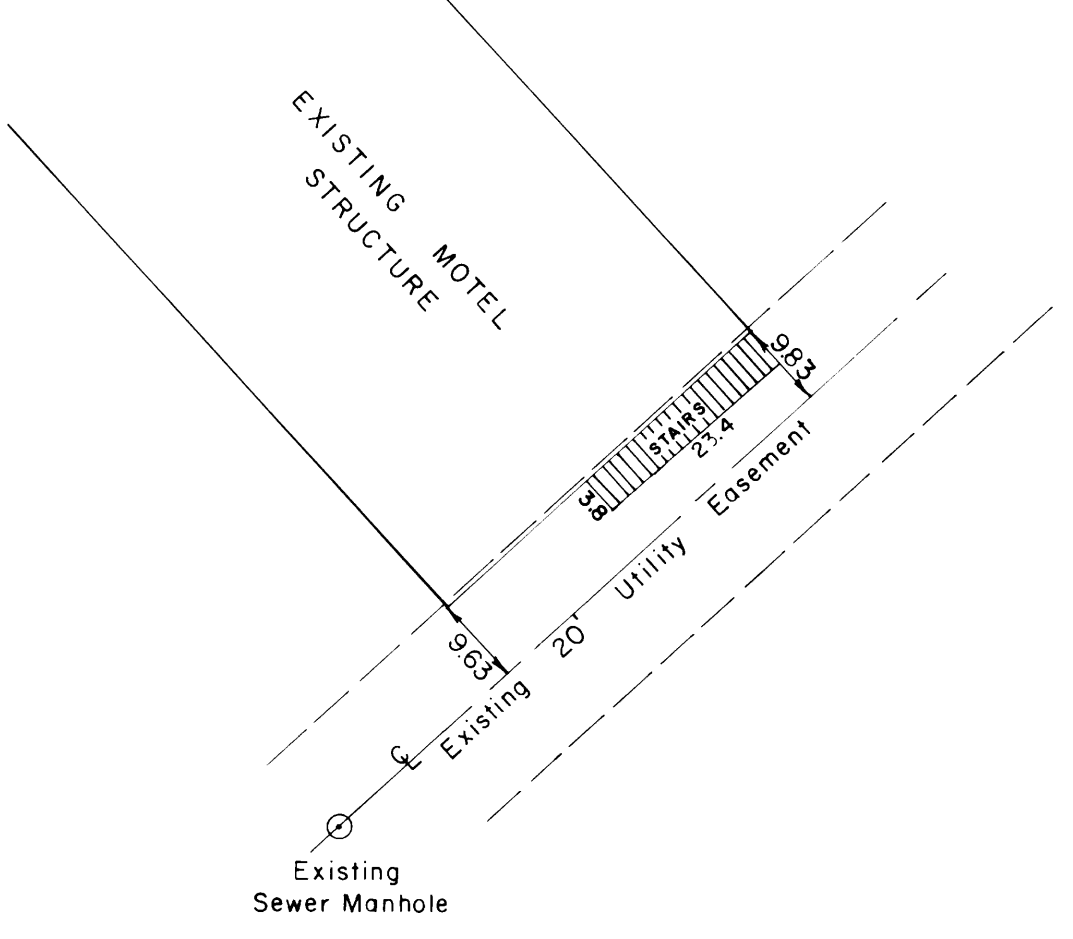

LINE TABLE

LINE	BEARING	DISTANCE
1	S 47°19'37"W	60.00

CURVE TABLE

CURVE	DELTA	RADIUS	ARC	TANGENT	CHORD
1	90°01'55"	20.00	31.43	20.01	28.29

- LEGEND**
- ⊕ BLM or GLO monument recovered
 - ⊖ BLM or GLO monument not recovered
 - ⊗ Found official survey monument
 - ⊙ Set Bernsten 3 1/4" x 30" aluminum survey monument
 - Monument of record not recovered
 - ⊙ Found 5/8" rebar
 - ⊙ Set 5/8" x 30" rebar with 2" aluminum cap
 - Found 1/2" rebar
 - ⊕ Set 1/2" x 24" rebar
 - () Date of Record
 - Typical street address

NOTES

1) All wastewater treatment and disposal systems shall comply with existing law at the time of construction.

NOTARY'S ACKNOWLEDGEMENT

FOR: City of Kenai by William J. Brighton, City Manager
Subscribed and sworn before me this
9th day of June, 1983.
My commission expires 6-24-85.
Sara M. Gerstlauer
Notary Public for the State of Alaska

CERTIFICATE OF OWNERSHIP AND DEDICATION

We hereby certify that we are the owners of the property shown and described hereon and that we hereby adopt this plan of subdivision and dedicate all right-of-ways to public use and grant all easements to the use shown.

City of Kenai by William J. Brighton, City Manager

CERTIFICATE OF APPROVAL BY THE ALASKA DEPARTMENT OF ENVIRONMENTAL CONSERVATION

This subdivision has been reviewed in accordance with 18AAC72.003 and is approved, subject to any noted restrictions.

Robert J. Conner P.E. 6-13-83
SIGNATURE TITLE DATE

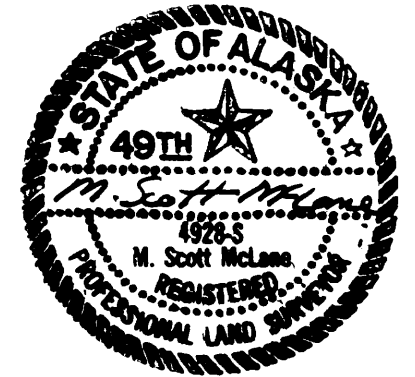

PLAT APPROVAL

This plat was approved by the KENAI PENINSULA BOROUGH PLANNING COMMISSION at the meeting of

February 28, 1983
KENAI PENINSULA BOROUGH

By: [Signature] Authorized Official

SPUR SUBDIVISION No. 7
(A RESUBDIVISION OF LOT 3A, SPUR No. 4)

City of Kenai
Box 580
Kenai, AK 99611

LOCATION

1.220 ACRES M/L LOCATED IN THE SW 1/4 NE 1/4 SEC 5, T5N, R11W, S.M., AK, THE CITY OF KENAI, AND THE KENAI PENINSULA BOROUGH.

Prepared by: **McLane & Associates, Inc.**
Soldotna, AK 99669

DATE 5/12/83	SCALE 1" = 50'	BOOK NO. 83-20
-----------------	-------------------	-------------------

83-114
RECORDED - FILED 10 00
6-16 83
10-43
McLane & Associates
Soldotna