

# PLAZA 38

AT LOWELL

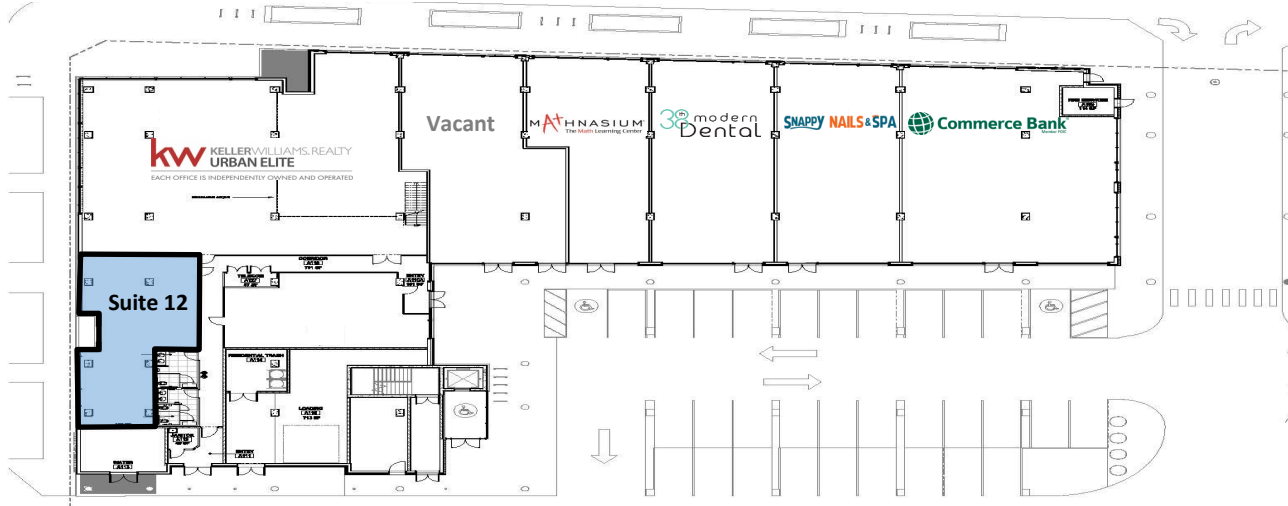

3550 W. 38th Ave. Denver, CO 80211

Suite 12—1,507 SF

Great office space with lots of natural light. Partitioned workstations. Breakroom with refrigerator and dishwasher. Can be leased furnished. Individual workstations available at \$600/month. Conference room also available. Free covered parking - 173 spaces available.

Outstanding Highlands location.

**\$31.50/sf NNN**

**Gene Lucero**

Lucero Financial Group

Keller Williams Realty Urban Elite

3550 W. 38th Ave., Suite 20 Denver, CO 80211

303-888-9198 303-458-3800 glucero@lucerofinancial.com

**LUCERO**

FINANCIAL GROUP



Real Estate \* Mortgage \* Development