



PARK PLACE

M E D I C A L C E N T E R

SE CORNER LOOP 101 & LOOP 202 | CHANDLER, AZ
WWW.ALLREDPARKPLACE.COM

BLDG

4

**1450 S SPECTRUM BLVD
CHANDLER, AZ**

**±100,622 SF TWO STORY BUILDING
OFF CAMPUS MEDICAL SPACE FOR LEASE**

- ▶ Exterior loaded tenant entrances
- ▶ 5:1000 parking with future ability of 1:1000 covered physician parking
- ▶ Common area with covered patio and coffee shop adjacent to building
- ▶ Building & monument signage availability
- ▶ 2 miles from Chandler Regional Medical Center
- ▶ ±30,000 - ±100,000 SF Available



**CUSHMAN &
WAKEFIELD**

ACCESSIBLE CAMPUS



MESA

Bldg 4: ±100,622 SF Medical Office
- First Floor: ±50,311 SF
- Second Floor: ±50,311 SF

GILBERT

← **CHANDLER
INTEL CAMPUS**
±3.8 MILES | ±9 MINUTES

← **CHANDLER
FASHION CENTER**
±1.7 MILES | ±6 MINUTES

**CHANDLER
REGIONAL HOSPITAL**
±2.1 MILES | ±6 MINUTES

202

PROPOSED BUILDINGS

SPECTRUM BLVD

4

WILLIS RD

PRICE RD

ARMSTRONG PL

PROPOSED BUILDINGS



NOT TO SCALE

SERVICE LINE GROWTH

SERVICE LINE	2023 VOLUME	2028 VOLUME	2023 VOLUME	5 YR GROWTH	10 YR GROWTH
Endocrinology	4,625	6,093	7,421	31.7%	60.5%
Psychiatry	313,080	387,758	431,525	23.9%	37.8%
Podiatry	4,132	5,067	5,847	22.6%	41.5%
Spine	32,785	40,135	48,352	22.4%	47.5%
Vascular	193,868	235,317	277,121	21.4%	42.9%
Physical Therapy/Rehabilitation	30,086	36,505	44,590	21.3%	48.2%
Ophthalmology	175,789	213,053	258,232	21.2%	46.9%
Cardiology	567,594	682,934	857,007	20.3%	51.0%
Orthopedics	73,146	86,684	101,624	18.5%	38.9%
Pain Management	23,265	27,565	32,134	18.5%	38.1%
Lab	927,944	1,098,856	1,272,439	18.4%	37.1%
Miscellaneous Services	62,986	74,498	89,442	18.3%	42.0%
ENT	453,544	532,128	630,318	17.3%	39.0%
Nephrology	10,766	12,571	14,448	16.8%	34.2%
Evaluation and Management	15,599	17,856	20,463	14.5%	31.2%
Trauma	2,205,616	2,515,816	2,837,764	14.1%	28.7%
Neurology	37,967	43,011	48,800	13.3%	28.5%
Thoracic Surgery	626,699	708,948	800,472	13.1%	27.7%
Radiology	1,117	1,260	1,379	12.9%	23.5%
Oncology	30,619	34,539	39,314	12.8%	28.4%
Gastroenterology	93,699	104,748	116,979	11.8%	24.8%
Dermatology	2,002	2,233	2,589	11.6%	29.3%
Neurosurgery	49,368	54,894	60,737	11.2%	23.0%
General Surgery	12,717	14,075	15,722	10.7%	23.6%
Urology	19,851	21,969	24,938	10.7%	25.6%
Cosmetic Procedures	17,548	19,106	20,981	8.9%	19.6%
Gynecology	21,663	23,216	25,150	7.2%	16.1%
Pulmonology	30,387	31,678	32,228	4.2%	6.1%
Obstetrics	9,688	9,171	8,615	-5.3%	-11.1%

NEARBY MEDICAL

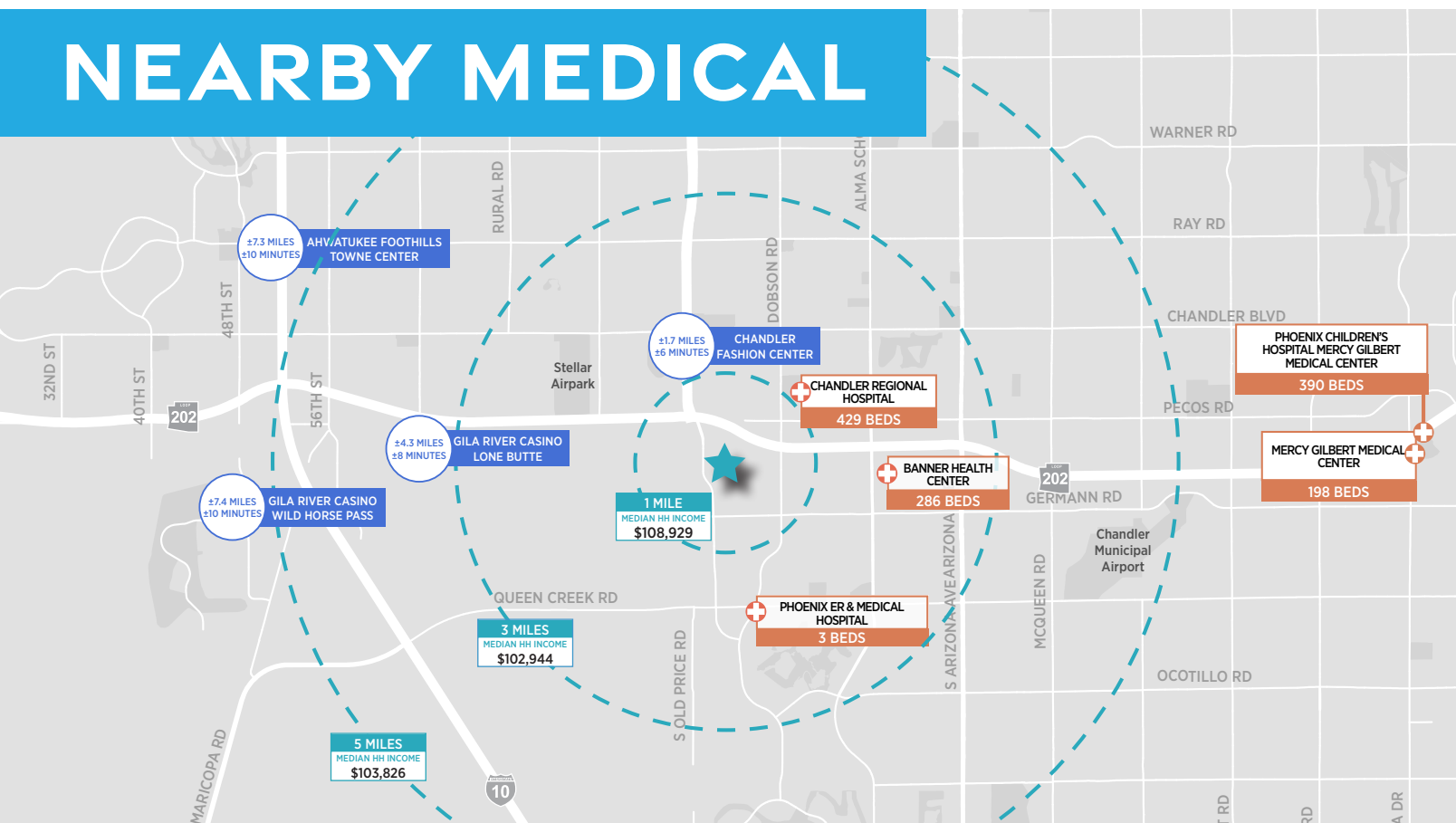

FLOOR PLAN

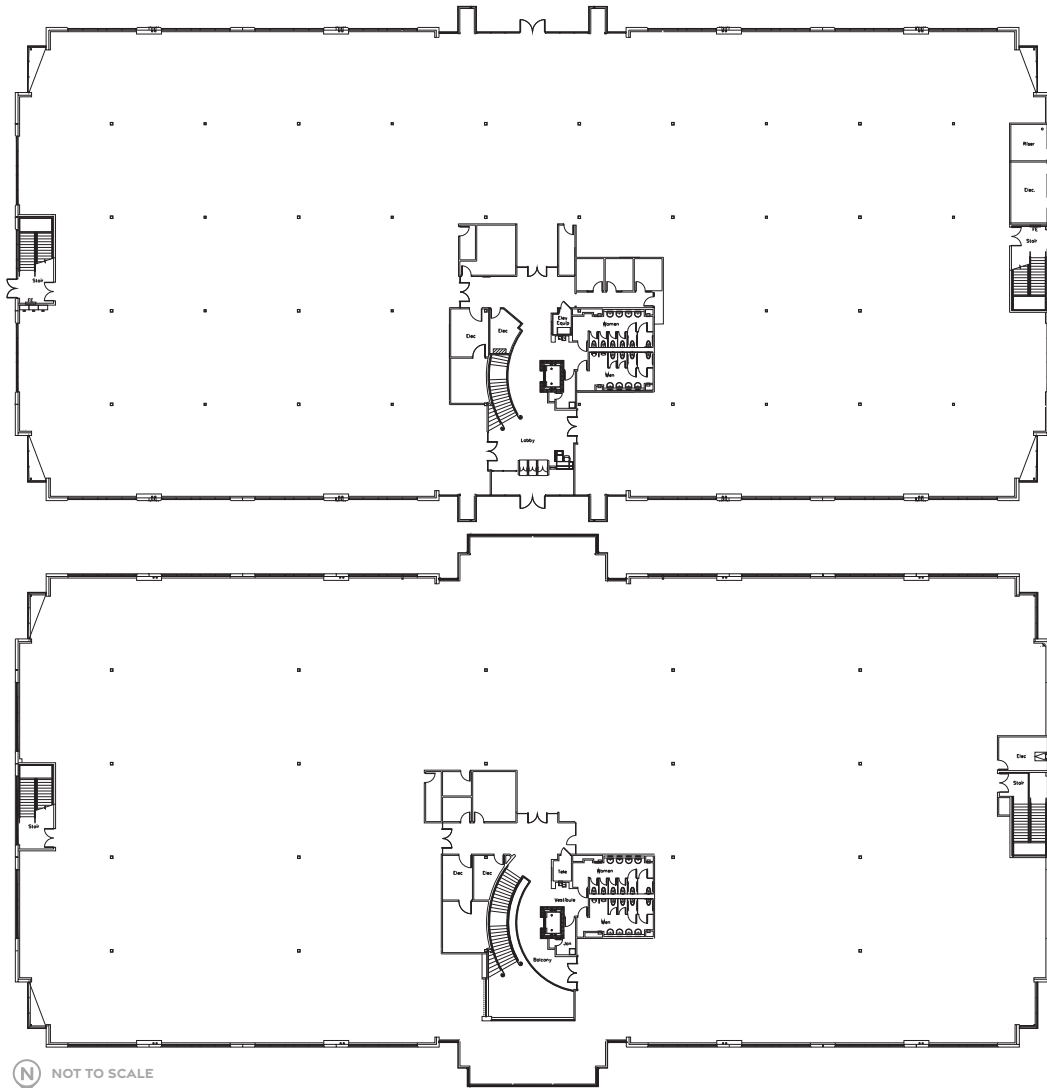

 **FIRST FLOOR**

 **SECOND FLOOR**

LEASING CONTACTS:

SHEILA BALE

+1 602 224 4454

sheila.bale@cushwake.com

BRAD ANDERSON

+1 602 224 4403

brad.anderson@cushwake.com

ERIKA ECKBLAD

+1 602 224 4451

erika.eckblad@cushwake.com

MIKE STRITTMATTER

+1 602 224 4457

mike.strittmatter@cushwake.com

2555 E Camelback Rd, Suite 400, Phoenix, AZ 85016

+1 602 954 9000 | cushmanwakefield.com



©2025. Cushman & Wakefield. All rights reserved. The information contained in this communication is strictly confidential. This information has been obtained from sources believed to be reliable but has not been verified. No warranty or representation, express or implied, is made as to the condition of the property (or properties) referenced herein or as to the accuracy or completeness of the information contained herein, and same is submitted subject to errors, omissions, change of price, rental or other conditions, withdrawal without notice, and to any special listing conditions imposed by the property owner(s). Any projections, opinions or estimates are subject to uncertainty and do not signify current or future property performance.