



FOR LEASE

1600 INDUSTRIAL ROAD

CAMBRIDGE, ONTARIO

INDUSTRIAL
UNITS AVAILABLE

FOR MORE INFORMATION, CONTACT:

JOSHUA BUFFINGA*

Associate

519-804-4386

Joshua.Buffinga@cushwakewr.com

SCOTT ANDERSON, SIOR**

Senior Vice President

519-804-4381

Scott.Anderson@cushwakewr.com

JORDAN PALMER, SIOR*

Senior Vice President

519-804-4384

Jordan.Palmer@cushwakewr.com

**Sales Representative | **Broker*

PROPERTY SPECIFICATIONS

Three industrial units available for lease in Cambridge, ranging in size from 2,425 to 2,579 SF. Units features 13' clear ceiling height, one (1) truck level door (Unit B7) and one (1) drive-in door (Unit A3 or B16), with 100amp/600 volt electrical service. Available for immediate occupancy. Minutes away from Highways 401 and 24. Many amenities nearby.



DETAILS

Total Area:	2,425 SF (Unit B7, B16) 2,579 SF (Unit A3)	Occupancy:	Immediate
Shipping:	1 - Dock Door (Unit B7) 1 - Drive-In Door (Unit A3, B16)	Net Lease Rate:	\$12.95 psf
Clear Height:	13'	Additional Rent:	\$4.50 psf (Estimated 2025)
Power:	100 Amps/600 Volts	Zoning:	M2 S.4.1.75.1 Click link for zoning by-law information

PHOTOGRAPHY - UNIT A3



PHOTOGRAPHY - UNIT B7



PHOTOGRAPHY - UNIT B16



SITE PLAN

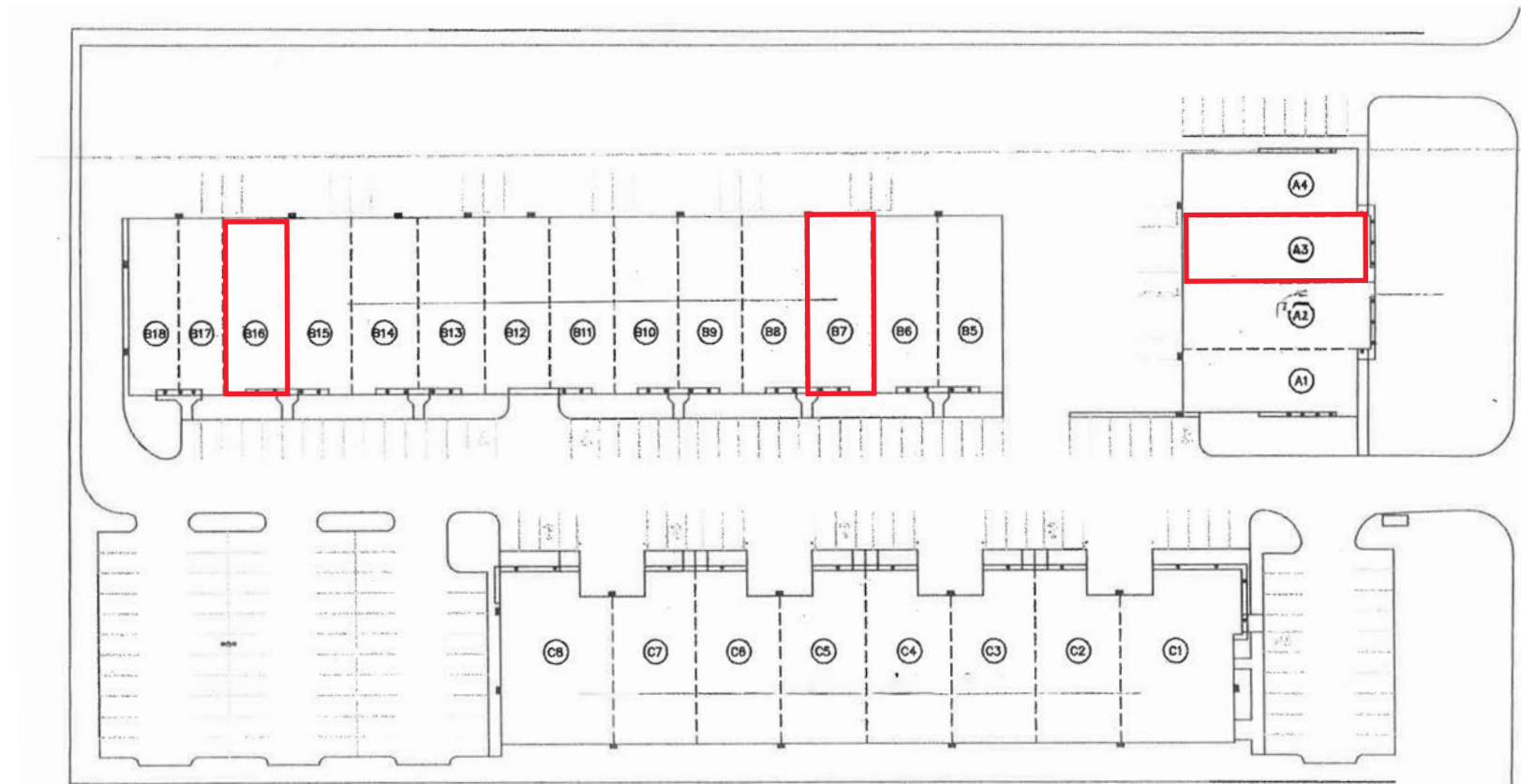

LOCATION MAP

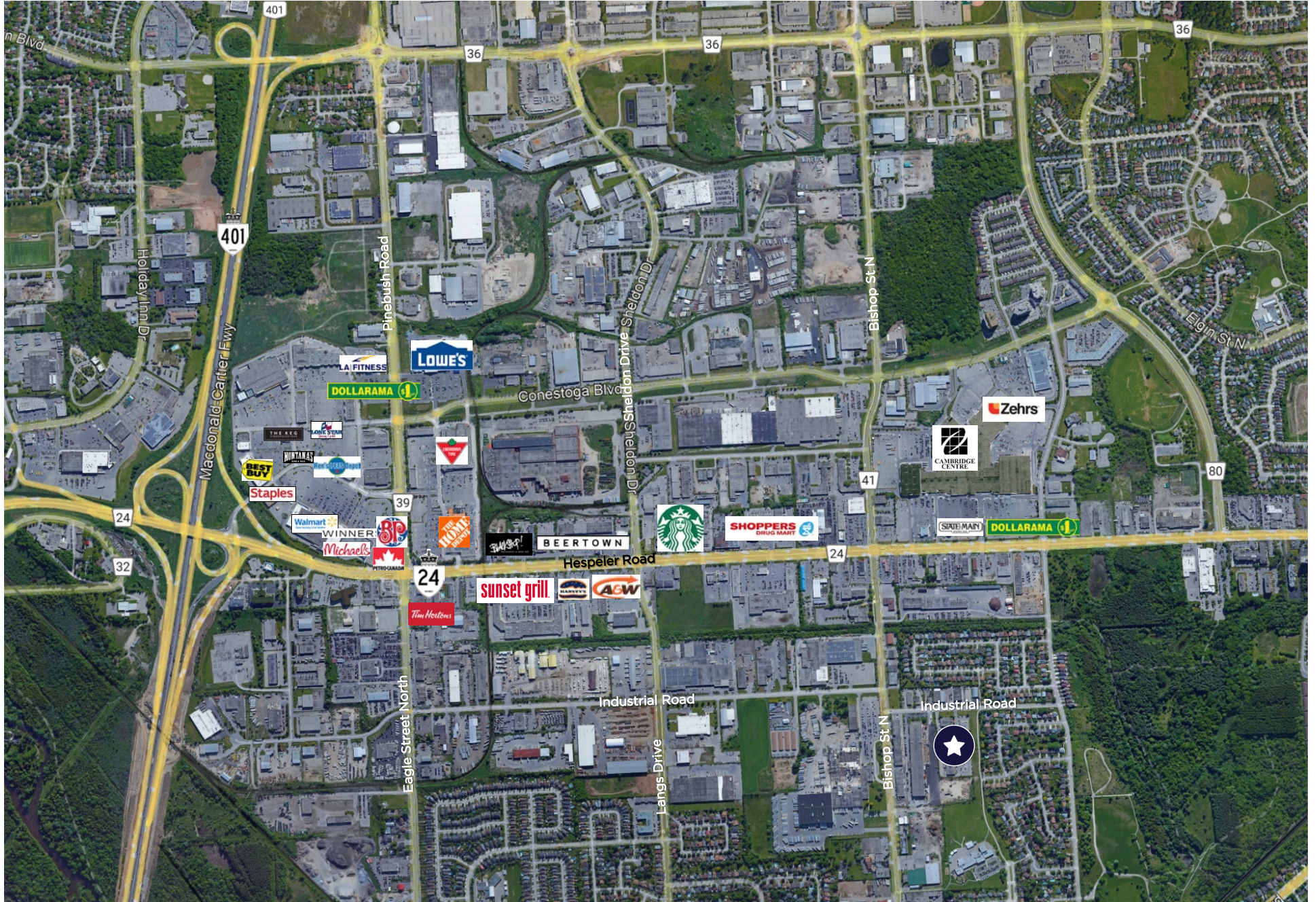



FOR MORE INFORMATION, CONTACT:

JOSHUA BUFFINGA*

Associate

519-804-4386

Joshua.Buffinga@cushwakewr.com

SCOTT ANDERSON, SIOR**

Senior Vice President

519-804-4381

Scott.Anderson@cushwakewr.com

JORDAN PALMER, SIOR*

Senior Vice President

519-804-4384

Jordan.Palmer@cushwakewr.com

**Sales Representative | **Broker*

**CUSHMAN & WAKEFIELD
WATERLOO REGION LTD.**

4295 King Street E, Suite 401
Kitchener, ON N2P 0C6

T: 519-585-2200

F: 519-650-5250

www.cushwakewr.com

©2025 Cushman & Wakefield Waterloo Region Ltd., Brokerage. All rights reserved. The information contained in this communication is strictly confidential. This information has been obtained from sources believed to be reliable but has not been verified. No warranty or representation, express or implied, is made as to the condition of the property (or properties) referenced herein or as to the accuracy or completeness of the information contained herein, and same is submitted subject to errors, omissions, change of price, rental or other conditions, withdrawal without notice, and to any special listing conditions imposed by the property owner(s). Any projections, opinions or estimates are subject to uncertainty and do not signify current or future property performance.