



Colliers



# For Sublease

## Industrial Space

1804 Deffenbaugh Ct  
Columbus, OH 43230

Brand new Class A space available for sublease. Approximately 84,060 square feet total with approximately 2,300 SF of brand new open spec office. The warehouse provides a minimum of 32' clear height and ten (10) fully equipped dock doors. Sublessor is open to a variety of lease term options and flexible size options for the right use. Space is immediately available for occupancy.

***Sublessor is offering an cooperating broker incentive of five (5%) percent commission for any sublease transaction executed on or before January 31, 2026.***

<b>Building SF:</b>	292,595 ± SF
<b>Available Space:</b>	84,060 ± SF
<b>Office Space:</b>	2,300 ± SF open spec office
<b>Sublease Rate:</b>	Negotiable based on terms
<b>Operating Expenses:</b>	\$1.19/SF (estimated 2026)



# Space Amenities

1804 Deffenbaugh Ct  
Columbus, OH 43230

- 32' minimum clear height
- 54' x 50' column spacing with 60' speed bay
- 310' deep
- 10 – 9' x 10' overhead dock doors with 40,000 lb mechanical pit leveler and seals
- LED lighting within the warehouse on motion sensors
- ESFR Sprinkler system with K-17 heads
- 1,000 AMP, 277/480 volt, 3 phase electric
- 7" Unreinforced slab on grade
- Up to 50 car parking spaces and 15 striped trailer space.



# Floor Plan

1804 Deffenbaugh Ct  
Columbus, OH 43230

## Property Floor Plan

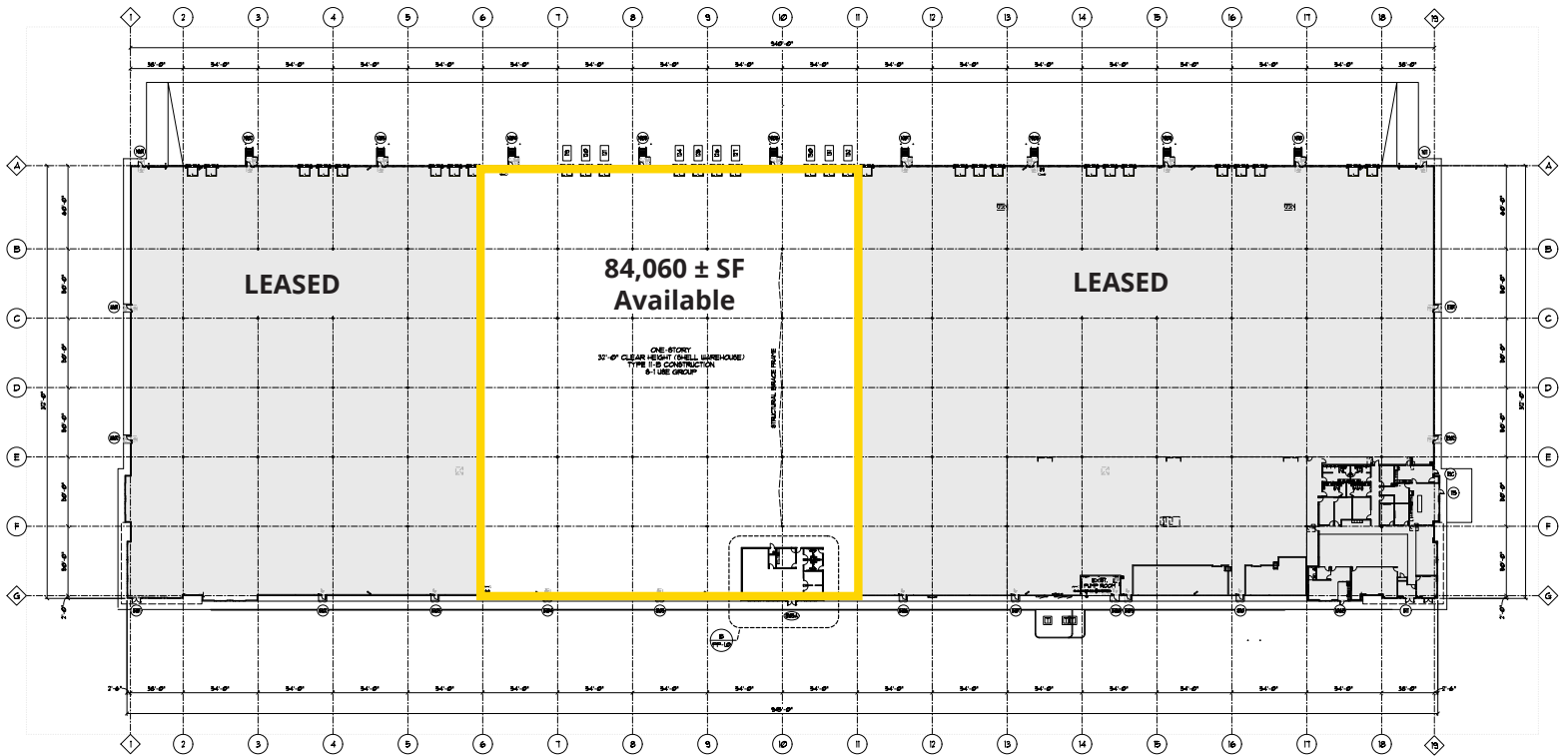

## Office Floor Plan

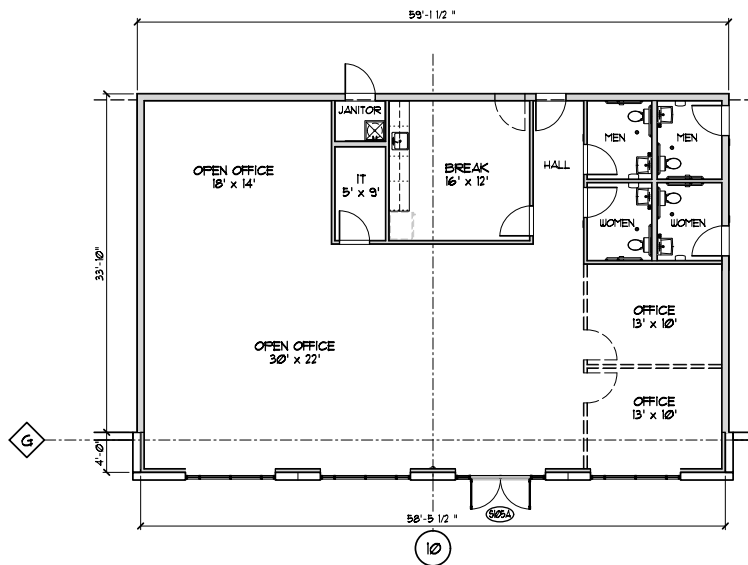



# Access & Amenities

1804 Deffenbaugh Ct  
Columbus, OH 43230



Joel R. Yakovac, SIOR

614.410.5654

Columbus, OH

joel.yakovac@colliers.com

Michael R. Linder, SIOR

614.410.5628

Columbus, OH

michael.linder@colliers.com

Shane E. Woloshan, SIOR

614.410.5624

Columbus, OH

shane.woloshan@colliers.com

Jonathan R. Schuen, SIOR

614.437.4495

Columbus, OH

jonathan.schuen@colliers.com

Kyle M. Ghiloni, SIOR

614.437.4515

Columbus, OH

kyle.ghiloni@colliers.com

The information contained herein was obtained from sources believed reliable; however, Colliers International makes no guarantees, warranties, or representations as to the completeness or accuracy thereof. The presentation of this property is submitted subject to errors, omissions, change of price or conditions prior to sale or lease, or withdrawal without notice.

**Colliers | Greater Columbus Region**

Two Miranova Place, Suite 900

Columbus, OH 43215

[www.colliers.com](http://www.colliers.com)