

# 1265 Glen Avenue

Moorestown, NJ

## Key Facts

Property type	Industrial space
---------------	------------------

Building size	126,239 SF
---------------	------------

Space available	79,930 SF
-----------------	-----------



## Contact Us

Learn more about this property or schedule a tour by reaching out to our local investment and leasing officer.

**Chris McCrea**

+1 (215)-514-9929

[chris.mccrea@eqtpartners.com](mailto:chris.mccrea@eqtpartners.com)

# 1265 Glen Avenue

Moorestown, NJ

## BUILDING SPECIFICATIONS

79,930 SF available in a 126,239 SF warehouse/flex facility

40' x 40' column spacing

24' clear height

120' truck court with concrete pad

8 dock doors; 1 drive-in door

LED lighting

68 car parking spaces

Located within 4 miles from Exit 36B of I-295 and within close proximity of the NJ Turnpike, Philadelphia International Airport

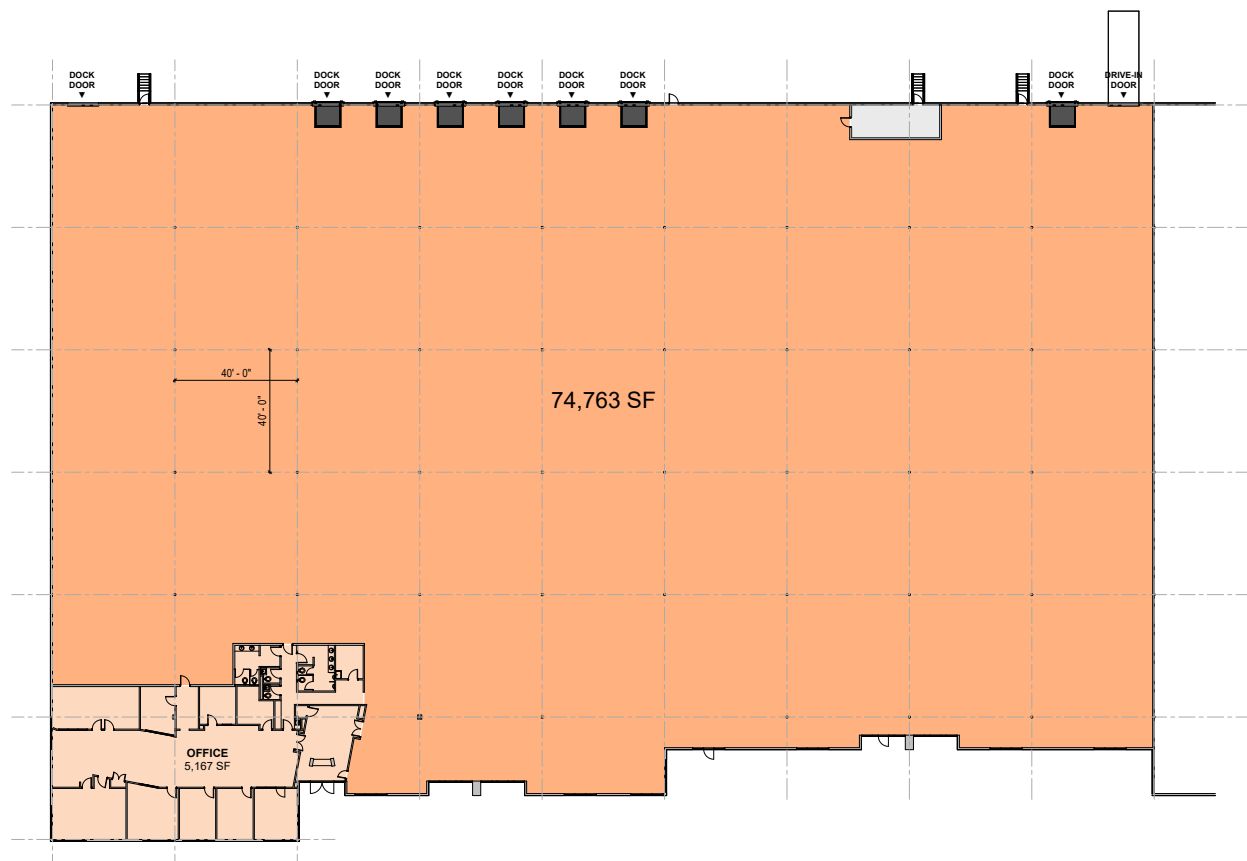

## Contact Us

Learn more about this property or schedule a tour by reaching out to our local investment and leasing officer.

**Chris McCrea**

+1 (215)-514-9929

[chris.mccrea@eqtpartners.com](mailto:chris.mccrea@eqtpartners.com)

# 1265 Glen Avenue

Moorestown, NJ

## SITE PLAN

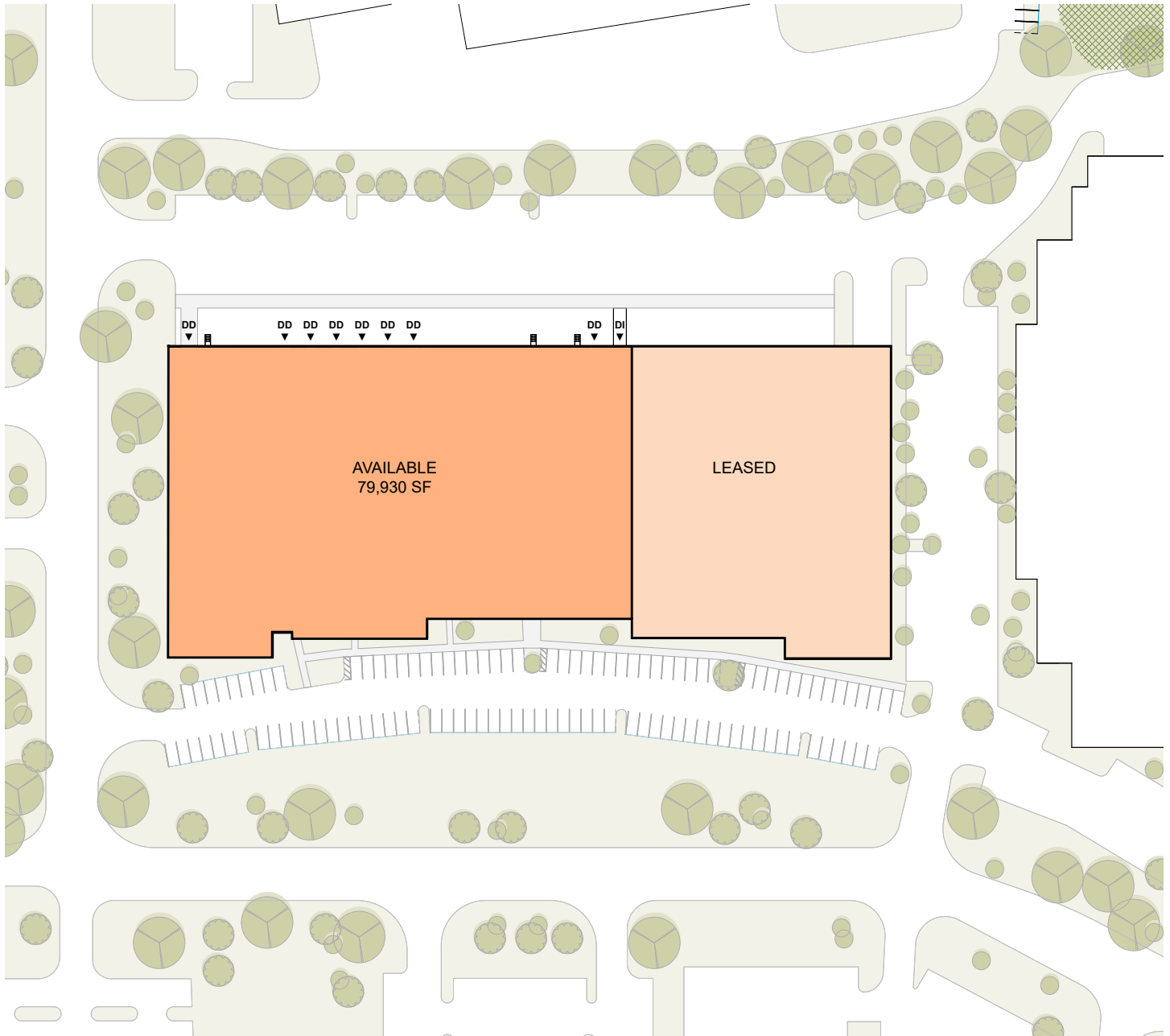

## Contact Us

Learn more about this property or schedule a tour by reaching out to our local investment and leasing officer.

**Chris McCrea**

+1 (215)-514-9929

[chris.mccrea@eqtpartners.com](mailto:chris.mccrea@eqtpartners.com)