



# COMMERCE DRIVE

350 COMMERCE DR, ROCHESTER, NY 14623

## Property Overview

A multi-use building that can function as light industrial, warehouse, distribution, or flex space, 350 Commerce Drive is able to accommodate a large number of uses and tenants. Ceiling heights range from 10' to 11' throughout the space.

## Location Overview

Commerce Drive is located off West Henrietta Road in the town of Henrietta. A signalized intersection allows for easy access onto West Henrietta Road. Drive time to I-90/NYS Thruway and I-390 is just 8 minutes, allowing for quick transit of goods and services to both the Rochester MSA and additional Upstate NY markets.

## Available Spaces

SPACE	LEASE RATE	SIZE
Space 1	\$9.00 - \$10.00 + NNN	4,142 SF

## Property Highlights

- » Quick access to I-390 and I-90/NYS Thruway
- » Plenty of parking
- » 1 door that is 10x10 grade level
- » 2 offices
- » 1 bathroom
- » Sprinklered

Floor Plan

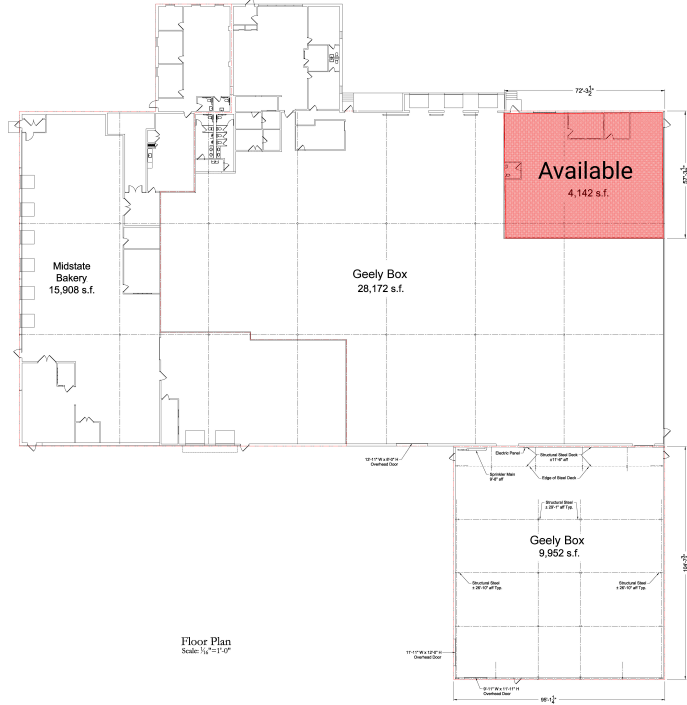

Retail Aerial

