



 **Westwood**
Office/Technology Park

FOR LEASE

36121-36139 SCHOOLCRAFT ROAD LIVONIA, MICHIGAN 48150

Presented by Friedman Real Estate | 248.324.2000 | friedmanrealestate.com



Robert Gagniuk
robert.gagniuk@freg.com



Jordan Friedman
jordan.friedman@freg.com



Rylee Bates
rylee.bates@freg.com



WESTWOOD OFFICE/TECHNOLOGY PARK PROPERTY HIGHLIGHTS

- Westwood Office/Technology Park is comprised of two flex/office buildings in a park-like setting
- Located immediately off I-96 with direct access
- Office campus setting with interior courtyard between buildings
- Up to ±25,000 SF available
- Full building available for up to ±32,000 SF
- M-1 zoning offers maximum flexibility for office, medical, or tech users
- Ability to add overhead doors
- Building façade signage visible from I-96 with traffic counts in excess of 125k vehicles per day
- Proximity to many restaurants, hotels, and area amenities

PROPERTY OVERVIEW

eCode	054
Property Type	Office/R&D
Total SF	±53,177 SF
Year Built	1986
Parking Ratio (per 1,000 SF)	4:33

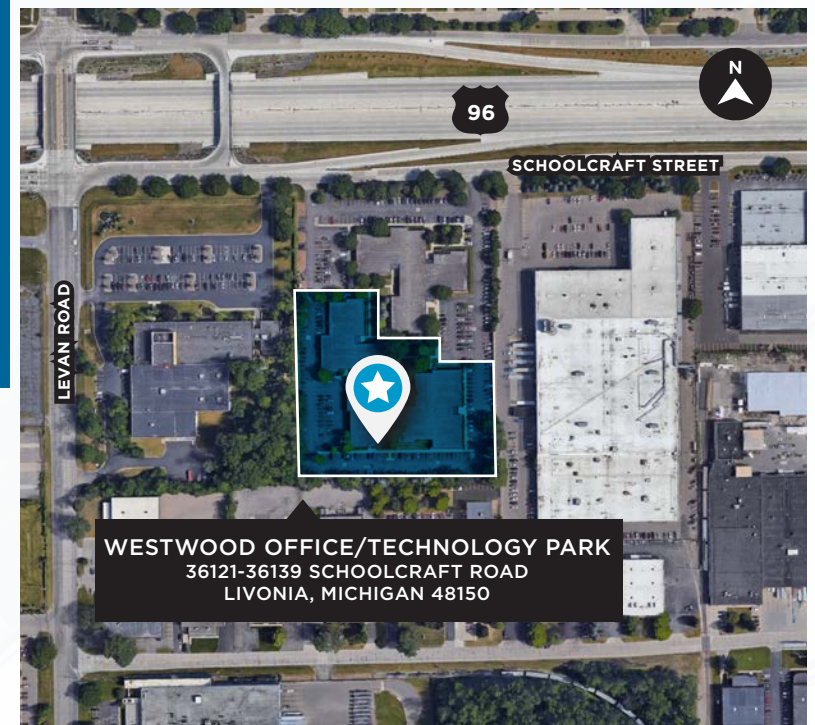

INTERIOR PHOTOS



INTERIOR PHOTOS



EXTERIOR PHOTOS



WESTWOOD OFFICE/TECHNOLOGY PARK SITE PLAN

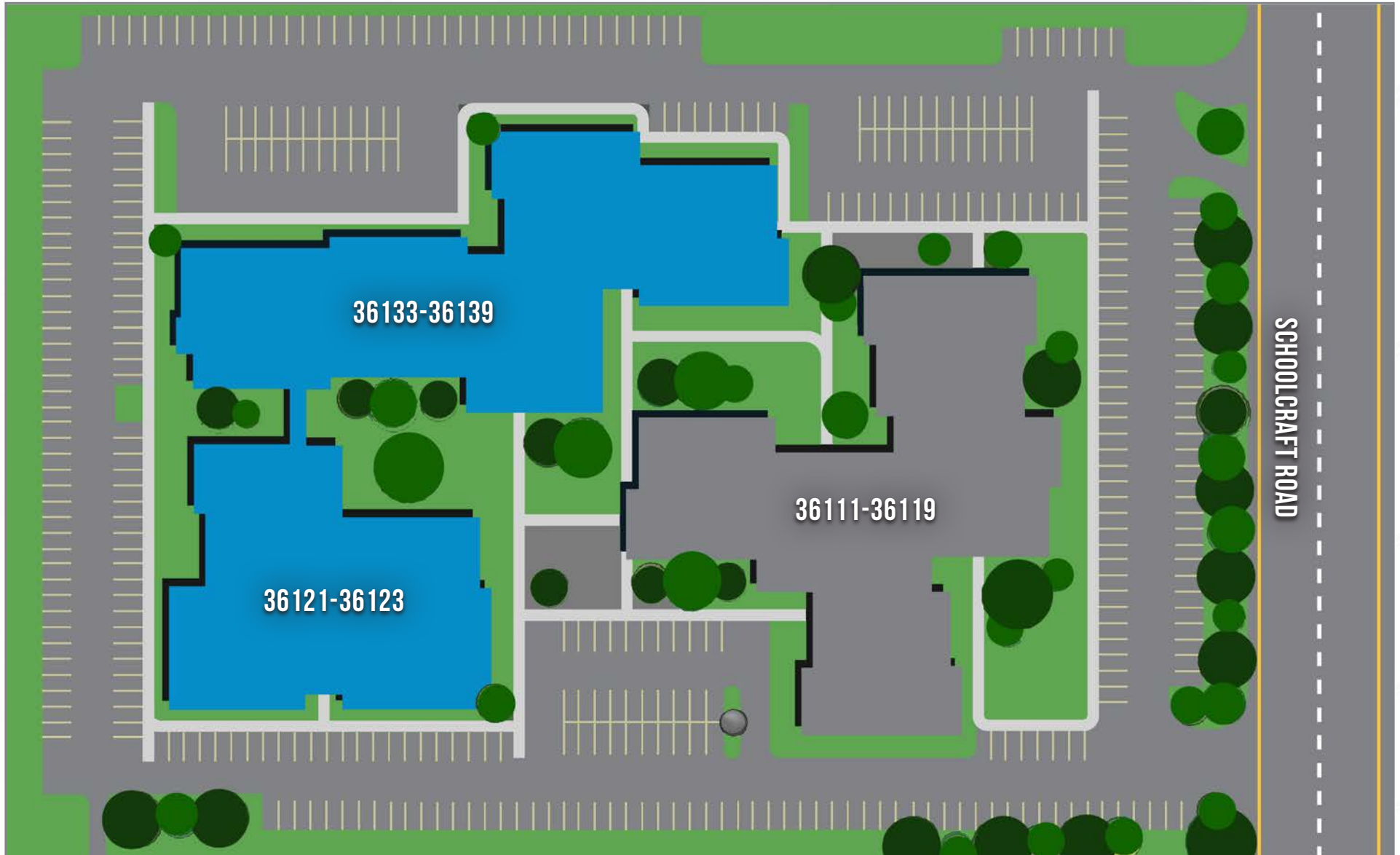

WESTWOOD OFFICE/TECHNOLOGY PARK FLOOR PLAN

21,617 SF
FULL BUILDING AVAILABLE

10,000 SF
AVAILABLE

11,617 SF
AVAILABLE



36121-36123 SCHOOLCRAFT ROAD

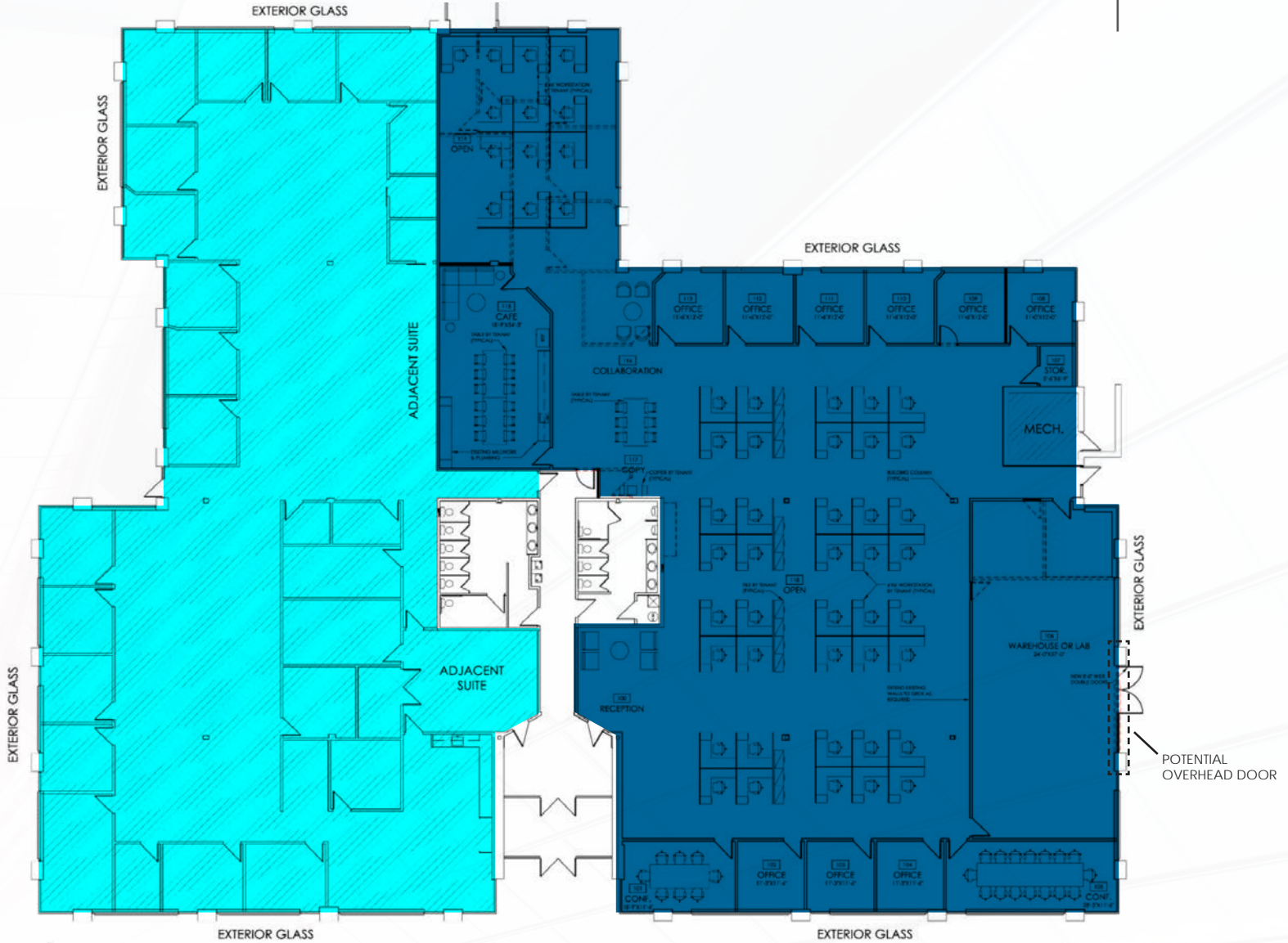

36121-36123 SCHOOLCRAFT ROAD

WESTWOOD OFFICE/TECHNOLOGY PARK FLOOR PLAN



36133-36139 SCHOOLCRAFT ROAD

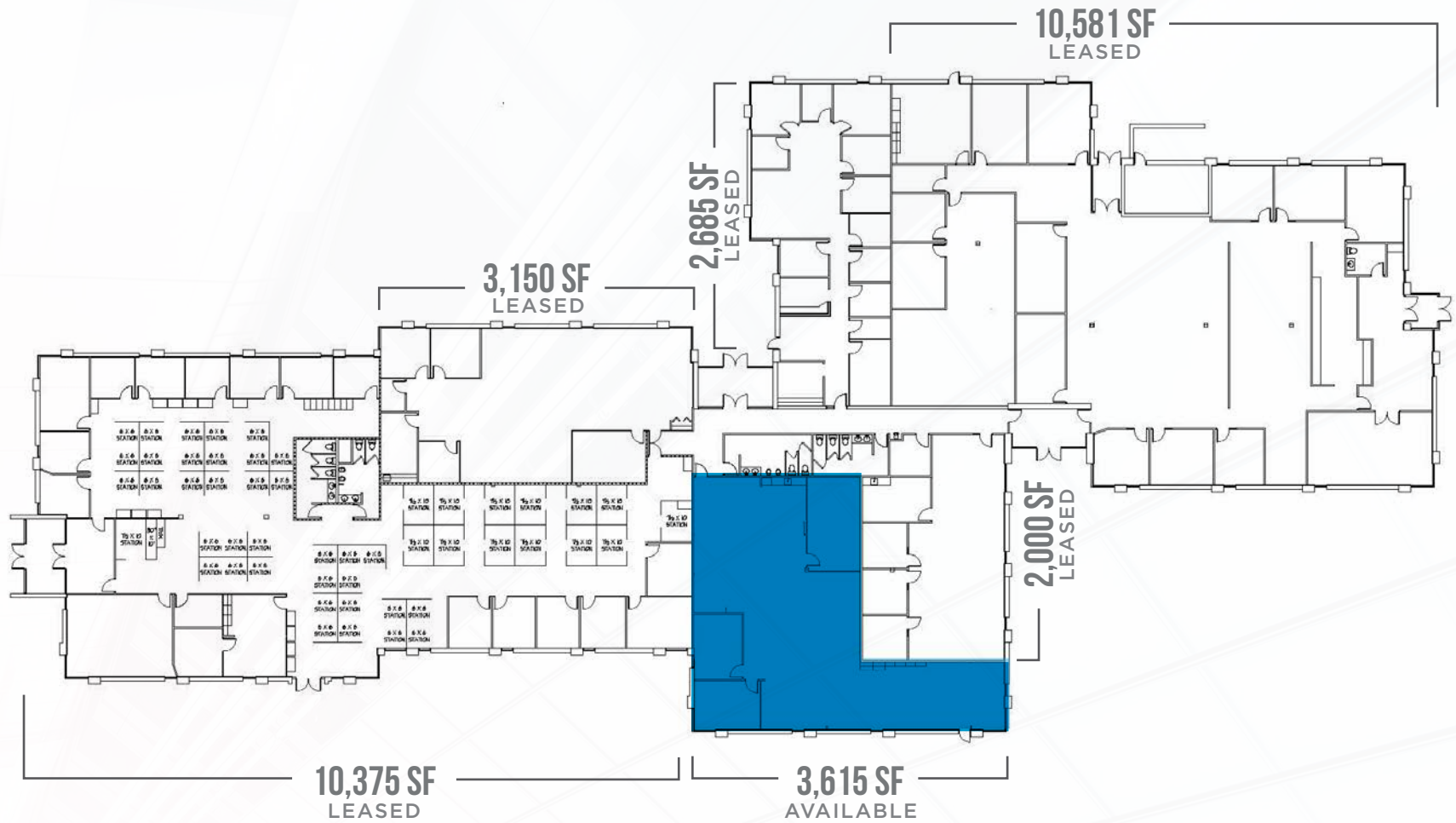

36133-36139 SCHOOLCRAFT ROAD

WESTWOOD OFFICE/TECHNOLOGY PARK AERIAL OVERVIEW



SCHOOLCRAFT ROAD

36133-36139

36111-36119

36121-36123

LEVAN ROAD

INDUSTRIAL ROAD

WESTWOOD OFFICE/TECHNOLOGY PARK LOCAL DRIVE TIMES



DISTANCE TO WESTWOOD OFFICE/TECHNOLOGY PARK	
Ann Arbor	22 Miles
Auburn Hills	33 Miles
Dearborn	17 Miles
Detroit	21 Miles
Detroit Metro Airport	20 Miles
Lansing	73 Miles
Plymouth	4 Miles
Troy	35 Miles
Warren	30 Miles
Windsor	26 Miles

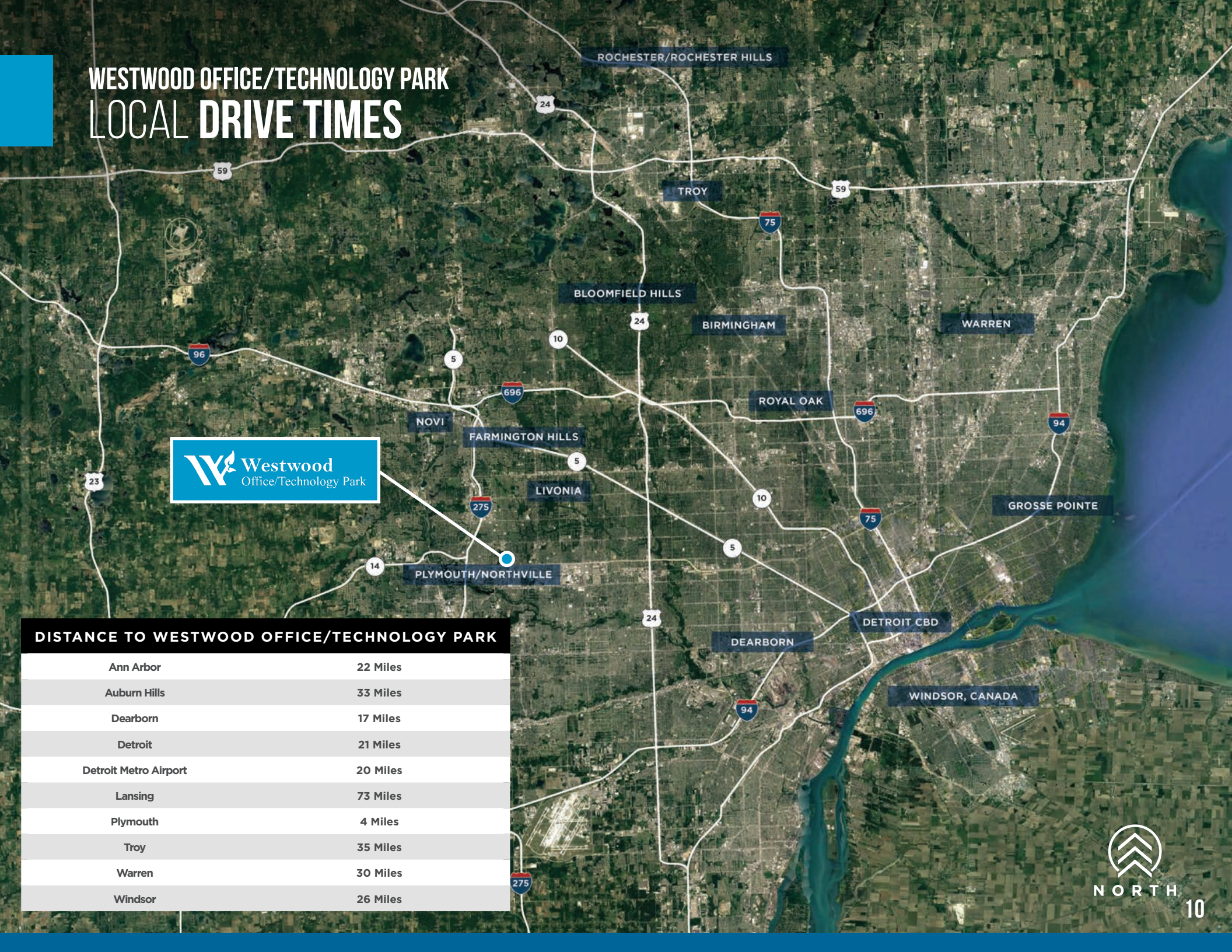



 **Westwood**
Office/Technology Park

FOR LEASE

36121-36139 SCHOOLCRAFT ROAD LIVONIA, MICHIGAN 48150

Presented by Friedman Real Estate | 248.324.2000 | friedmanrealestate.com



Robert Gagniuk
robert.gagniuk@freg.com



Jordan Friedman
jordan.friedman@freg.com



Rylee Bates
rylee.bates@freg.com



LEARN MORE

