

RATIONAL METHOD - STORM WATER RUNOFF CALCULATIONS FOR DEVELOPED ONSITE DRAINAGE AREAS

INLET CALCULATIONS FOR 100YR STORM (ALL CURB INLETS TYPE 1 IN SUMP WITH 10% REDUCTION)

INLET #	AREA #	Q NET (CFS)	L (FT)	L x 0.90 (FT)	Q/L (CFS/FT)	Yo + 5" (FT)	INLET Yo (FT)
C1	C	15.8	10	9	1.76	0.70	0.28

INLET CALCULATIONS FOR 25YR STORM (ALL CURB INLETS TYPE 1 IN SUMP WITH 10% REDUCTION)

INLET #	AREA #	Q NET (CFS)	L (FT)	L x 0.90 (FT)	Q/L (CFS/FT)	Yo + 5" (FT)	INLET Yo (FT)
C1	C	11.4	10	9	1.27	0.56	0.14

RATIONAL METHOD - STORM WATER RUNOFF CALCULATIONS FOR DEVELOPED ONSITE DRAINAGE AREAS

DF COEFFICIENTS

	25-YEAR	100-YEAR
a	82.936	118.30
b	10.746	13.185
c	0.7634	0.7736

RUNOFF COEFFICIENTS

	25-YEAR	100-YEAR
PERV.	0.34	0.41
IMP.	0.86	0.95

DEVELOPED DRAINAGE AREAS

Drainage Area	AREA (AC)	PERV. AREA (AC)	IMP. AREA (AC)	Tc (MIN)	C25 COMP	C100 COMP	I25 (IN/HR)	I100 (IN/HR)	Q25 (CFS)	Q100 (CFS)
A	2.46	0.39	2.06	5	0.78	0.86	10.11	12.54	19.3	26.6
B	0.90	0.37	0.53	5	0.65	0.73	10.11	12.54	5.9	8.2
C	1.58	0.44	1.14	5	0.72	0.80	10.11	12.54	11.4	15.8
D	1.35	0.27	1.08	5	0.76	0.84	10.11	12.54	10.3	14.3
E	0.70	0.35	0.35	5	0.60	0.68	10.11	12.54	4.2	6.0
OS1	0.11	0.11	0.00	5	0.34	0.41	10.11	12.54	0.4	0.6
OS2	0.08	0.07	0.01	5	0.41	0.48	10.11	12.54	0.3	0.5
OS3	0.41	0.08	0.33	5	0.76	0.84	10.11	12.54	3.1	4.3

NOTES: ALL SMALL DEVELOPED AREAS ASSUMED TO HAVE 5 MIN. TIME OF CONCENTRATION

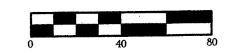

- LEGEND:**
- # DRAINAGE AREA NUMBER
 - # INLET NUMBER
 - FLOW DIRECTION ARROW
 - ⊕ HIGH POINT
 - ⊖ LOW POINT
 - DRAINAGE DIVIDE
 - ▬ PROPOSED INLET AND STORM SEWER SYSTEM
 - Q=1.5/3.0 Q=25YR/100YR

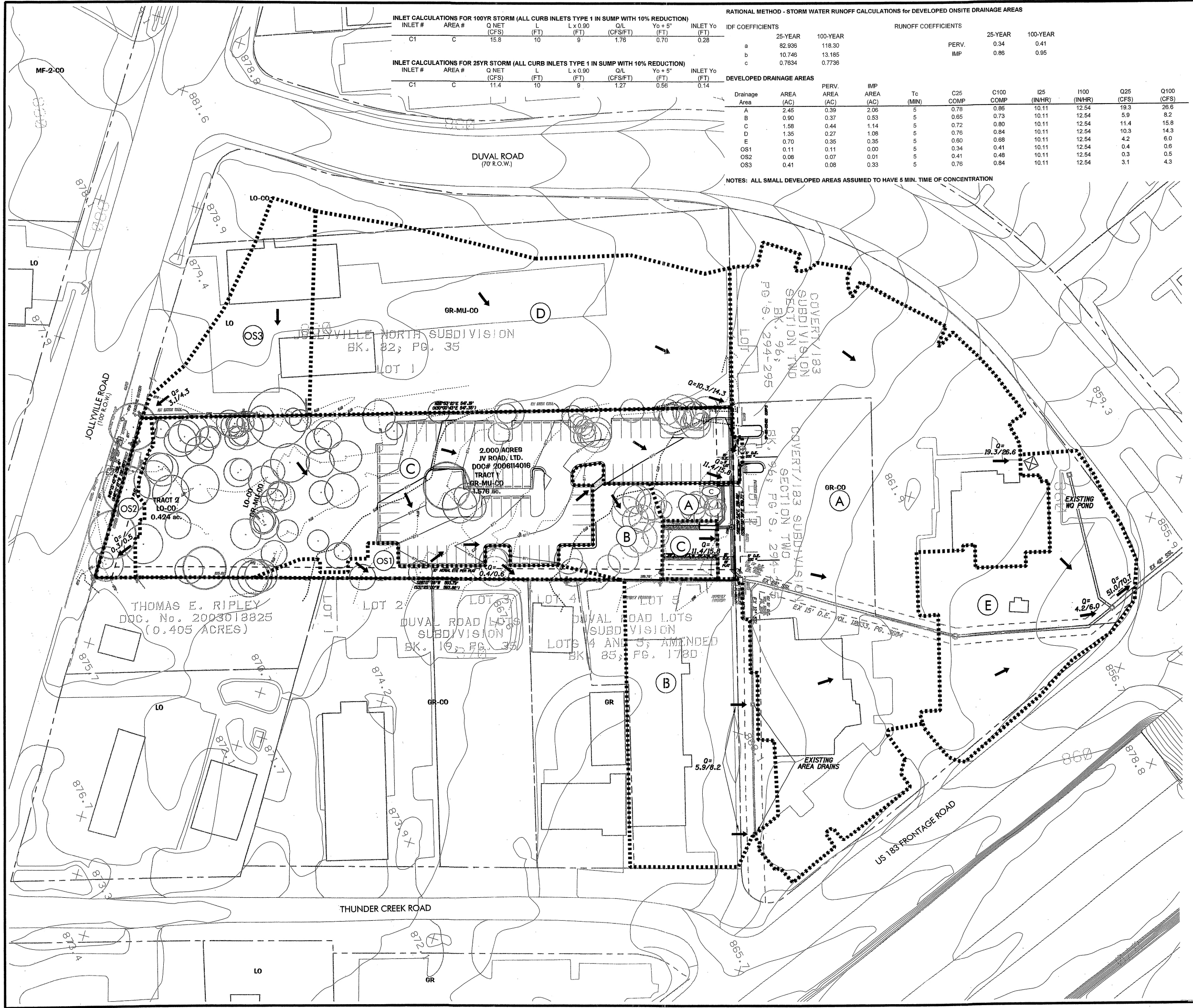

REVISION	DATE	BY

DRAWING	DESIGN	STANDARDS	QUALITY

JV ROAD
ADMINISTRATIVE CONSOLIDATED SITE PLAN
 11680 1/2 RESEARCH BOULEVARD SOUTHBOUND
 DEVELOPED CONDITIONS DRAINAGE AREA MAP

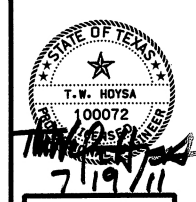

LONGARO & CLARKE
 Consulting Engineers
 Land Development • Stormwater Management • Water Resources
 7201 North Capital of Texas Highway, Building A, Suite 250 Austin, Texas 78751
 (512) 506-0239 • www.LongaroClarke.com • TPE Reg. No. P-344

APPROVED AND RELEASED
 SEP 12 2011
 CITY OF AUSTIN

DM1

9 / 15
 SP-2011-0121D