

# AVAILABLE FOR LEASE

PROMINENT FREESTANDING RETAIL BUILDING  
APPROXIMATELY 22,420 SQUARE FEET (DIVISIBLE)

**NAI Capital**  
COMMERCIAL REAL ESTATE SERVICES, WORLDWIDE



**1815 S. Vermont Ave., Los Angeles, CA 90006**

## Property Highlights:

- Major Signalized Corner Near Koreatown, DTLA, Pico Union and Mid City Areas of Los Angeles.
- Extremely Dense Population with Over 350,000 People Within 2 Miles
- Parking Ratio: 3.4 / 1,000
- Clear Height: 17' 11" – 17' 7" (To Bottom of Joists)
- Age: 1988
- Construction Type: Concrete Block
- New Flat TPO Roof Installed 2020
- **Contact Broker for Economics**

DEMOGRAPHICS	1 MILES	2 MILES	3 MILES
TOTAL POPULATION	77,919	350,368	655,704
AVG. HH INCOME	\$72,331	\$81,276	\$90,431
DAYTIME POPULATION	42,925	256,068	520,296

## FOR MORE INFORMATION:

### Steven H. Weiss

Executive Vice President  
818 905 2400 Ext. 1634  
sweiss@naicapital.com  
Cal DRE Lic #0068554

### Sam Kangavari

Senior Vice President  
310.806.6135  
skangavari@naicapital.com  
Cal DRE Lic #01846336

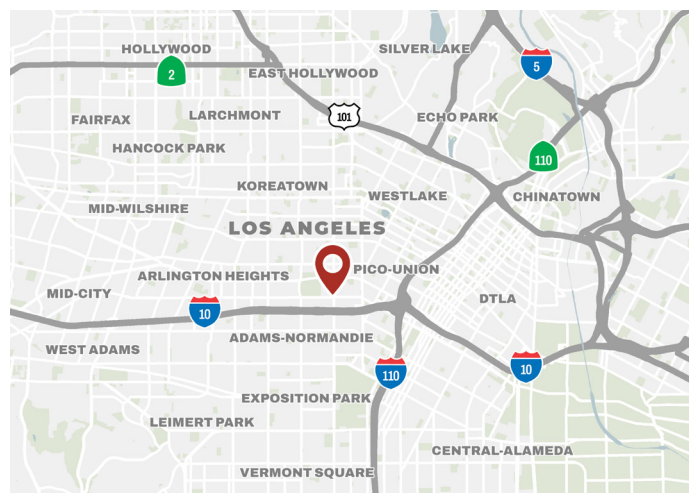

## TRAFFIC COUNT

S. Vermont Ave	41K CPD
W. Washington Blvd	17K CPD
<b>TOTAL:</b>	<b>58K CPD</b>

No warranty, express or implied, is made as to the accuracy of the information contained herein. This information is submitted subject to errors, omissions, change of price, rental or other conditions, withdrawal without notice, and is subject to any special listing conditions imposed by our principals. Cooperating brokers, buyers, tenants and other parties who receive this document should not rely on it, but should use it as a starting point of analysis, and should independently confirm the accuracy of the information contained herein through a due diligence review of the books, records, files and documents that constitute reliable sources of the information described herein. Logos are for identification purposes only and may be trademarks of their respective companies. NAI Capital, Inc. CA DRE Lic. #02130474.



# 1815 S. Vermont Ave

Los Angeles CA 90006

## Site Plan

### FOR LEASE

PROMINENT FREESTANDING RETAIL BUILDING

APPROXIMATELY 22,420 SQUARE FEET

#### SITE 'A'

Parking RQD Total	54
Parking Provided	84
Covenant - Site B	20
Non-Required	10

#### SITE 'B'

Parking RQD Total	82
Parking Provided	62
Covenant at BLDG A	20

Standard Stalls	27
Compact	33
Handicap	2
Non-Required Compact	1

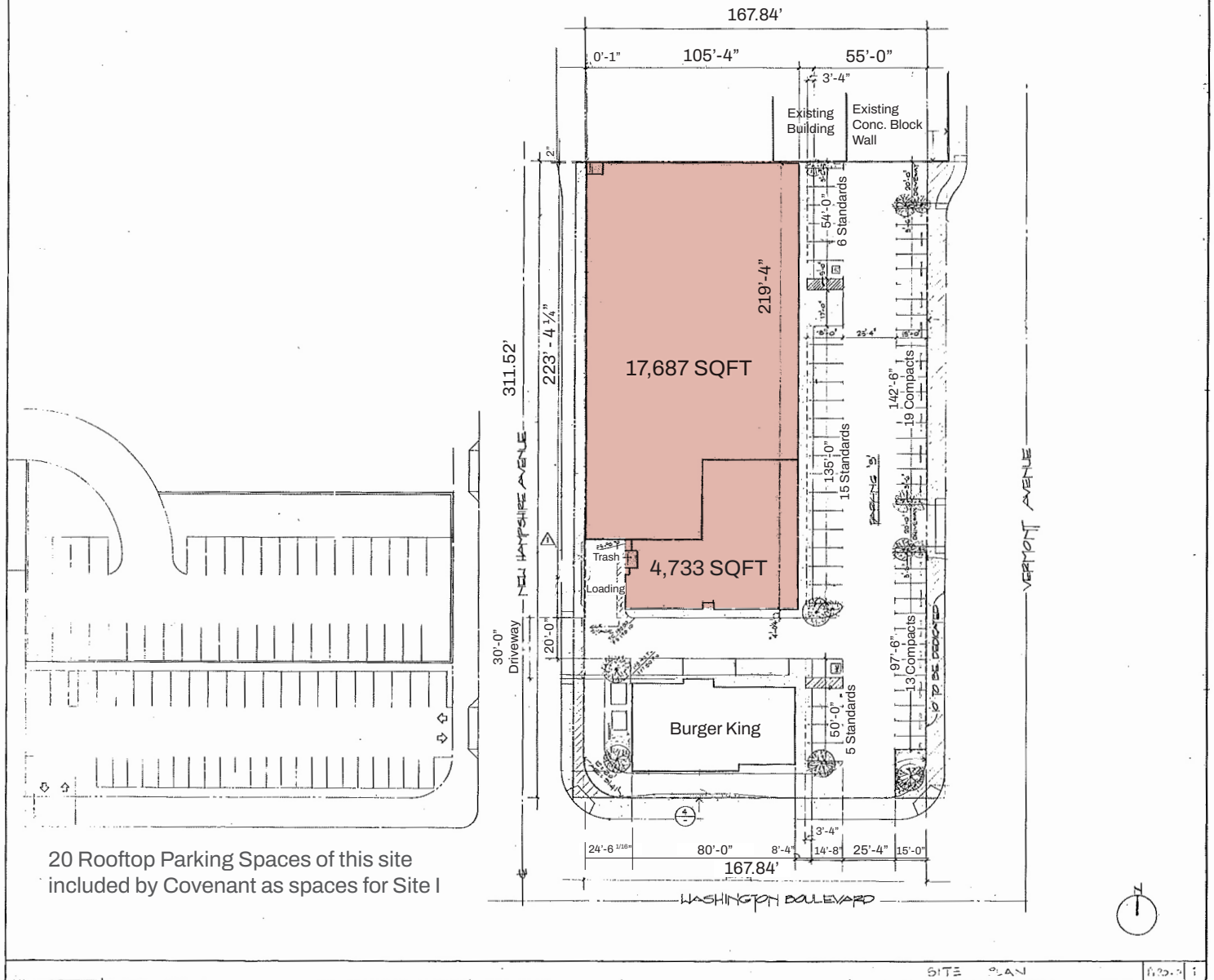

For more information:

**Steven H. Weiss**  
Executive Vice President  
818 905 2400 Ext. 1634  
sweiss@naicapital.com  
Cal DRE Lic #0068554

**Sam Kangavari**  
Senior Vice President  
310.806.6135  
skangavari@naicapital.com  
Cal DRE Lic #01846336