



## WOODLAND BUILDING

740 East 3900 South, Millcreek, UT 84107

### PROPERTY DESCRIPTION:

- Main Floor Office Suite Available with Updated Paint & Carpet
- Great Access to I-15 and Right Off 700 East
- Nearby St. Marks Hospital and Millcreek Amenities
- 3.5/1,000 Parking Ratio
- Monument Signage Available
- Kitchenette in Suite 103
- Suites 103 & 104 May be Combined for 1,850 RSF

### LEASE RATE:

**\$14.00 SF/YR**  
**(Full Service)**

### PROPERTY DETAILS:

**Suite 103: 1,140 RSF**  
**Suite 104: 710 RSF**

**NICO PRISKOS**

801.413.8902  
nico@iproperties.com

51 East 400 South Suite 210  
Salt Lake City, UT 84111  
801.355.0600 | iproperties.com



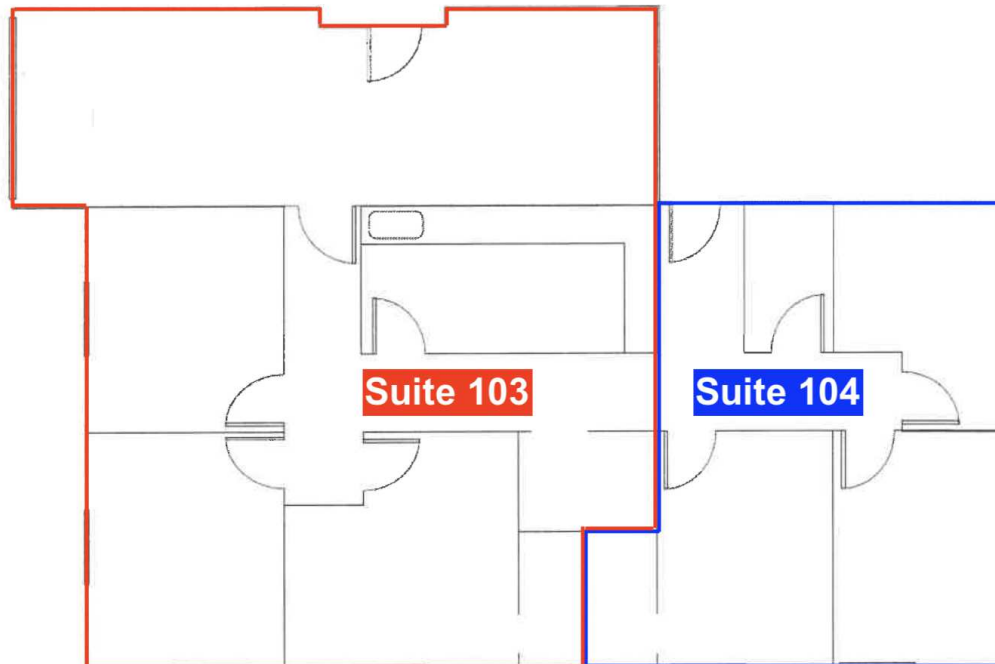

Suite 103 & 104

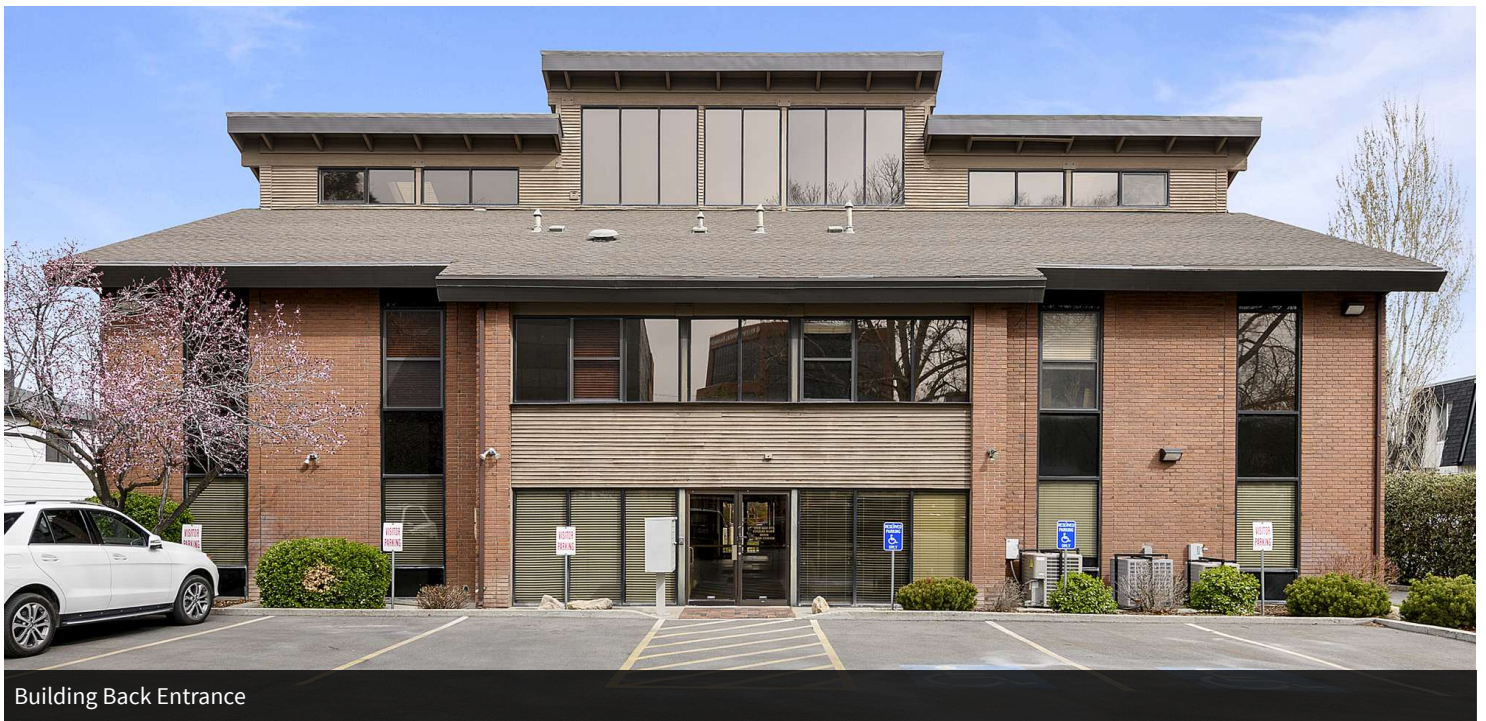

Building Back Entrance





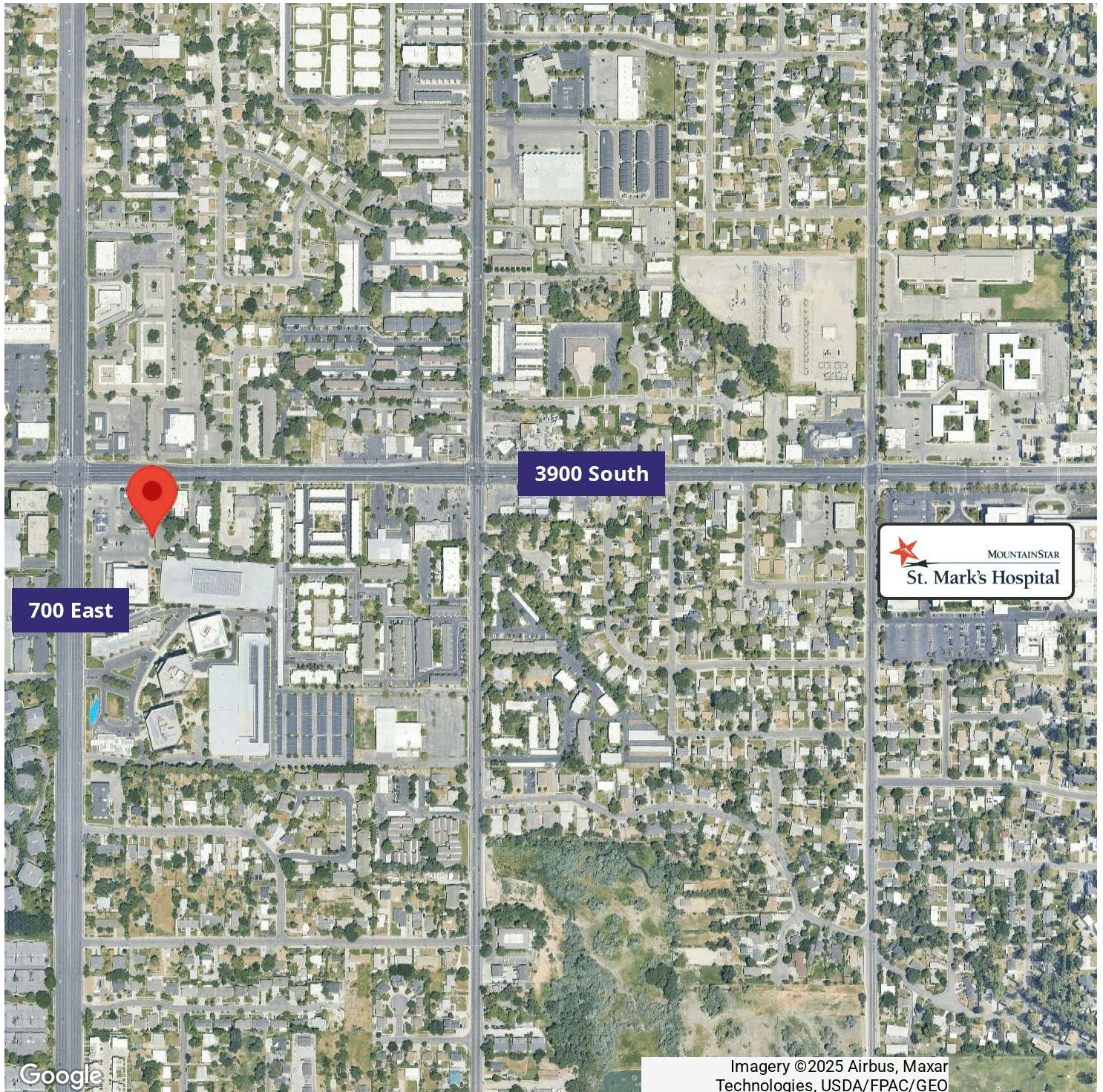

**NICO PRISKOS**  
801.413.8902  
nico@iproperties.com

51 East 400 South Suite 210  
Salt Lake City, UT 84111  
801.355.0600 | iproperties.com