

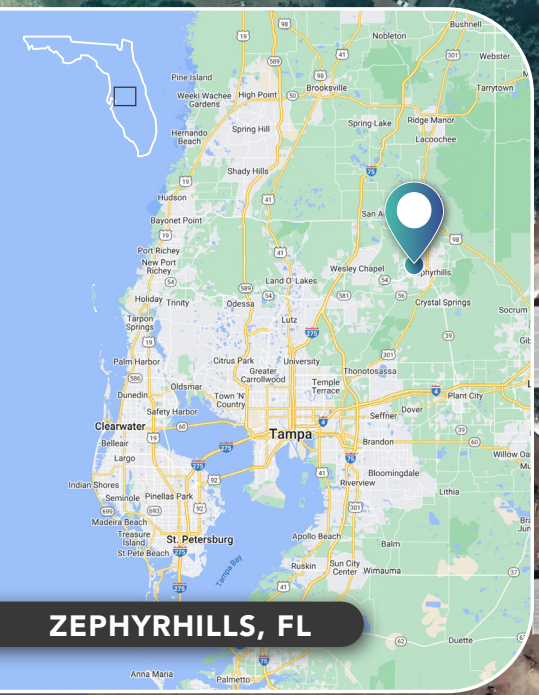

ZEPHYRHILLS PRIME RETAIL PAD

GROUND LEASE • 3.37± AC PRIME RETAIL PAD
NEQ OF EILAND BLVD & DEAN DAIRY RD • ZEPHYRHILLS, FL 33542



ZEPHYRHILLS, FL

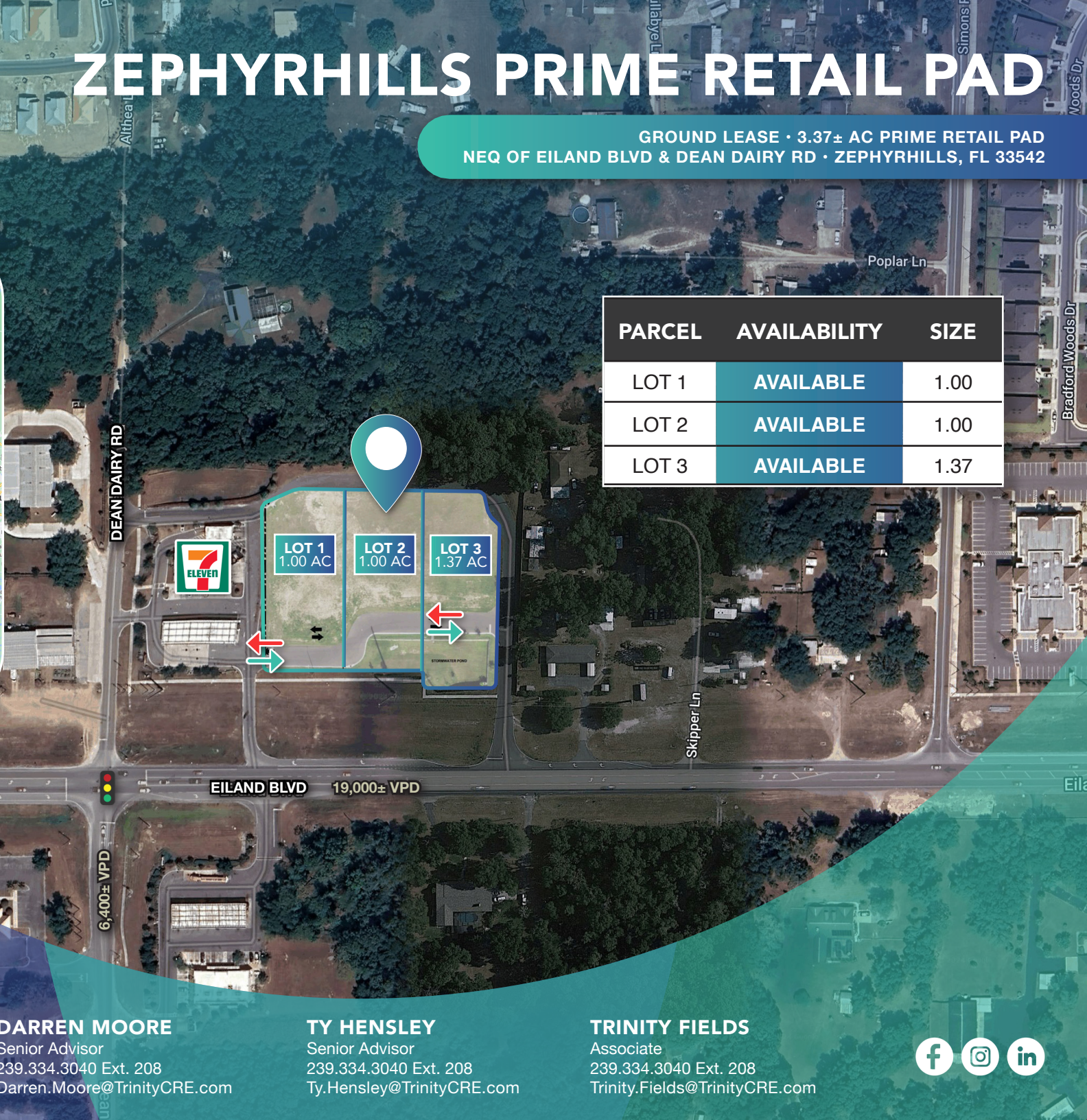

PARCEL	AVAILABILITY	SIZE
LOT 1	AVAILABLE	1.00
LOT 2	AVAILABLE	1.00
LOT 3	AVAILABLE	1.37

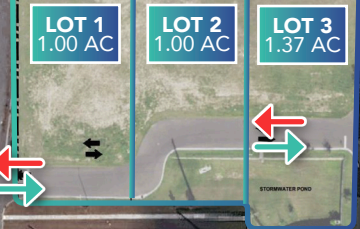

Eiland Blvd

EILAND BLVD 19,000± VPD

6,400± VPD

DEAN DAIRY RD

Skipper Ln

CONTACT US:

DARREN MOORE
Senior Advisor
239.334.3040 Ext. 208
Darren.Moore@TrinityCRE.com

TY HENSLEY
Senior Advisor
239.334.3040 Ext. 208
Ty.Hensley@TrinityCRE.com

TRINITY FIELDS
Associate
239.334.3040 Ext. 208
Trinity.Fields@TrinityCRE.com



ZEPHYRHILLS PRIME RETAIL PAD

GROUND LEASE • 3.37± AC PRIME RETAIL LAND
NEQ OF EILAND BLVD & DEAN DAIRY RD • ZEPHYRHILLS, FL 33542

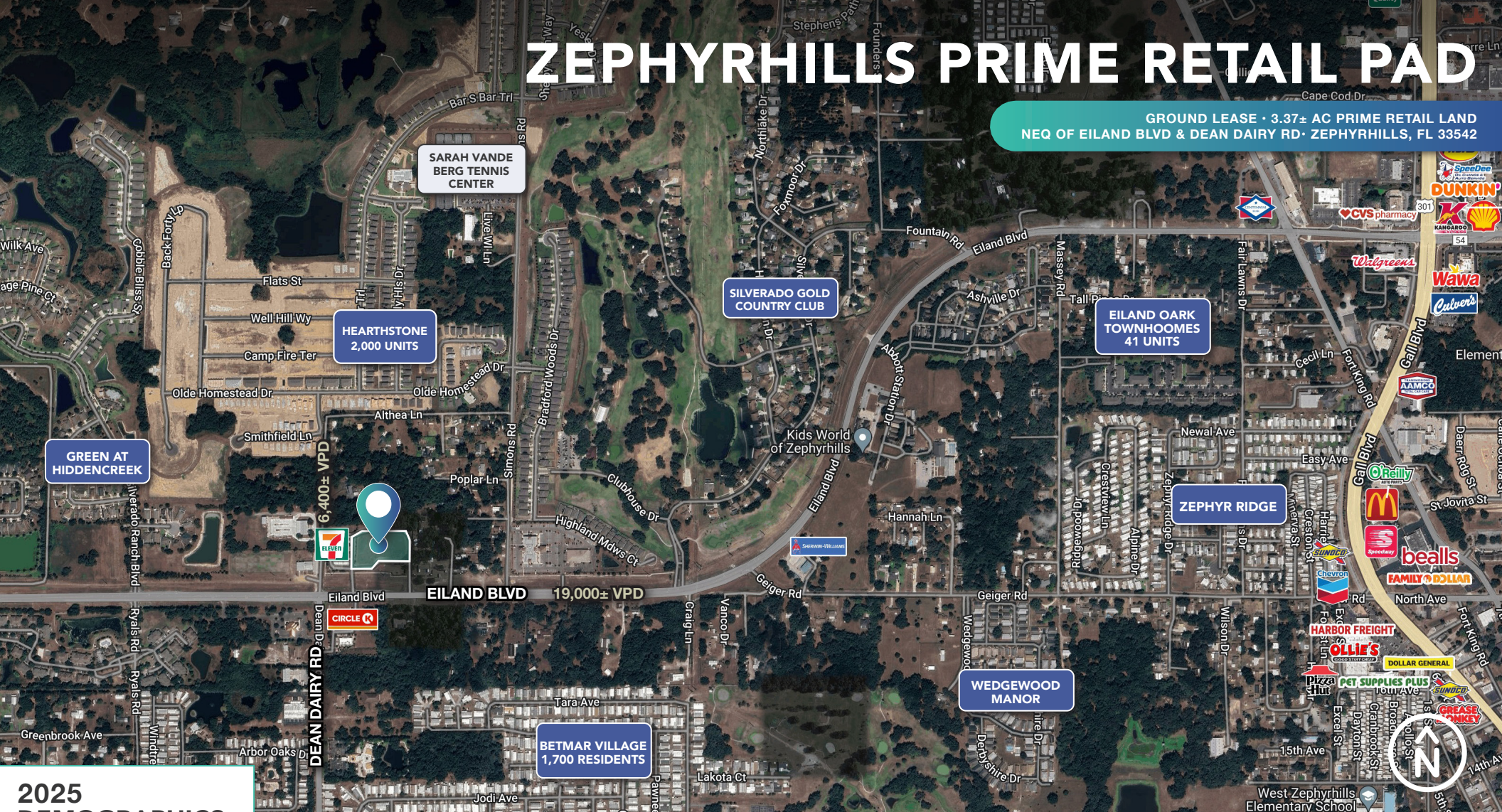

2025 DEMOGRAPHICS ZEPHYRHILLS RETAIL PAD

	1 MILE	3 MILE	5 MILE
AVERAGE H.H INCOME	\$59,459	\$57,052	\$63,761
POPULATION	8,102	55,413	83,546
EMPLOYMENT DENSITY	437	11,371	15,445

PROPERTY FEATURES

PRICE	Call for Details
AVAILABLE	1 - 3.37± AC
ZONING	C-2
LOCATION	The subject site is located on the NEQ of Eiland Blvd & Dean Dairy Rd.



TrinityCRE.com
9450 Corkscrew Palms Cir • Suite 101 • Estero, FL 33928
© 2025 Trinity Commercial Group
This information is considered accurate, but not guaranteed.

