

# RETAIL SPACE AVAILABLE

One Roebling Way  
Covington, Kentucky 41011



## 1,700 SF Street Level Retail Space Available

- in The Ascent at Roebling's Bridge condominium tower - *One and only space available*
- Greater Cincinnati's Signature Building
- Award Winning Architecture: CNBC/New York Times named The Ascent "the Best High Rise in the Americas" in 2008

### Demographics

Population within 3 miles	129,142
Adjusted Daytime Population	218,989
Businesses within 1 mile	2,790
Businesses within 3 miles	8,735
Employees within 1 mile	64,096
Employees within 3 miles	173,058
Consumer Expenditure	\$2,191,677,519
Food and Beverage Spending within 1 mile	\$41,570,556
Food and Beverage Spending within 3 miles	\$345,291,944

### \*Northern Kentucky Convention Center

Annual Visitors to Northern Kentucky Convention Center 130,000 (365/day)

- Scheduled convention notices with meal information
- Will distribute information for Retail Space Tenant to potential event holders

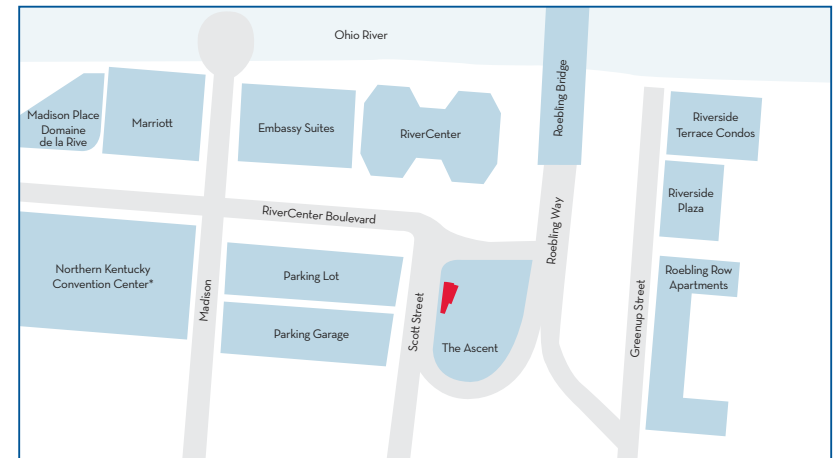

For More Information Contact: Brett Lowery  
859.292.5548 office  
937.974.5631 cell  
blowery@corporex.com



www.corporex.com

\*\*Please see reverse for space plan

# AVAILABLE RETAIL SPACE

THE ASCENT AT ROEBLING'S BRIDGE – COVINGTON, KENTUCKY  
1,700 SF

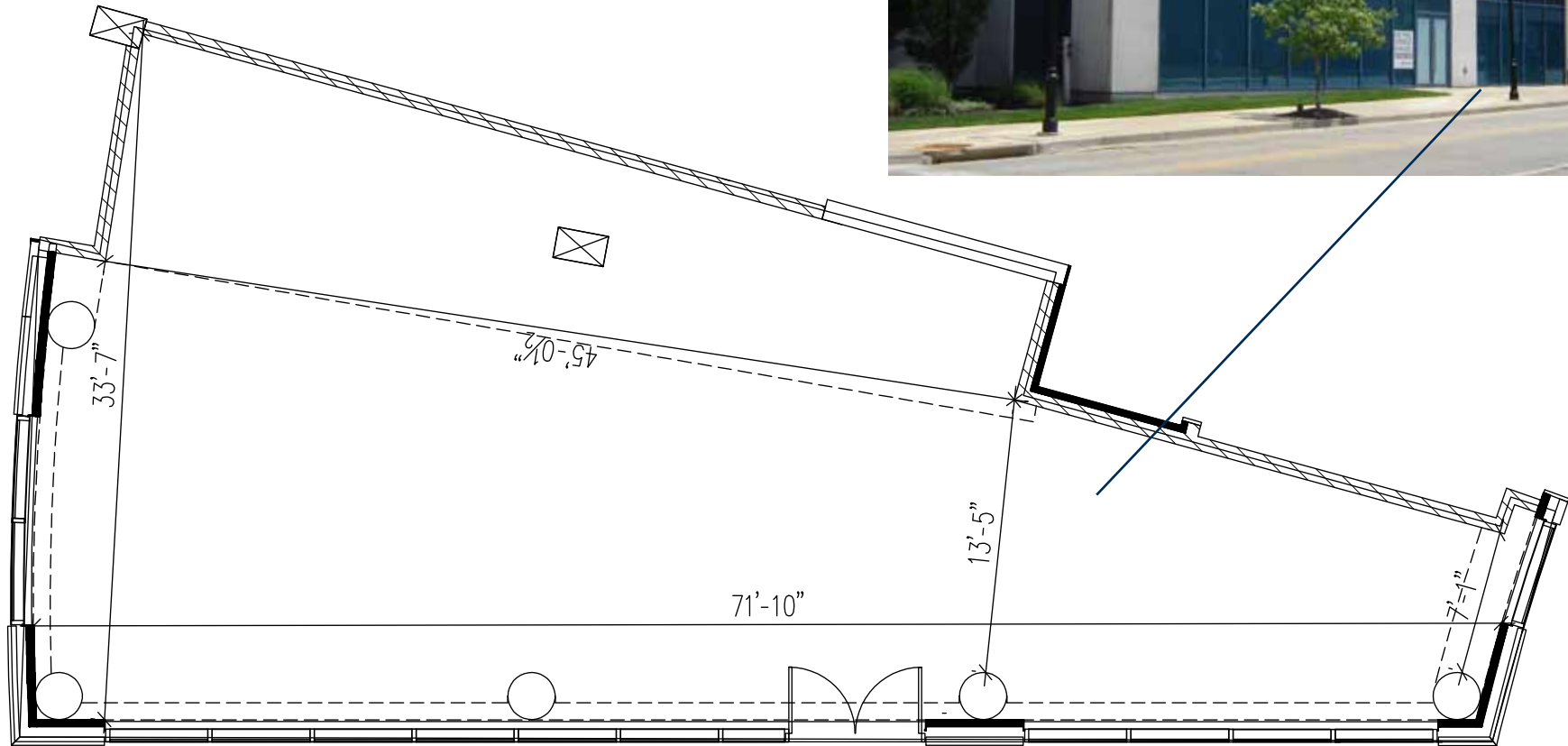

For More Information Contact: Brett Lowery  
859.292.5548 office  
937.974.5631 cell  
blowery@corporex.com

**Corporex**

[www.corporex.com](http://www.corporex.com)