

LAKEFRONT DEVELOPMENT PROPERTY FOR SALE

3150 Nonaville Road

MT JULIET, TN 37122



JAMIE BRANDENBURG, SIOR

Commercial Real Estate Advisor
jamie@industrialtn.com
M 615.487.2100

WES WRAY

Broker
wes@industrialtn.com
M 270.320.7522

THE ———
INDUSTRIAL
——— GROUP

COMPASS COMMERCIAL

4031 ASPEN GROVE DRIVE, SUITE 400, FRANKLIN TN 37067 | O 615.475.5616

PROPERTY DESCRIPTION

Rare opportunity! 21.06 acres in Mt Juliet along Old Hickory Lake. Prime for development - potential for approximately 45 lot development based on Seller design. Close proximity to Cedar Creek Yacht Club.

PROPERTY DETAILS	
Lot Size	21.06 Acres
Sales Price	\$5,950,000
Zoning	Residential

POPULATION	2 MILE	5 MILE	10 MILES
2010	6,050	64,187	238,093
2023	6,815	81,784	294,570

HOUSEHOLDS	2 MILE	5 MILE	10 MILES
2010	2,318	24,758	94,475
2023	2,602	31,602	115,236

INCOME	2 MILE	5 MILE	10 MILES
Avg. HHI	\$120,510	\$108,642	\$95,446

PROPERTY FEATURES

- All utilities at the street including gas, water, electric
- Public sewer at the street
- Lakefront dockable lots

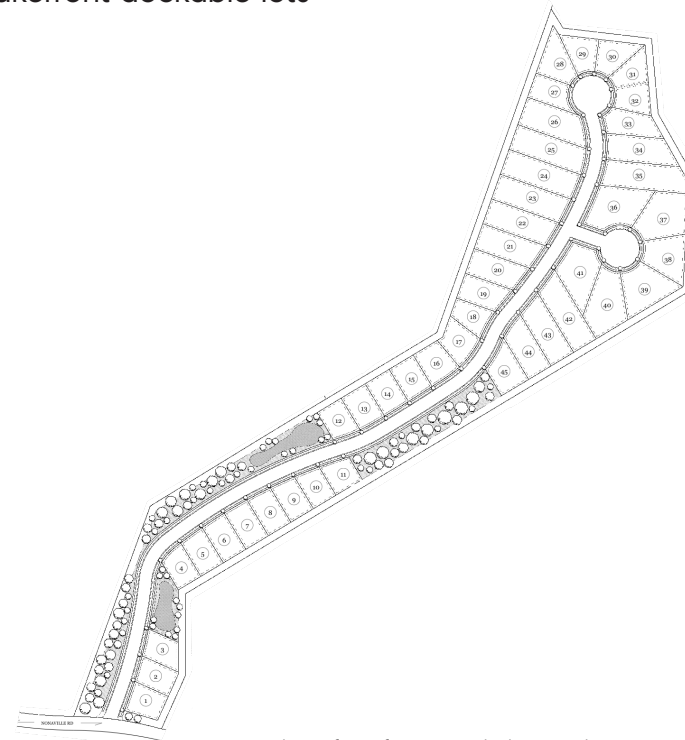

Plat is for reference only, has not been approved

LAKEFRONT DEVELOPMENT PROPERTY FOR SALE

3150 Nonaville Road

MT JULIET, TN 37122

THE
INDUSTRIAL
GROUP



LAKEFRONT DEVELOPMENT PROPERTY FOR SALE

3150 Nonaville Road

MT JULIET, TN 37122

THE
INDUSTRIAL
GROUP



LAKEFRONT DEVELOPMENT PROPERTY FOR SALE

3150 Nonaville Road

MT JULIET, TN 37122

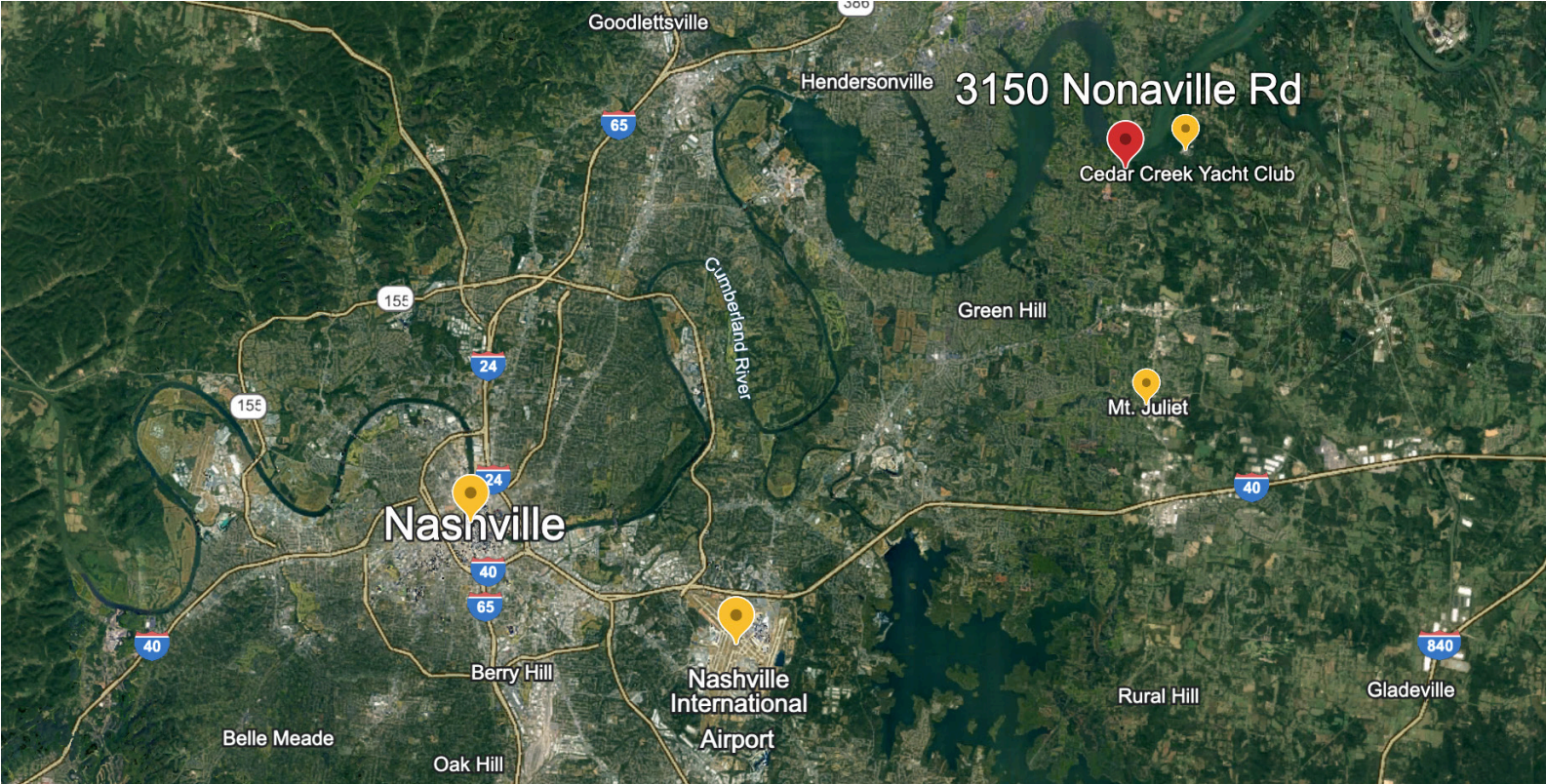

JAMIE BRANDENBURG, SIOR

Commercial Real Estate Advisor
jamie@industrialtn.com
M 615.487.2100



WES WRAY

Broker
wes@industrialtn.com
M 270.320.7522

THE
INDUSTRIAL
GROUP

COMPASS COMMERCIAL