

1,544–9,888 SF  
RETAIL SPACE  
FOR LEASE

# WESTBROOK SHOPPING CENTER

9140 W. 100TH AVENUE | WESTMINSTER, CO 80021



**KINSEY & COMPANY**  
COMMERCIAL REAL ESTATE

**Jason F. Kinsey**  
Managing Principal  
720-280-5757  
Jason@KinseyCRE.com

**Brady Kinsey**  
Principal  
303-847-1295  
Brady@KinseyCRE.com

# WESTBROOK SHOPPING CENTER

9140 W. 100TH AVENUE | WESTMINSTER, CO 80021

## AVAILABILITY

- SF Available: 1,544 – 9,888 SF
- Pricing: Contact Broker

## TRAFFIC COUNTS

- W 100th Avenue: 21,579 VPD

Source: 2022 MPSI Estimates

## HIGHLIGHTS

- Monument signage opportunity on W 100th Ave (21,579 VPD)
- Located directly to the north of a King Soopers and Ace Hardware anchored shopping center
- NEW OWNERSHIP! Tenant Improvement allowance and rent abatement available for qualified Tenants
- The shopping center is close to Standley Lake High School, Westminster Hills Off-Lease Dog Park, Arista and more
- A12 - A13 is currently built out as a church. This suite can be demised down to 2,994 and 3,120 SF.



# WESTBROOK SHOPPING CENTER

9140 W. 100TH AVENUE | WESTMINSTER, CO 80021



Wadsworth Blvd (36,883 VPD)

W 100th Ave (21,116 VPD)



**1,544–9,888 SF  
RETAIL SPACE  
FOR LEASE**

# WESTBROOK SHOPPING CENTER

9140 W. 100TH AVENUE | WESTMINSTER, CO 80021

W 100th Ave. - 21,579 VPD

**CIRCLE K**  
N.A.P.

N.A.P.

**KING  
Soopers**

N.A.P.

## Tenants

UNIT	TENANT
A1/A2	Angels Adult Care
A3	Red Eye Coffee
A4	Home Cleaning
A5	Hookah
A6	Elevate Lounge
A7	St James
A8	1,544 SF AVAILABLE
A9	Pet Design
A10	3,454 SF AVAILABLE
A12-A13	6,234 SF AVAILABLE
A11	E.motion

A10  
3,454 SF  
AVAILABLE

A12-13  
6,234 SF  
AVAILABLE



# WESTBROOK SHOPPING CENTER

9140 W. 100TH AVENUE | WESTMINSTER, CO 80021

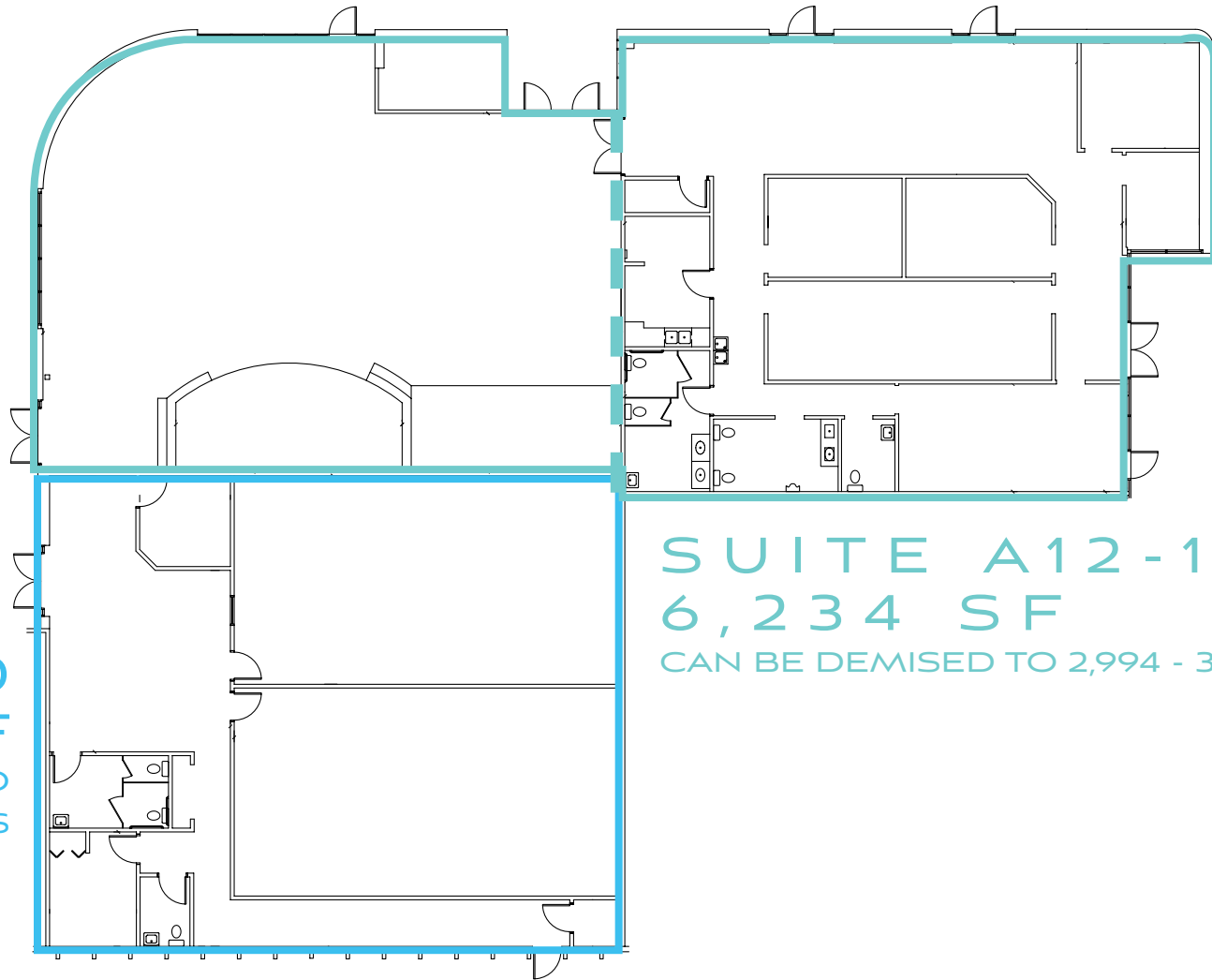

**SUITE A10**  
**3,454 SF**  
FORMER DANCE STUDIO  
WITH SPRUNG FLOORS

**SUITE A12-13**  
**6,234 SF**  
CAN BE DEMISED TO 2,994 - 3,240 SF

	1 Mile	3 Miles	5 Miles
Population	10,318	72,946	245,405
Average Household Income	\$128,070	\$114,674	\$112,400
Daytime Population	3,239	32,930	88,810

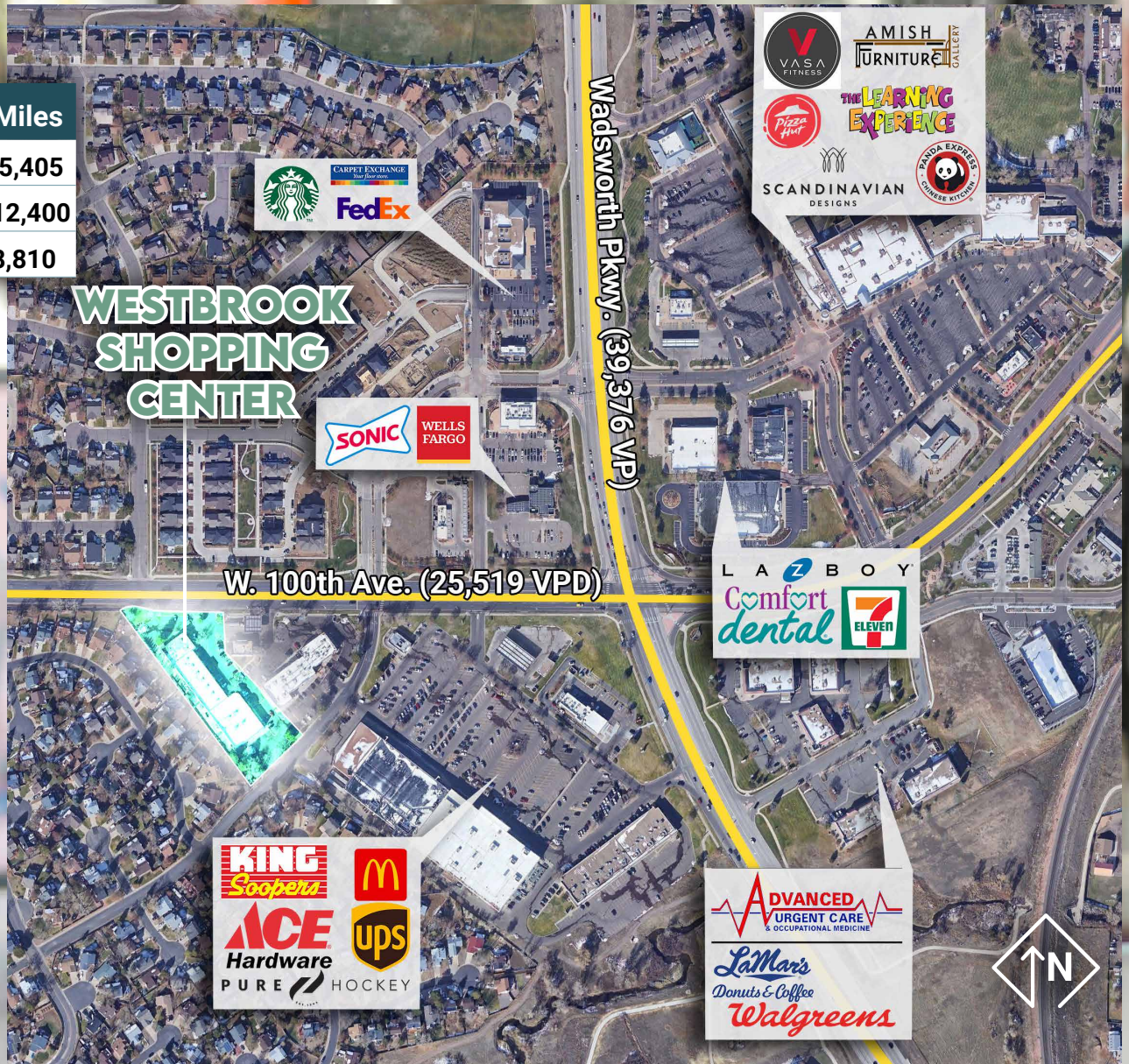

**KINSEY & COMPANY**  
COMMERCIAL REAL ESTATE

**Jason F. Kinsey**  
Managing Principal  
720-280-5757  
Jason@KinseyCRE.com

**Brady Kinsey**  
Principal  
303-847-1295  
Brady@KinseyCRE.com

Disclaimer: The Interested Party acknowledges that any documents or information ("Materials") received from the Property Owner are provided solely for reference and review. The Property Owner makes no representations, expressed or implied, regarding the accuracy or completeness of these Materials. The Interested Party assumes full responsibility for evaluating all provided documents, which may include maps, schematics, and other property-related data. This includes, but is not limited to: (i) the structural integrity, condition, and features of the Property, including roofing, foundation, utilities, and landscaping; (ii) soil composition, geological factors, and groundwater conditions; (iii) the availability and adequacy of utility services; (iv) zoning, land use regulations, and development feasibility; (v) legal restrictions affecting the Property; (vi) adherence to applicable laws, codes, and regulations; (vii) potential environmental hazards on or near the premises; (viii) the quality of workmanship and materials in any existing structures; and (ix) the status of the Property's title. The Property Owner is not responsible for any conclusions drawn by the Interested Party based on these Materials. It is the sole duty of the Interested Party to conduct independent due diligence before finalizing any transaction. All documents are provided without warranty, and the Interested Party waives any claims against the Listing Agent and Property Owner regarding the accuracy or reliability of the information furnished. Jason F. Kinsey and Brady Kinsey are licensed real estate brokers and have ownership interest in this property.