

Soils Map

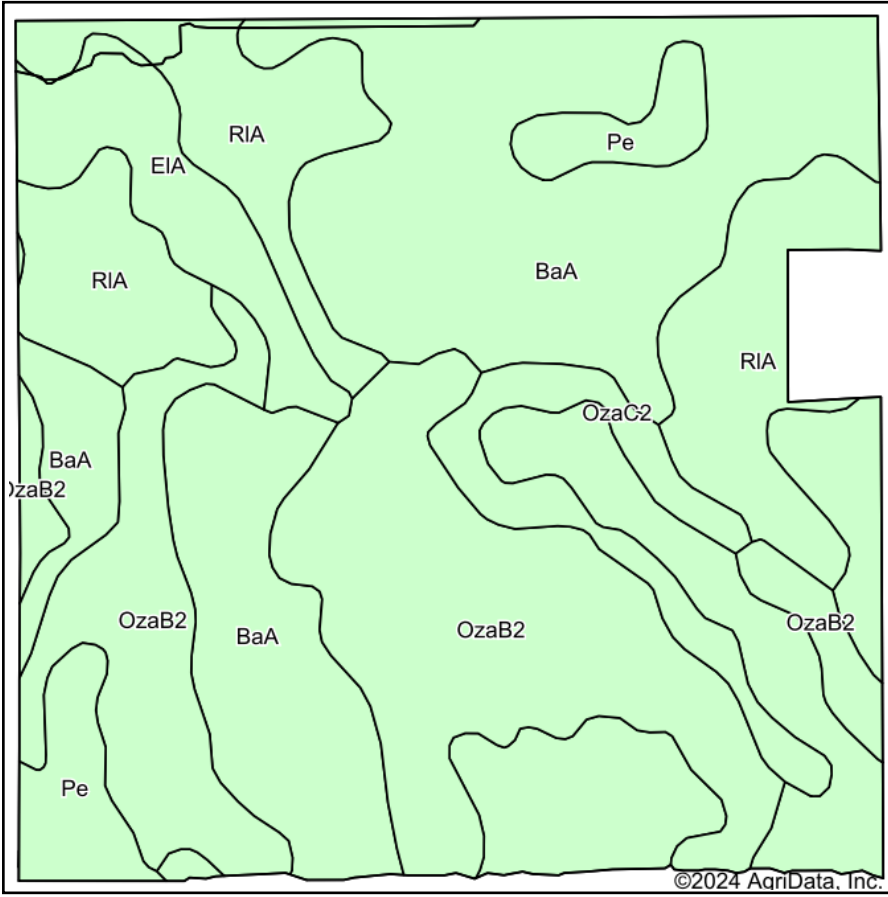

Soils data provided by USDA and NRCS.

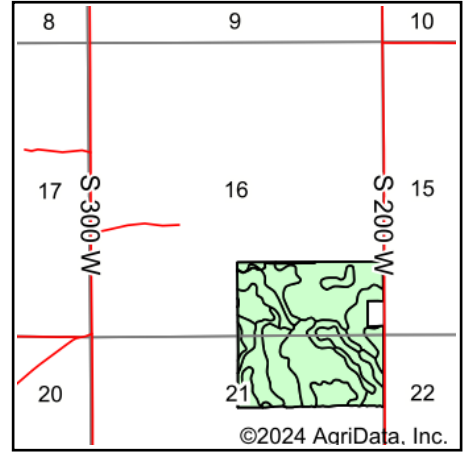

State: **Indiana**
 County: **Porter**
 Location: **21-34N-6W**
 Township: **Porter**
 Acres: **158.06**
 Date: **7/22/2024**

Maps Provided By:



© AgriData, Inc. 2023

www.AgriDataInc.com



Area Symbol: IN127, Soil Area Version: 27

Code	Soil Description	Acres	Percent of field	Non-Irr Class *c	Alfalfa hay Tons	Corn Bu	Corn silage Tons	Grass legume hay Tons	Grass legume pasture AUM	Kentucky bluegrass AUM	Oats Bu	Pasture AUM	Soybeans Bu	Winter wheat Bu	*n NCCPI Soybeans
BaA	Blount silt loam, Lake Michigan Lobe, 0 to 2 percent slopes	61.17	38.7%	IIw		124		4	6		59		42	51	59
OzaB2	Ozaukee silt loam, 2 to 6 percent slopes, eroded	40.81	25.8%	IIe		127	20	4	8	4	67		39	50	46
RIA	Riddles silt loam, 0 to 2 percent slopes	25.29	16.0%	I		131		5				9	46	66	67
Wh	Washtenaw silt loam	8.95	5.7%	IIw		165		5				11	49	66	76
EIA	Elliott silt loam, 0 to 2 percent slopes	7.93	5.0%	IIs		147	25	4	7		76		48	59	61
OzaC2	Ozaukee silt loam, 6 to 12 percent slopes, eroded	7.01	4.4%	IIIe	4	117	20	3	5	4	62		36	47	41

Soils data provided by USDA and NRCS.



Code	Soil Description	Acres	Percent of field	Non-Irr Class *c	Alfalfa hay Tons	Corn Bu	Corn silage Tons	Grass legume hay Tons	Grass legume pasture AUM	Kentucky bluegrass AUM	Oats Bu	Pasture AUM	Soybeans Bu	Winter wheat Bu	*n NCCPI Soybeans
Pe	Pewamo silty clay loam	6.90	4.4%	Ilw		160		5				11	44	64	64
Weighted Average				1.88	0.2	130.6	7.3	4.2	5	1.2	46.7	2.5	42.4	54.8	*n 57.4

*n: The aggregation method is "Weighted Average using all components"

*c: Using Capabilities Class Dominant Condition Aggregation Method