

# KEARNY MESA COMPLEX

8833 COMPLEX DRIVE • SAN DIEGO, CA 92123

FOR LEASE



11,852 SF LIGHT INDUSTRIAL FOR LEASE

**JON BOLAND**, Senior Vice President  
858.458.3312 | [jboland@voitco.com](mailto:jboland@voitco.com)  
Lic. # 00999843

**RANDY LACHANCE**, Senior Vice President  
858.458.3374 | [rlachance@voitco.com](mailto:rlachance@voitco.com)  
Lic. #00969674

**JEFF SALLEN**, Vice President  
858.458.3301 | [jsallen@voitco.com](mailto:jsallen@voitco.com)  
Lic. #01799957

**Voit**

REAL ESTATE SERVICES

4180 La Jolla Village Drive, Suite 100, La Jolla, CA 92037 | 858.453.0505 | 858.408.3976 Fax | Lic #01991785 | [www.voidco.com](http://www.voidco.com)

Licensed as a Broker and Real Estate Broker and Salesperson by the DRE ©2026 Voit Real Estate Services, Inc. All Rights Reserved. The information contained herein has been obtained from sources we deem reliable. While we have no reason to doubt its accuracy, we do not guarantee it.

# KEARNY MESA COMPLEX

8833 COMPLEX DRIVE • SAN DIEGO, CA 92123

FOR LEASE

## PROPERTY FEATURES

- » Use: Light Industrial
- » Approximately 11,852 SF
- » Renovated Offices throughout - 2026 Made Ready for Occupancy
- » 18' Warehouse Clear Height
- » Warehouse Sprinklered
- » Two (2) Grade Level Loading Doors:
  - One (1) 14' x 14'
  - One (1) 12' x 13.4'
- » Panel A - 250 amps of 208-120 volt power (Tenant to Verify)
- » Panel B - 90 amps of 277- 480 volt power (Tenant to Verify)
- » Parking: 1.7/1,000
- » Located on Main Fiber Loop
- » Direct access to Highway 163, 52 and I-15
- » Available Immediately

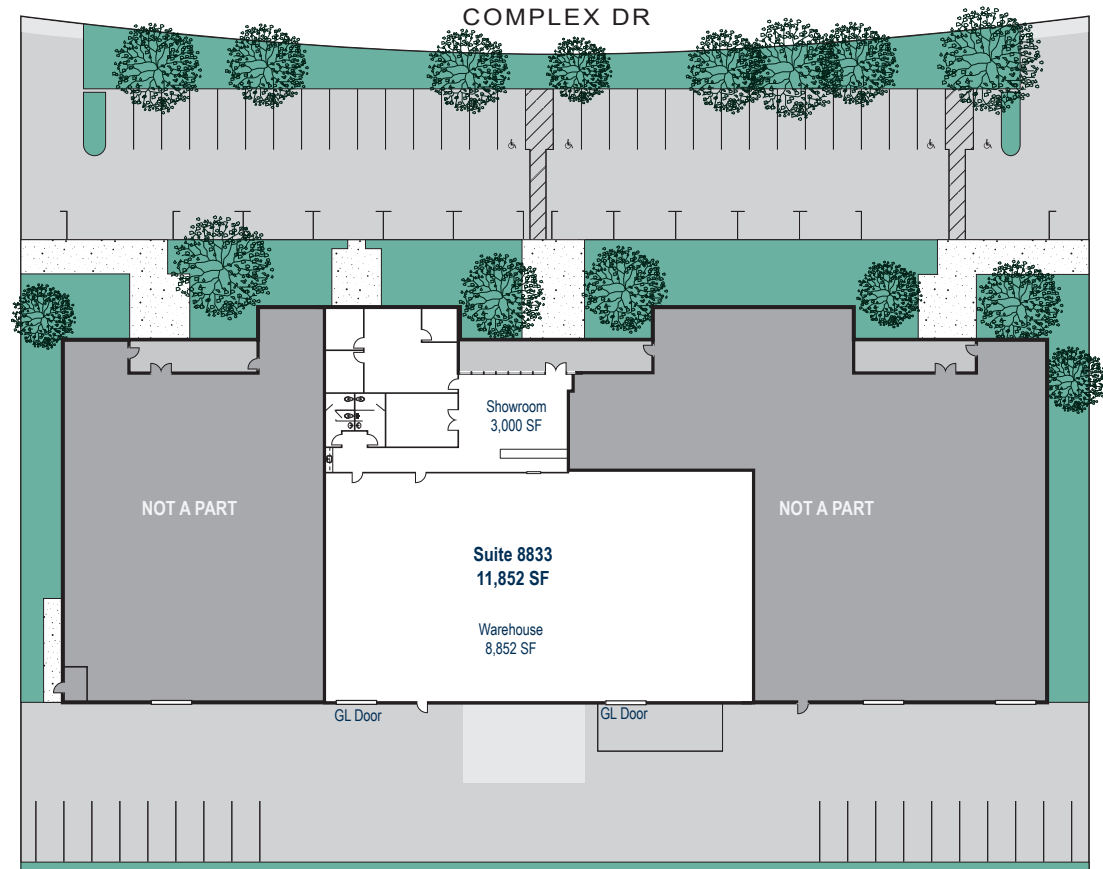

**LEASE RATE: \$2.05/SF/Mo./NNN**  
(NNN= \$0.30 SF/Mo.)

\* CONTACT BROKERS FOR SHOWINGS



# KEARNY MESA COMPLEX

8833 COMPLEX DRIVE • SAN DIEGO, CA 92123

FOR LEASE

## FLOOR PLAN

11,852 SF



VIEW MATTERPORT  
VIDEO

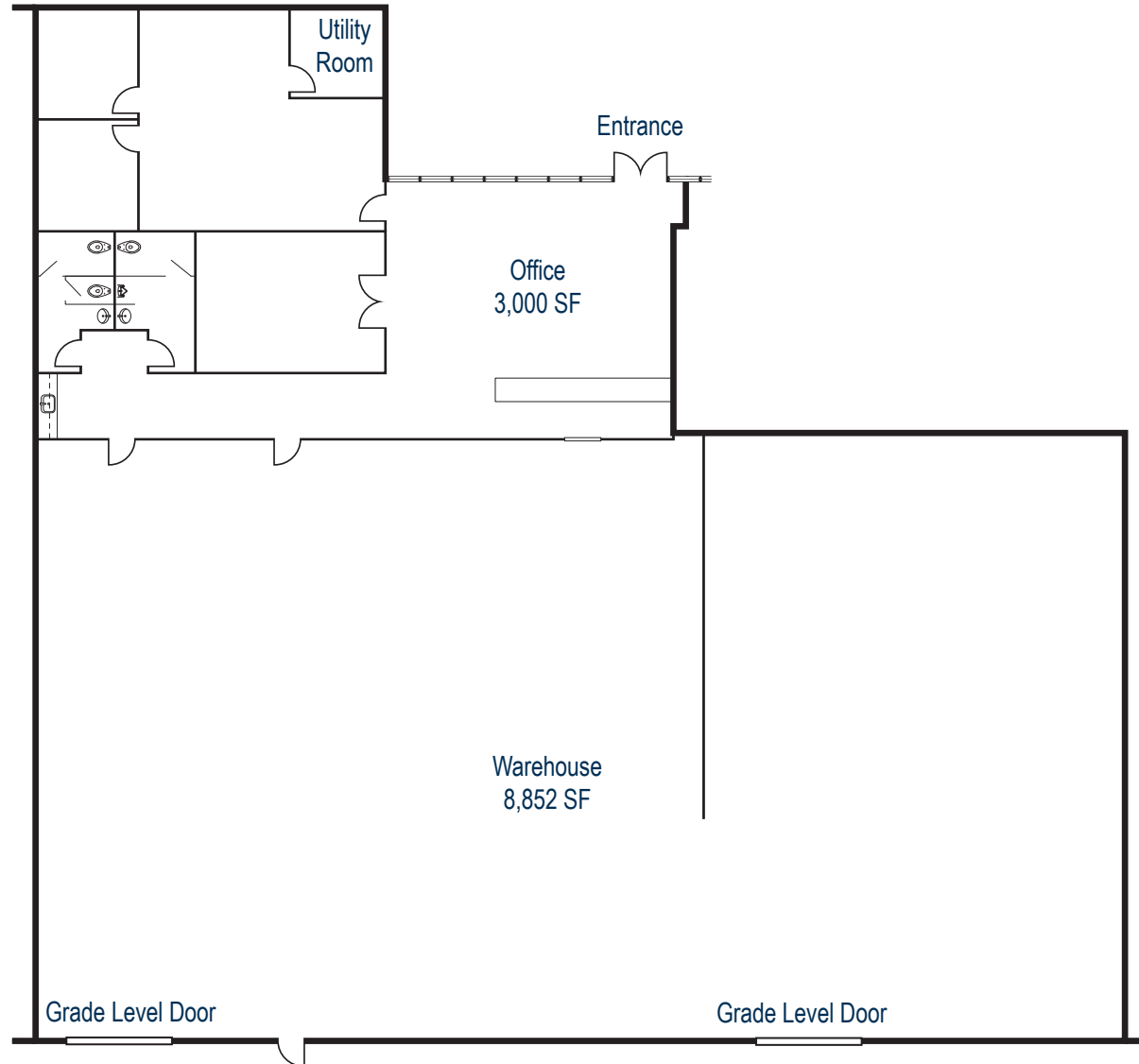

# KEARNY MESA COMPLEX

8833 COMPLEX DRIVE • SAN DIEGO, CA 92123

FOR LEASE

## BUILDING PHOTOS



