

# 110 SHAWMUT

CANTON, MA



**26,450 SF** FLEX/INDUSTRIAL SUBLEASE AVAILABLE

**AVISON  
YOUNG**

# 110 SHAWMUT

**ADDRESS:** 110 Shawmut Road, Canton

**SUBLANDLORD:** WayForth

**REMAINING TERM:** Through December 31, 2026

**SIZE:** 26,450 SF (22,144 SF warehouse;  
2,982 SF office; 1,324 SF mezzanine)

**LOADING:** 4 loading docks with 2 levelers

**CLEAR HEIGHT:** 20' 10"

**PARKING:** 48 uncovered spaces

**OFFICE SPACE:** Kitchenette/café, conference room,  
4 private offices

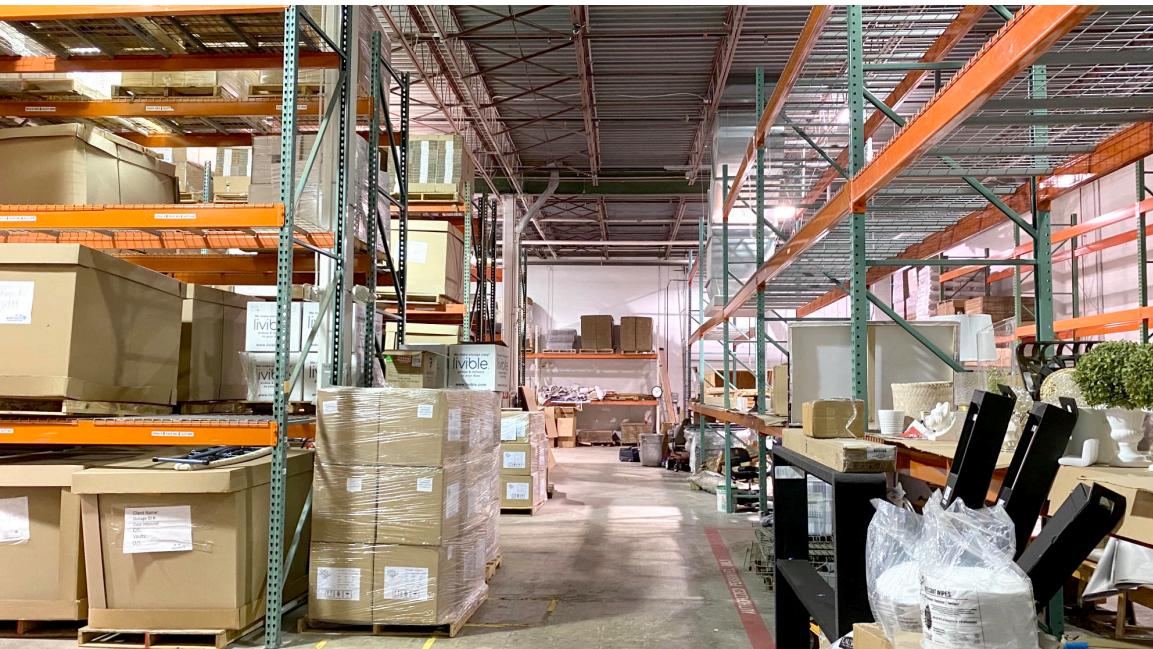



# FLOOR PLAN | 26,450 SF

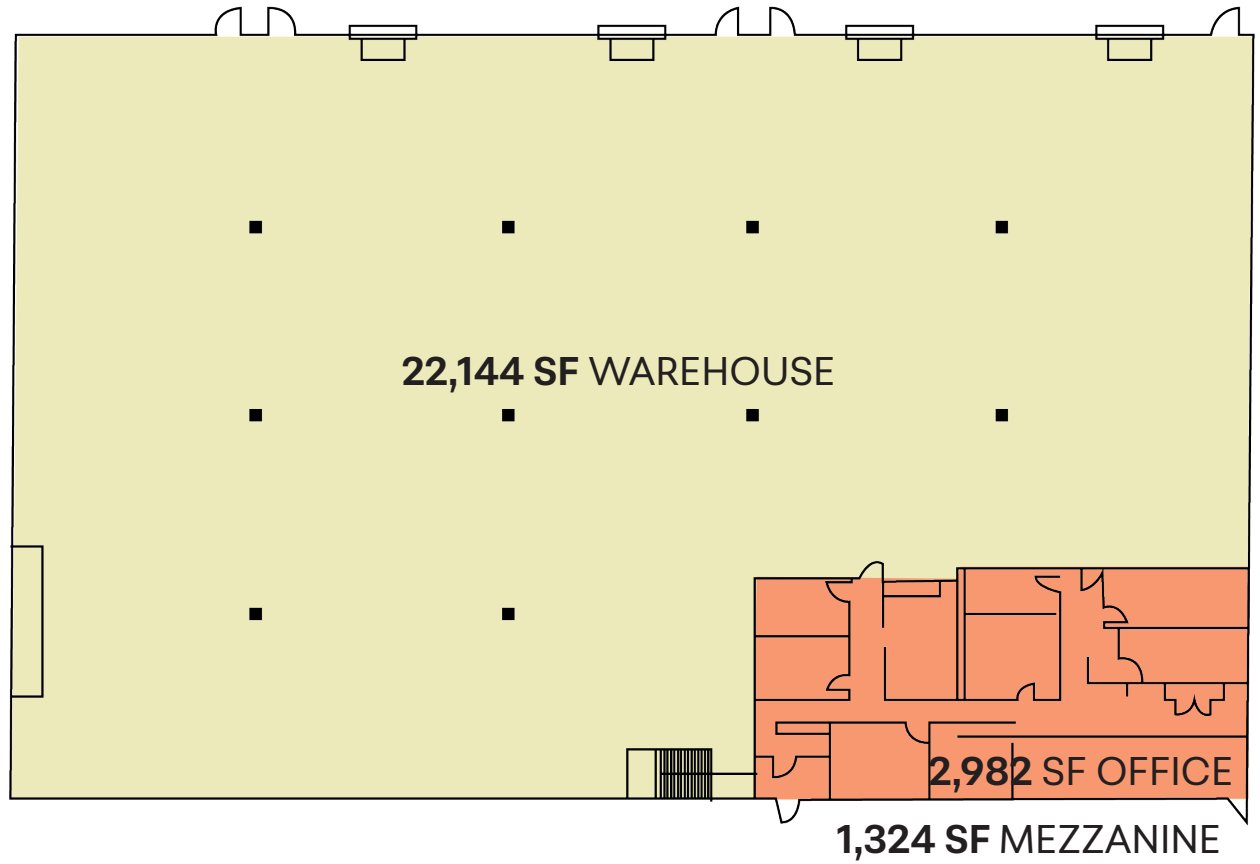

# ACCESS & AMENITIES



# 110 SHAWMUT

CANTON, MA



**JONATHAN PEZZONI**

Senior Vice President  
+1 617 758 8742  
jon.pezzoni@avisonyoung.com

**SAM BACHRACH**

Associate  
+1 617 584 8838  
sam.bachrach@avisonyoung.com