



WA/ID Stateline Approx. 10.22 AC RV Resort Project

- Located just off the I-90 Freeway at the WA/ID Stateline
- Strategic Location – centrally located between WA and ID
- Fully entitled and master planned
- 77 RV parking stalls planned with possibility to get up to 100 stalls
- Proposed 4-5,000 sf clubhouse, dog park, and picnic overlook to the river

Sale Price - \$4,400,000

Broker contact:

Steve Ridenour

+1 208 660 5010

sridenour@naiblack.com

KC Reese

+1 208 755 7629

kc.reese@naiblack.com

NO WARRANTY OR REPRESENTATION, EXPRESS OR IMPLIED, IS MADE AS TO THE ACCURACY OF THE INFORMATION CONTAINED HEREIN, AND THE SAME IS SUBMITTED SUBJECT TO ERRORS, OMISSIONS, CHANGE OF PRICE, RENTAL OR OTHER CONDITIONS, PRIOR SALE, LEASE OR FINANCING, OR WITHDRAWAL WITHOUT NOTICE, AND OF ANY SPECIAL LISTING CONDITIONS IMPOSED BY OUR PRINCIPALS NO WARRANTIES OR REPRESENTATIONS ARE MADE AS TO THE CONDITION OF THE PROPERTY OR ANY HAZARDS CONTAINED THEREIN ARE ANY TO BE IMPLIED.

105 N 1st St., Ste 300,
Coeur d'Alene, ID 83814

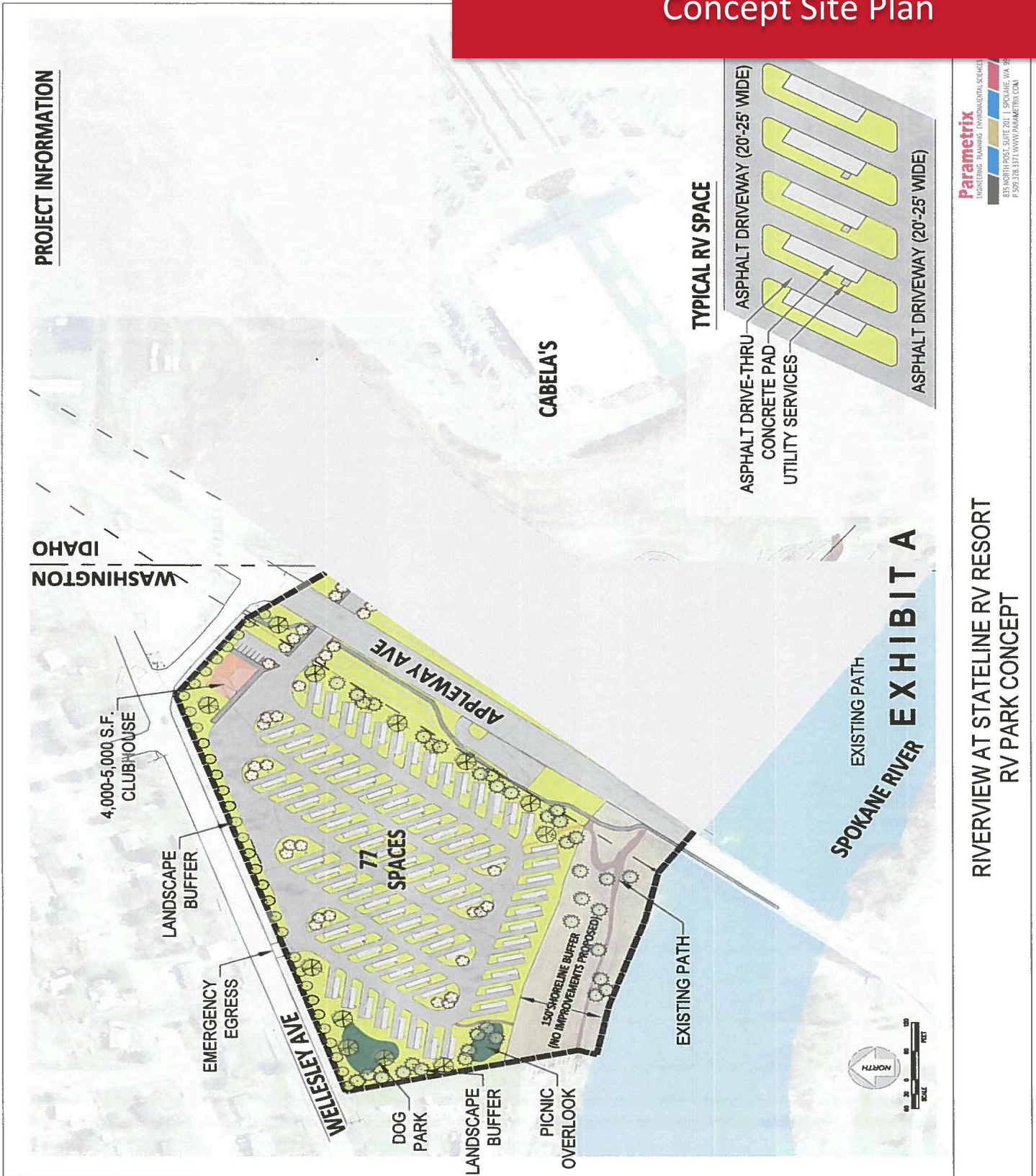

NO WARRANTY OR REPRESENTATION, EXPRESS OR IMPLIED, IS MADE AS TO THE ACCURACY OF THE INFORMATION CONTAINED HEREIN, AND THE SAME IS SUBMITTED SUBJECT TO ERRORS, OMISSIONS, CHANGE OF PRICE, RENTAL OR OTHER CONDITIONS, PRIOR SALE, LEASE OR FINANCING, OR WITHDRAWAL WITHOUT NOTICE, AND OF ANY SPECIAL LISTING CONDITIONS IMPOSED BY OUR PRINCIPALS. NO WARRANTIES OR REPRESENTATIONS ARE MADE AS TO THE CONDITION OF THE PROPERTY OR ANY HAZARDS CONTAINED THEREIN ARE ANY TO BE IMPLIED.

Broker contact:

Steve Ridenour

+1 208 660 5010

sridenour@naiblack.com

KC Reese

+1 208 755 7629

kc.reese@naiblack.com