

FUTURE BUILDING 'F'
 AUTO SERVICE MULTI-TENANT
 = 8,050 SF

PAD B UNIT 110	3040	BONANZA	VACANT	1,334 SF
PAD B UNIT 120	3040	BONANZA	VACANT	1,930 SF
TOTAL				3,264 SF

PAD C UNIT 110	3060	BONANZA	VACANT	3,140 SF
TOTAL				3,140 SF

PAD D UNIT 110-130	3020	BONANZA	BANQUET HALL	5,160 SF
PAD D UNIT 140	3020	BONANZA	HERBALIFE	918 SF
PAD D UNIT 150	3020	BONANZA	STORE	2,106 SF
PAD D UNIT 160-190	3020	BONANZA	ADULT DAY CARE	6,565 SF
PAD D UNIT 195	3020	BONANZA	VACANT	1,666 SF
TOTAL				16,415 SF

PAD E UNIT 110-120	3050	BONANZA	APEX MEDICAL	3,463 SF
PAD E UNIT 130	3050	BONANZA	PEDIATRICS	1,755 SF
PAD E UNIT 140	3050	BONANZA	PEDIATRICS	1,300 SF
PAD E UNIT 150	3050	BONANZA	STATE FARM	1,200 SF
PAD E UNIT 160	3050	BONANZA	BELMONT PHARMACY	1,495 SF
PAD E UNIT 170	3050	BONANZA	VACANT	1,100 SF
PAD E UNIT 180-195	3050	BONANZA	L.P. AUTO BUSES	4,500 SF
TOTAL				14,813 SF

PAD A UNIT 110	3010	BONANZA	FUTURE	3,264 SF
PAD F BUILDING	3030	BONANZA	FUTURE	8,050 SF

TOTAL SHOPPING CENTER 48,946 SF

FUTURE MANNING STREET

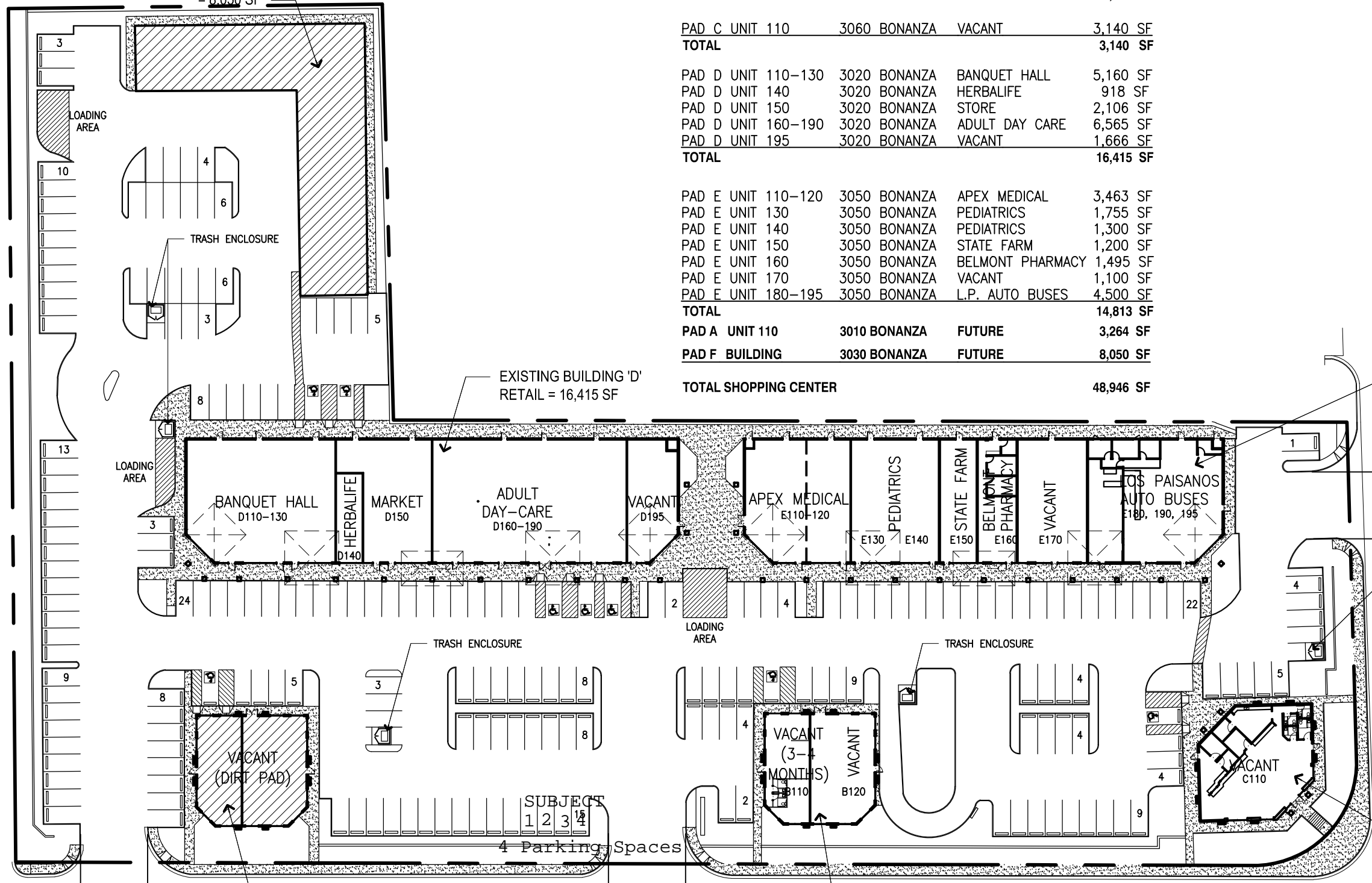

EXISTING BUILDING 'D'
 RETAIL = 16,415 SF

EXISTING BUILDING 'E'
 RETAIL = 14,683 SF

FUTURE BUILDING 'A'
 RETAIL = 3,264 SF

EXISTING BUILDING 'B'
 RETAIL = 3,264 SF

EXISTING BUILDING 'C'
 RETAIL = 3,140 SF

BONANZA/MOJAVE RETAIL CENTER

3050 E. BONANZA RD., LAS VEGAS, NV 89101

SITE PLAN

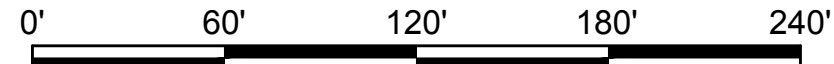

3585 W. DIABLO DRIVE, #1
 LAS VEGAS, NV 89118
 (702) 737-0390