

34 E

MONTECITO ST

SANTA BARBARA, CA

FOR LEASE PRIME RETAIL, RESTAURANT, OR COFFEE LOCATION
IN THE FUNK ZONE WITH AMPLE OUTDOOR AREA AND
EXCELLENT FREEWAY VISIBILITY

Colliers



HIGHLIGHTS

This highly visible property offers a unique opportunity for a restaurant, retailer, coffee, or boutique space in Santa Barbara's thriving Funk Zone District. Surrounded by popular hotels, restaurants, tasting rooms, and boutiques, the property is ideal for a tenant seeking excellent visibility, outdoor space, foot traffic, and creative atmosphere.

- ▶ Prime location in Santa Barbara's vibrant Funk Zone
- ▶ Excellent freeway visibility for maximum exposure
- ▶ Potential for outdoor seating to enhance customer experience

LEASE RATE	Contact Listing Agents
------------	------------------------

BUILDING SIZE	±1,184 SF + Large outdoor patio
---------------	---------------------------------

PARKING	±15 on-site spaces
---------	--------------------

ZONING	OC/HRC-2/S-D-3
--------	----------------

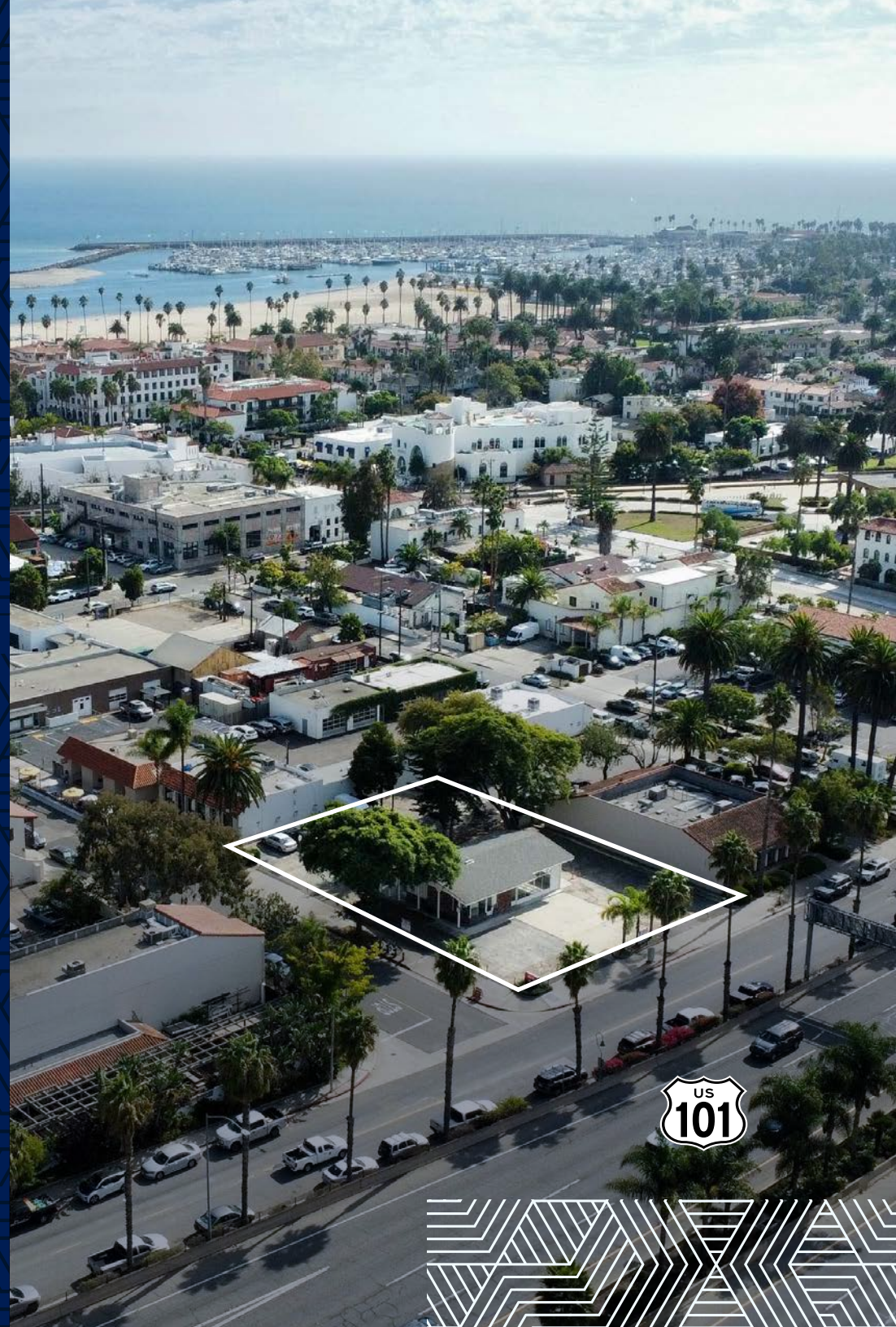

FLOOR PLANS

34 E
MONTECITO ST
SANTA BARBARA, CA

OPTION A

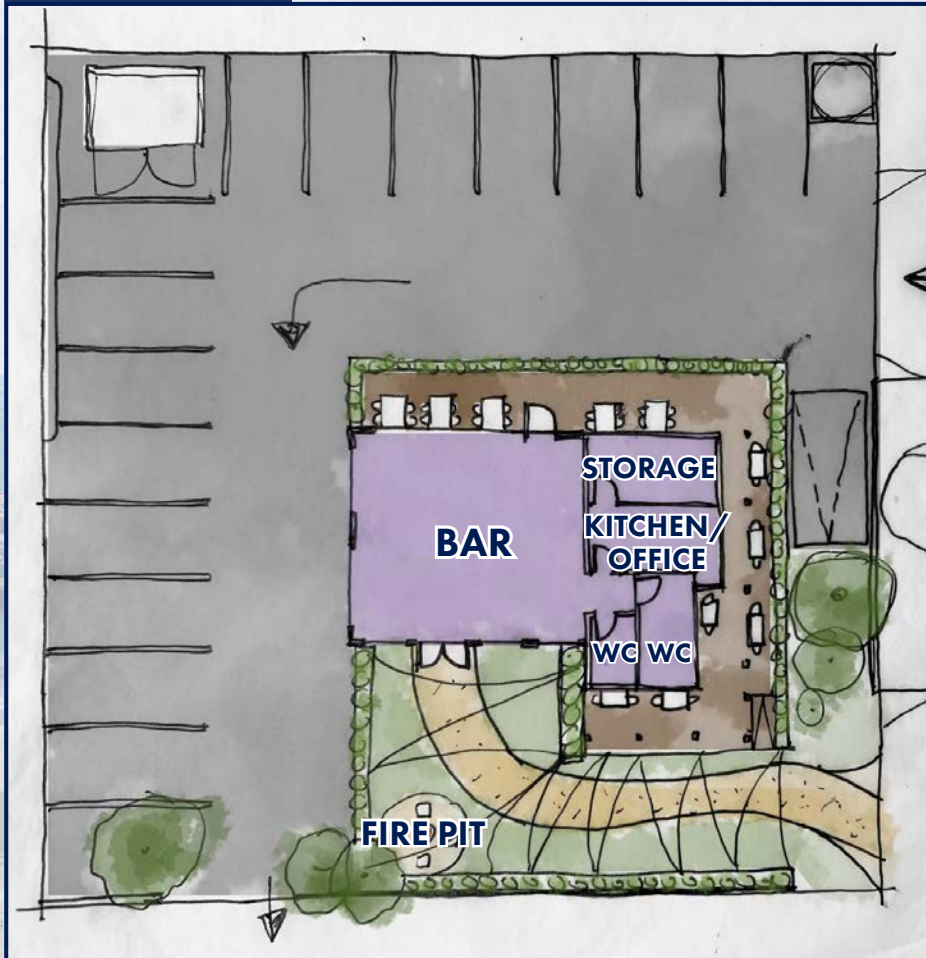

OPTION B

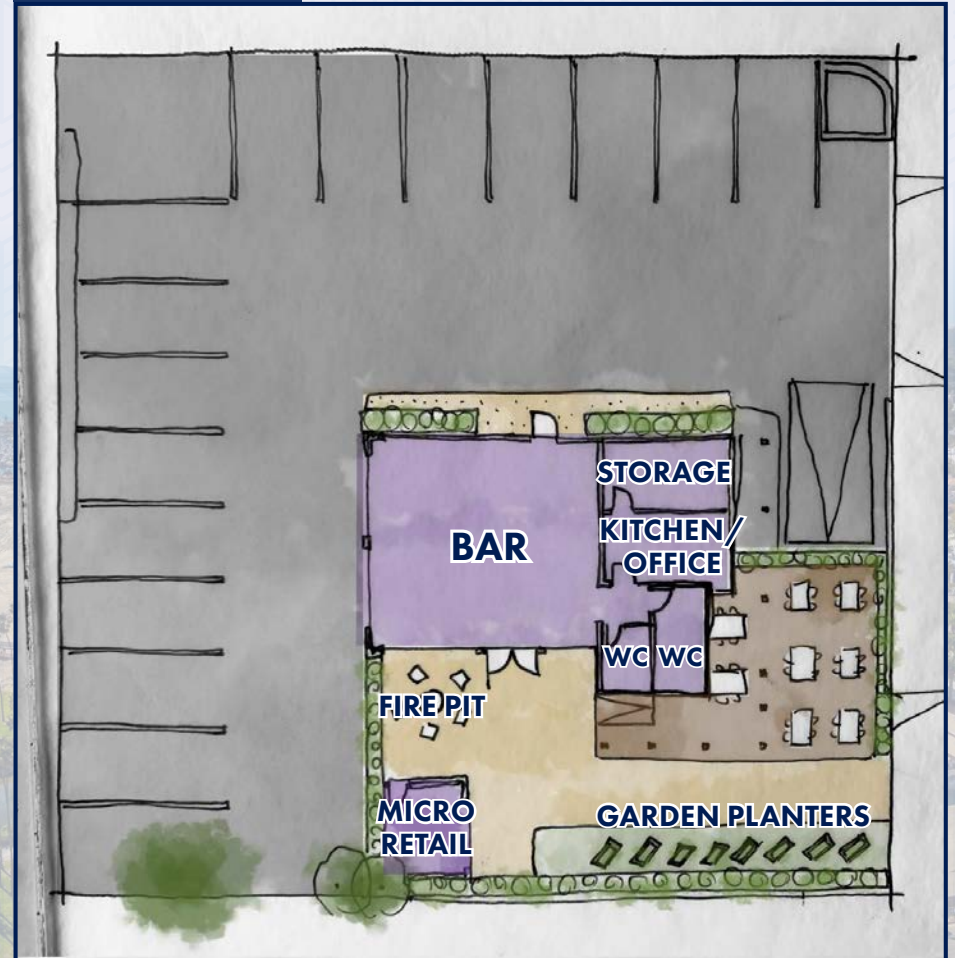

SITE RENDERINGS

34 E
MONTECITO ST
SANTA BARBARA, CA



PROPERTY PHOTOS

34 E
MONTECITO ST
SANTA BARBARA, CA

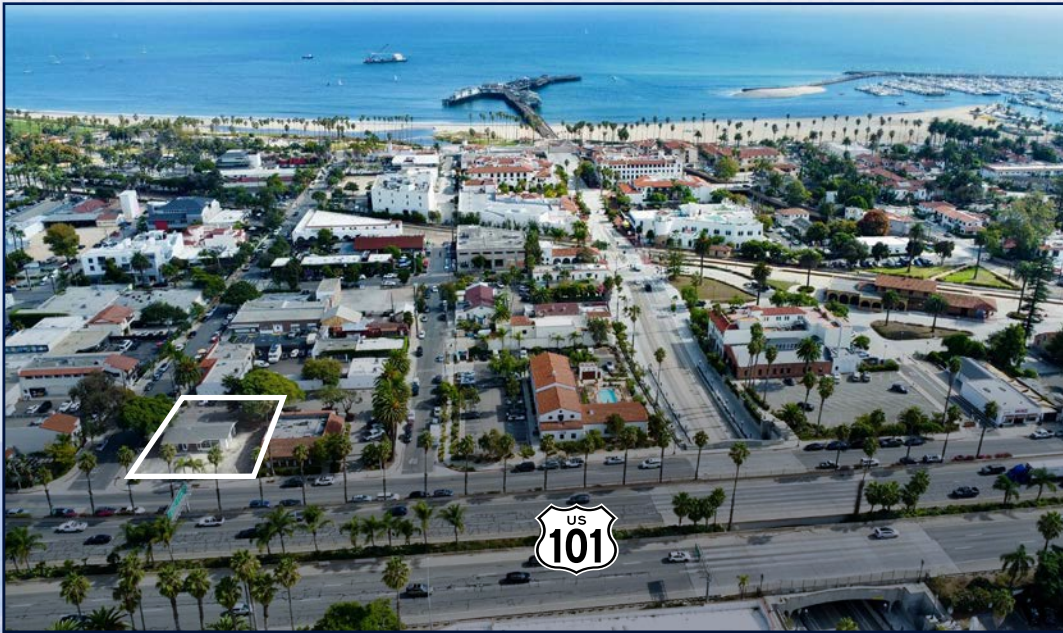

FUNK ZONE AMENITIES

34 E
MONTECITO ST
SANTA BARBARA, CA

1

sbmidmod
TENDREL



studio121 |



EXPLORE
Fess Parker



THE
SHOPKEEPERS
RAOUL TEXTILES

HELENA
AVENUE
BAKERY

PEARL SOCIAL
COCKTAIL CLUB

SANTA BARBARA
WINE COLLECTIVE



KELLY CLAUSE
FINE ART

MARY TATTOO



SEAVEES



J.WILKES

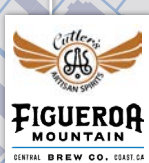

FIGUEROA
MOUNTAIN
CENTRAL BREW CO. COAST CA



SANTA BARBARA
PACIFIC
SURFLINER

Riviera
BEACH HOUSE



EST. 2014
THE BLUE DOOR
SANTA BARBARA, CA

Loguita



Sivers
OMAKASE



EXPLORE
Fess Parker



THE
SHOPKEEPERS
RAOUL TEXTILES

HELENA
AVENUE
BAKERY

PEARL SOCIAL
COCKTAIL CLUB

SANTA BARBARA
WINE COLLECTIVE



KELLY CLAUSE
FINE ART

MARY TATTOO



SEAVEES



J.WILKES

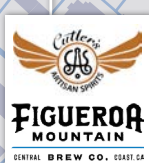

FIGUEROA
MOUNTAIN
CENTRAL BREW CO. COAST CA



SANTA BARBARA
PACIFIC
SURFLINER

Riviera
BEACH HOUSE



EST. 2014
THE BLUE DOOR
SANTA BARBARA, CA

Loguita

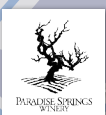

Sivers
OMAKASE



EXPLORE
Fess Parker

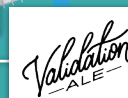

THE
SHOPKEEPERS
RAOUL TEXTILES

HELENA
AVENUE
BAKERY

PEARL SOCIAL
COCKTAIL CLUB

SANTA BARBARA
WINE COLLECTIVE



KELLY CLAUSE
FINE ART

MARY TATTOO



SEAVEES



J.WILKES

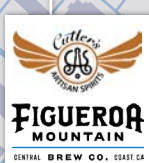

FIGUEROA
MOUNTAIN
CENTRAL BREW CO. COAST CA



SANTA BARBARA
PACIFIC
SURFLINER

Riviera
BEACH HOUSE



EST. 2014
THE BLUE DOOR
SANTA BARBARA, CA

Loguita

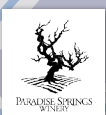

Sivers
OMAKASE



EXPLORE
Fess Parker

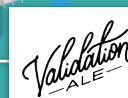

THE
SHOPKEEPERS
RAOUL TEXTILES

HELENA
AVENUE
BAKERY

PEARL SOCIAL
COCKTAIL CLUB

SANTA BARBARA
WINE COLLECTIVE



KELLY CLAUSE
FINE ART

MARY TATTOO



SEAVEES



J.WILKES

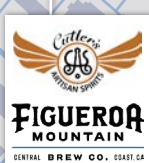

FIGUEROA
MOUNTAIN
CENTRAL BREW CO. COAST CA



SANTA BARBARA
PACIFIC
SURFLINER

Riviera
BEACH HOUSE



EST. 2014
THE BLUE DOOR
SANTA BARBARA, CA

Loguita

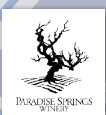

Sivers
OMAKASE



EXPLORE
Fess Parker

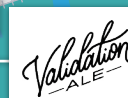

THE
SHOPKEEPERS
RAOUL TEXTILES

HELENA
AVENUE
BAKERY

PEARL SOCIAL
COCKTAIL CLUB

SANTA BARBARA
WINE COLLECTIVE



KELLY CLAUSE
FINE ART

MARY TATTOO



SEAVEES



J.WILKES

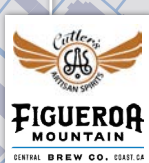

FIGUEROA
MOUNTAIN
CENTRAL BREW CO. COAST CA



SANTA BARBARA
PACIFIC
SURFLINER

Riviera
BEACH HOUSE



EST. 2014
THE BLUE DOOR
SANTA BARBARA, CA

Loguita

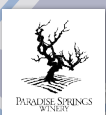

Sivers
OMAKASE



EXPLORE
Fess Parker



THE
SHOPKEEPERS
RAOUL TEXTILES

HELENA
AVENUE
BAKERY

PEARL SOCIAL
COCKTAIL CLUB

SANTA BARBARA
WINE COLLECTIVE



KELLY CLAUSE
FINE ART

MARY TATTOO



SEAVEES



J.WILKES

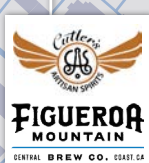

FIGUEROA
MOUNTAIN
CENTRAL BREW CO. COAST CA



SANTA BARBARA
PACIFIC
SURFLINER

Riviera
BEACH HOUSE



EST. 2014
THE BLUE DOOR
SANTA BARBARA, CA

Loguita

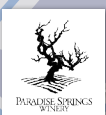

Sivers
OMAKASE



EXPLORE
Fess Parker

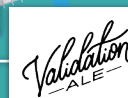

THE
SHOPKEEPERS
RAOUL TEXTILES

HELENA
AVENUE
BAKERY

PEARL SOCIAL
COCKTAIL CLUB

SANTA BARBARA
WINE COLLECTIVE



KELLY CLAUSE
FINE ART

MARY TATTOO



SEAVEES



J.WILKES

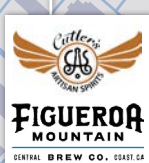

FIGUEROA
MOUNTAIN
CENTRAL BREW CO. COAST CA



SANTA BARBARA
PACIFIC
SURFLINER

Riviera
BEACH HOUSE



EST. 2014
THE BLUE DOOR
SANTA BARBARA, CA

Loguita



Sivers
OMAKASE



EXPLORE
Fess Parker

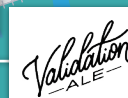

THE
SHOPKEEPERS
RAOUL TEXTILES

HELENA
AVENUE
BAKERY

PEARL SOCIAL
COCKTAIL CLUB

SANTA BARBARA
WINE COLLECTIVE



KELLY CLAUSE
FINE ART

MARY TATTOO



SEAVEES



J.WILKES

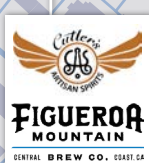

FIGUEROA
MOUNTAIN
CENTRAL BREW CO. COAST CA



SANTA BARBARA
PACIFIC
SURFLINER

Riviera
BEACH HOUSE



EST. 2014
THE BLUE DOOR
SANTA BARBARA, CA

Loguita

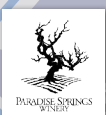

Sivers
OMAKASE



EXPLORE
Fess Parker



THE
SHOPKEEPERS
RAOUL TEXTILES

HELENA
AVENUE
BAKERY

PEARL SOCIAL
COCKTAIL CLUB

SANTA BARBARA
WINE COLLECTIVE



KELLY CLAUSE
FINE ART

MARY TATTOO



SEAVEES



J.WILKES

FUNK ZONE

Santa Barbara's Creative District

LOCATION & LEGACY

The Funk Zone is a compact, walkable neighborhood nestled between the Pacific Ocean and Highway 101 in Santa Barbara. Historically an industrial and maritime zone, it has evolved into a vibrant mixed-use district blending art, food, drink, and creative retail.

WHAT MAKES IT UNIQUE

Authentic Industrial Charm: Repurposed warehouses and marine buildings now house galleries, studios, and boutique shops.

Culinary & Tasting Destination: Home to the renowned Urban Wine Trail, plus craft breweries, distilleries, and diverse dining—from street eats to upscale cuisine.

Art & Retail Culture: Murals, galleries, and surf-inspired boutiques create a laid-back, edgy vibe.

Prime Accessibility: Steps from the beach, Amtrak station, and downtown, with high foot traffic and tourist appeal.

THE EXPERIENCE

Visitors enjoy a dynamic mix of beach-town ease and urban energy—from wine tastings and brewery patios to artisan shopping and gallery strolls. The Funk Zone thrives day and night, offering a lively social scene and relaxed daytime charm.

WHY IT WORKS FOR RETAIL

- High visibility and foot traffic from locals and tourists
- Diverse mix of uses keeps the area active throughout the day
- Creative, edgy atmosphere ideal for experiential retail
- Proximity to waterfront and downtown enhances accessibility



GREATER AREA AMENITIES

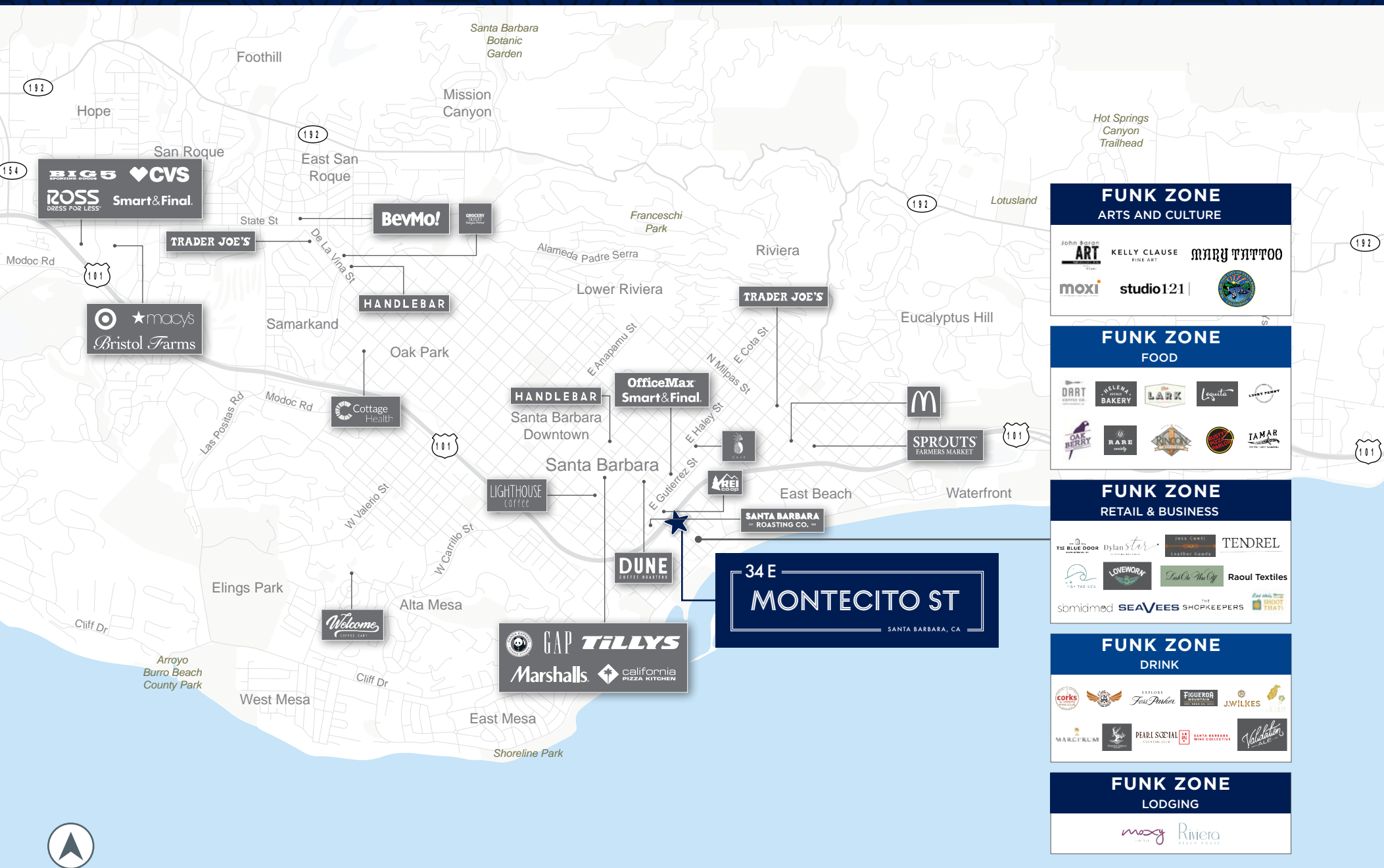

Get In
Touch

MILES WATERS

Vice President

Lic. 02047288

Direct: +1 805 518 1493

miles.waters@colliers.com

AUSTIN HERLIHY

Executive Vice President

Lic. 01518112

Direct: +1 805 518 1491

austin.herlihy@colliers.com

MIKE CHUNG

Associate

Lic. 02156327

Direct: +1 805 518 3254

mike.chung@colliers.com

CHRIS PARKER

Vice President

Lic. 01887788

Direct: +1 805 518 1492

chris.parker@colliers.com

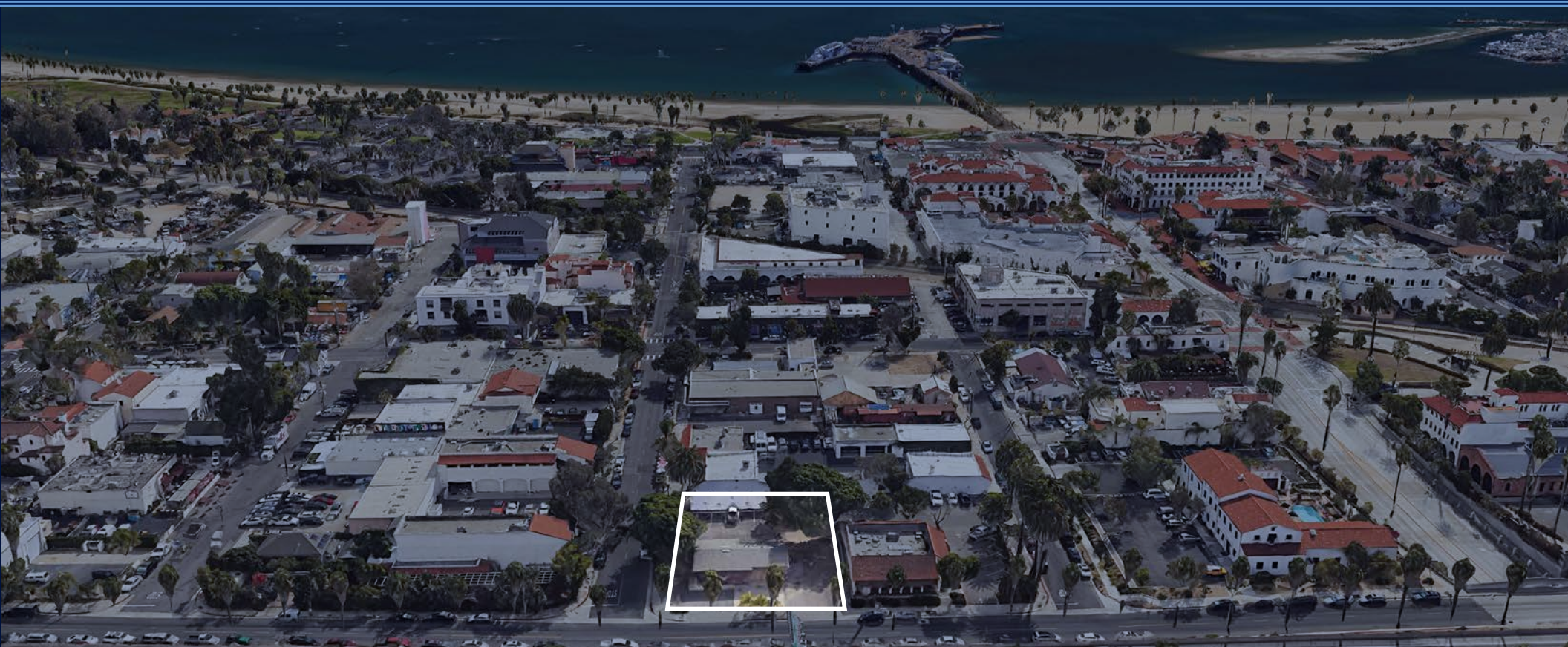

This document/email has been prepared by Colliers for advertising and general information only. Colliers makes no guarantees, representations or warranties of any kind, expressed or implied, regarding the information including, but not limited to, warranties of content, accuracy and reliability. Any interested party should undertake their own inquiries as to the accuracy of the information. Colliers excludes unequivocally all inferred or implied terms, conditions and warranties arising out of this document and excludes all liability for loss and damages arising there from. This publication is the copyrighted property of Colliers and /or its licensor(s). © 2025. All rights reserved. This communication is not intended to cause or induce breach of an existing listing agreement. Colliers International Greater Los Angeles, Inc.

COLLIERS

314 E. Carrillo St, Santa Barbara, CA 93101

colliers.com