



## For Sublease

### Space Available

- Suite 14446: 1,240 sf
- Term: 3/1/26 to 6/30/28
- 2025 CAM: \$2.43 psf and Tax: \$5.23 psf
- Lease Rate: \$18.15 psf NNN

### Contact us:

#### Laura Gill

Associate Vice President  
+1 612 310 5399  
laura.gill@colliers.com

#### Colliers

1600 Utica Avenue S, Suite 300  
St. Louis Park, MN 55416  
P: +1 952 897 7700  
colliers.com/msp

# Glen Lake Village

14400 Excelsior Blvd | Minnetonka, MN 55345

## Grocery Anchored Retail Space

### HIGHLIGHTS and FEATURES

- Neighborhood center anchored by Lunds & Byerly's
- Great visibility and access from Excelsior Blvd
- Located in dense Glen Lake neighborhood
- Parking: 147 spaces
- Building signage
- Co-tenants Glen Lake Wine and Spirits, EZ on the Eyes, Acupressure Sun Spa, and Dragon Jade
- Area Tenants: Unmapped Brewing Company, Pet Stuff, Gina Marias Pizza, Studio 13, State Farm, E-Cig POD, Glen Lake Animal Hospital, BP, Tide Cleaners, Snap Fitness, Glen Lake Academy of Dance, Prestige Preschool Academy, Gold Nugget, Glen Lake Dental, Mobile Hair Proz salon, Health Source, and Gunstop

# Site Plan

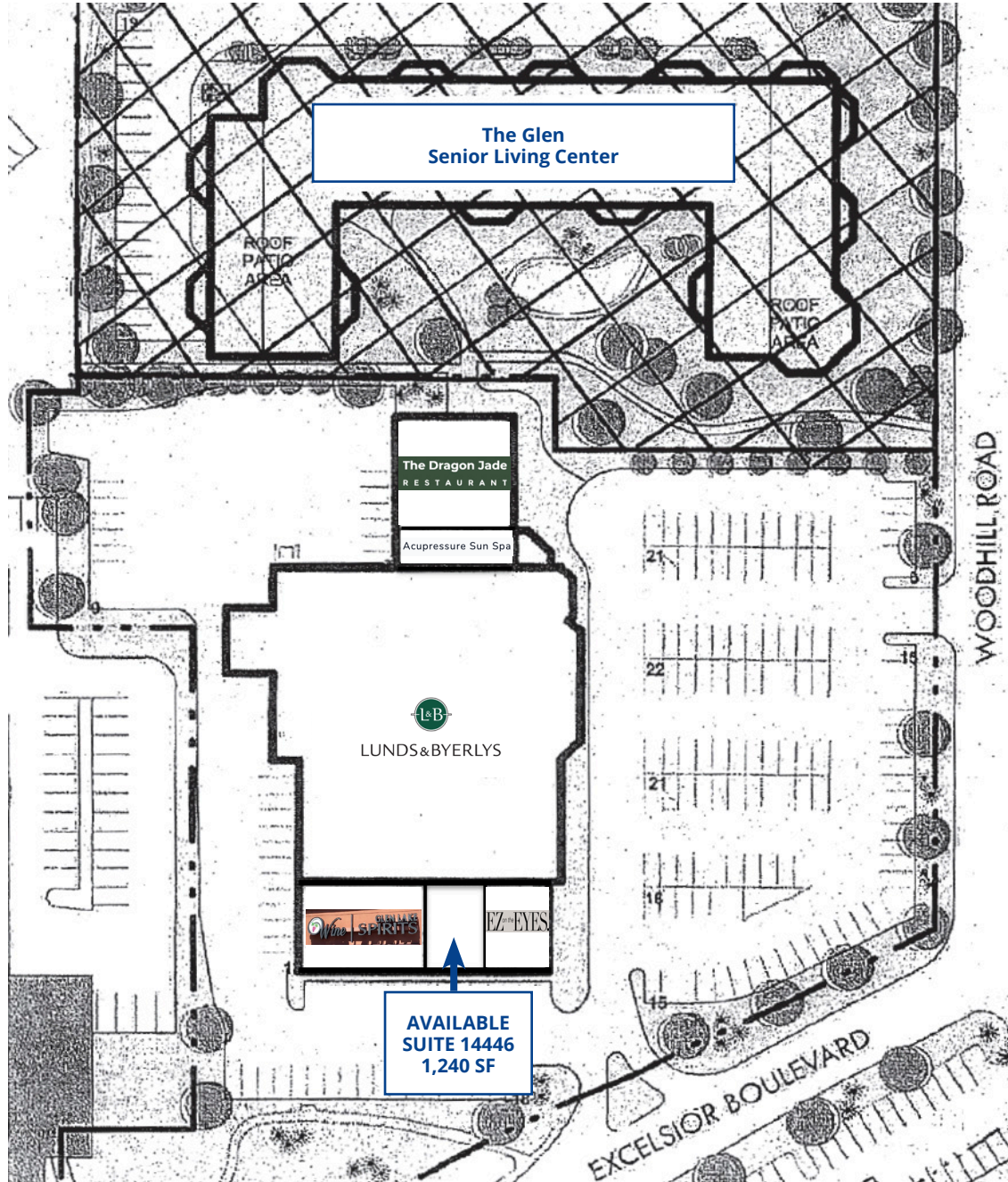

1600 Utica Avenue S, Suite 300  
St. Louis Park, MN 55416  
P: +1 952 897 7700

This document has been prepared by Colliers for advertising and general information only. Colliers makes no guarantees, representations or warranties of any kind, expressed or implied, regarding the information including, but not limited to, warranties of content, accuracy and reliability. Any interested party should undertake their own inquiries as to the accuracy of the information. Colliers excludes unequivocally all inferred or implied terms, conditions and warranties arising out of this document and excludes all liability for loss and damages arising there from. This publication is the copyrighted property of Colliers and /or its licensor(s). © 2025. All rights reserved. This communication is not intended to cause or induce breach of an existing listing agreement.



# Location Overview

## DEMOGRAPHICS

### Average Household Population

1 Mile	6,118
3 Miles	59,682
5 Miles	160,725

### Average Household Income

1 Mile	\$152,758
3 Miles	\$128,617
5 Miles	\$136,643

## TRAFFIC COUNTS

- Excelsior Blvd W - 10,500 vpd
- Excelsior Blvd E - 10,100 vpd
- Eden Prairie Road - 7,300 vpd

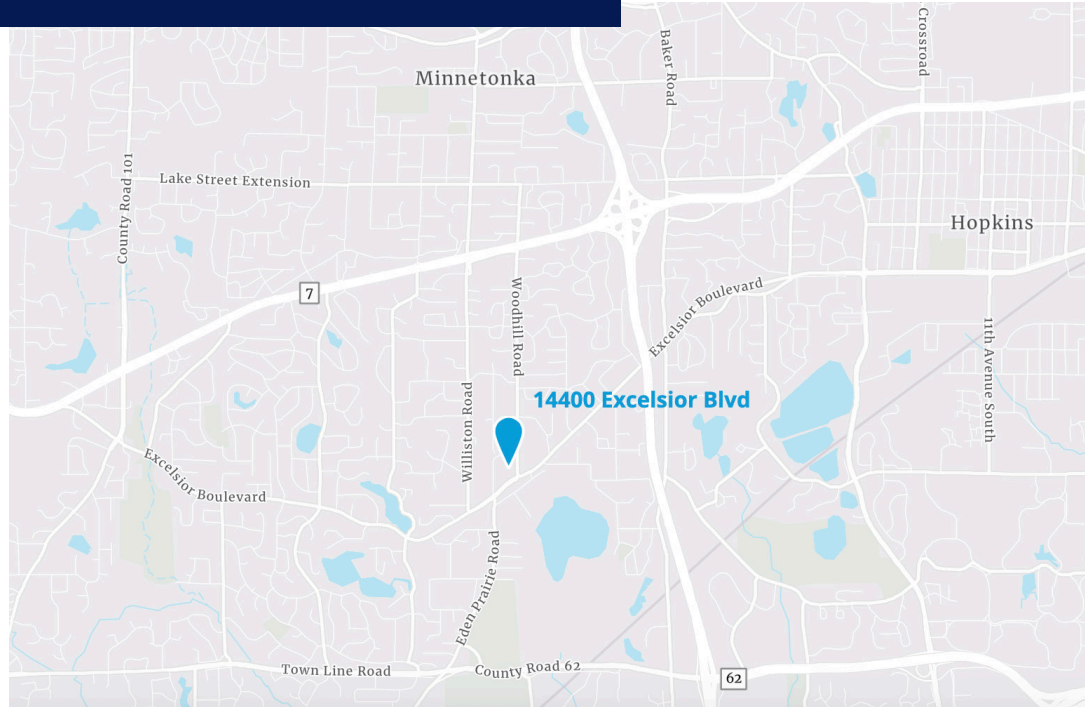

1600 Utica Avenue S, Suite 300  
St. Louis Park, MN 55416  
P: +1 952 897 7700

This document has been prepared by Colliers for advertising and general information only. Colliers makes no guarantees, representations or warranties of any kind, expressed or implied, regarding the information including, but not limited to, warranties of content, accuracy and reliability. Any interested party should undertake their own inquiries as to the accuracy of the information. Colliers excludes unequivocally all inferred or implied terms, conditions and warranties arising out of this document and excludes all liability for loss and damages arising there from. This publication is the copyrighted property of Colliers and /or its licensor(s). © 2025. All rights reserved. This communication is not intended to cause or induce breach of an existing listing agreement.