

4500 Western Blvd.

RALEIGH, NC 27606



NIKITA ZHITOV

919.888.1285

NIKITA@CITYPLAT.COM

PAT MOORE

724.549.5916

PAT@CITYPLAT.COM

VINCENZO VERDINO

917.566.5944

VINCENZO@CITYPLAT.COM

G PATEL

919.656.3327

G@CITYPLAT.COM



Confidentiality Disclaimer

This information has been prepared by City Plat, LLC (together with its affiliates, “City Plat”) solely to determine preliminary investor interest in a real estate development project (the “Project”); it is not an offer or solicitation, and may not be used or relied upon in connection with any offer or solicitation, with respect to the Project or any other future City Plat real estate development project. An offer or solicitation with respect to the Project, if made, will be made only through a confidential summary of terms (the “Term Sheet”) and a related operating agreement and subscription agreement for the Project (collectively, the “Offering Documents”). Investment in the Project will involve significant risks, including risks or loss of the entire investment. The Term Sheet will be available to qualified investors upon request and will contain, among other things, a description of the risks associated with an investment in the Project. Prospective investors should have the financial ability and willingness to accept the risk characteristics associated with the Project.

The information, including the performance data presented herein, is qualified in its entirety by reference to the Term Sheet and the Offering Documents, and all the information presented herein is subject to change without notice to you or any or any other recipient hereof. Some of the information presented herein may constitute “forward-looking information.” Forward-looking information is based on numerous assumptions and is speculative in nature and may vary significantly from actual results. The information is confidential, proprietary and a trade secret of City Plat. By acceptance hereof, you (and your employees and affiliates) agree not to release or reveal it (or any of the information in it) to any third party and, upon request from City Plat, will return or destroy such information and all copies thereof.

Certain performance data contained herein is based on similarly situated investments. There can be no assurance that similar returns will be realized or that actual returns or results will not be materially lower than those stated herein. Certain assumptions have been made to simplify the presentation and, accordingly, actual results may differ, perhaps materially, from those presented.

The information in this presentation is intended to be current only as of the date of this presentation.



Executive Summary

4500 WESTERN BOULEVARD | RALEIGH, NC 27606

CityPlat Capital is excited to present a prime leasing opportunity in one of Raleigh's most sought-after redevelopment sites. The property features a 117,440-square-foot former Kmart building situated on 12.28 acres at the intersection of four major roads leading into and around Raleigh. This location offers exceptional visibility, with over 100,000 vehicles passing by daily (VPDs).

Our strategy involves repositioning the existing 117,440-square-foot structure by subdividing it into 5-7 smaller suites, ranging from 10,000 to 30,000 square feet each. Key improvements will include upgrading the parking lot, enhancing landscaping, repairing the roof, replacing a collapsed stormwater pipe, white boxing the interior spaces, and renovating the building's façade.

This property represents a unique leasing opportunity in a high-demand market.

Inquire for lease rate.

Floor Plan

Total SF | 117,224

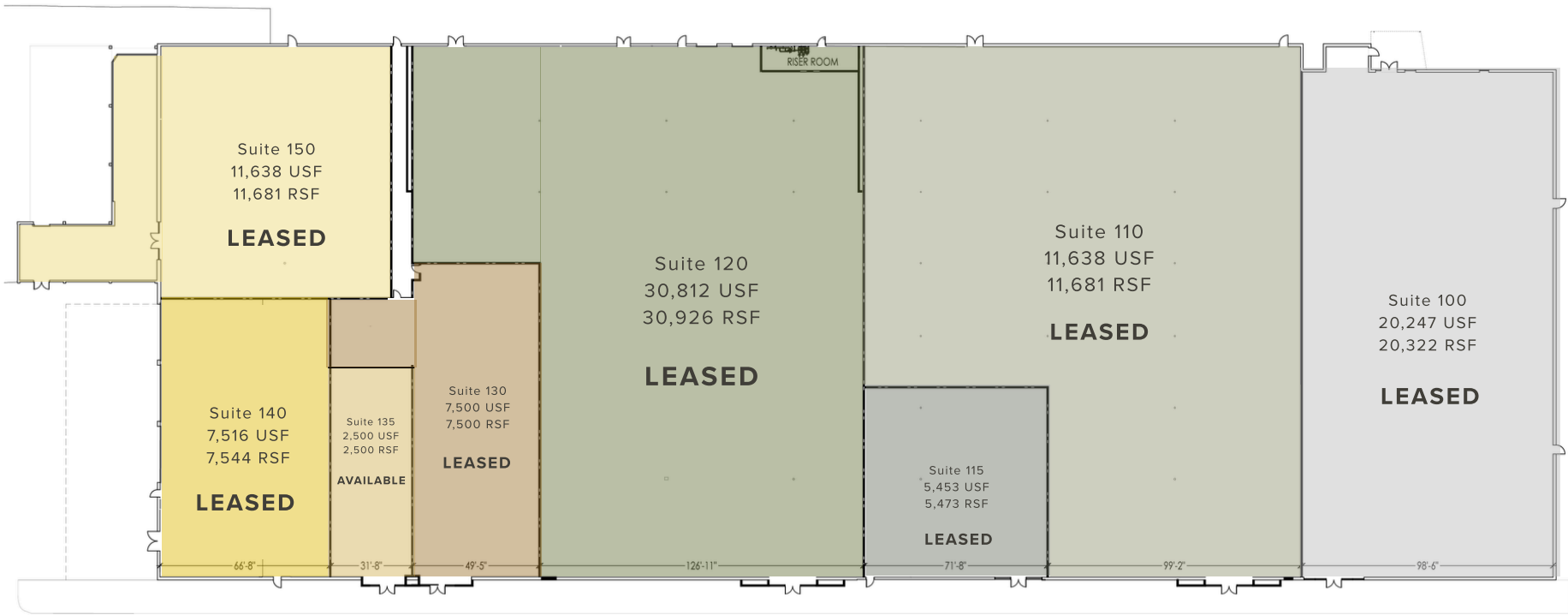

4500 WESTERN BOULEVARD
SUITE PLAN

© 2025 All Rights Reserved.

07/28/2025

A 117,440 square-foot former Kmart building on 12.28 acres of prime real estate, located right off the Beltline in a high-demand area. With excellent visibility and unique positioning, we believe the land's value could reach \$50-100 million over the next decade



*Renderings are for illustrative purposes only.
Final design and plans are subject to change without notice.*



Renderings are for illustrative purposes only.
Final design and plans are subject to change without notice.

COMBINED VEHICLES PER
DAY (VPD) IS OVER 100,000

NC STATE
UNIVERSITY



85,000 VPD

11,500 VPD

35,000 VPD



Market Overview

RALEIGH, NC



Raleigh, North Carolina, is experiencing rapid expansion and is recognized as one of the fastest-growing cities in the United States. The city's robust economy is anchored by its thriving technology, education, and healthcare sectors. As a major hub for innovation, Raleigh is home to Research Triangle Park (RTP), which attracts global tech giants like IBM, Cisco, and Lenovo. The presence of top-tier educational institutions, such as NC State University, contributes to a highly educated workforce, making Raleigh an attractive destination for businesses.



The commercial real estate market in Raleigh is flourishing across various sectors. The office market remains strong, with significant demand driven by the tech industry and professional services. Industrial spaces are also in high demand, particularly for logistics and distribution, due to Raleigh's strategic location on the East Coast. The retail sector is evolving, with mixed-use developments and experiential retail spaces becoming more prevalent in response to changing consumer preferences.



Raleigh's population is growing rapidly, drawing a diverse and youthful demographic, including many millennials and professionals. The city is renowned for its high quality of life, offering a blend of urban amenities and suburban comfort, including green spaces, cultural attractions, and a favorable cost of living. Infrastructure in Raleigh is well-developed, with excellent transportation access through major highways, an expanding public transit system, and Raleigh-Durham International Airport (RDU). The city is also seeing significant investments in infrastructure, housing, and commercial developments, further enhancing its appeal.

With its strong economic growth, increasing property values, and low vacancy rates, Raleigh presents compelling investment opportunities. The city's ongoing population influx, economic expansion, and infrastructure improvements suggest a bright future for real estate development and investment in the region.

Demographics

THE FUTURE OF BLUE RIDGE ROAD:

The Blue Ridge Corridor project in Raleigh is a transformative development aimed at enhancing connectivity, livability, and economic opportunities along the Blue Ridge Road corridor, ultimately creating a vibrant and sustainable urban environment for residents and businesses.

DEMOGRAPHICS

2028 data projection

15 Mile

2028 Total Population	1,223,768
2028 Average Household Income	\$151,322
Population Growth 2023-2028	5.95%

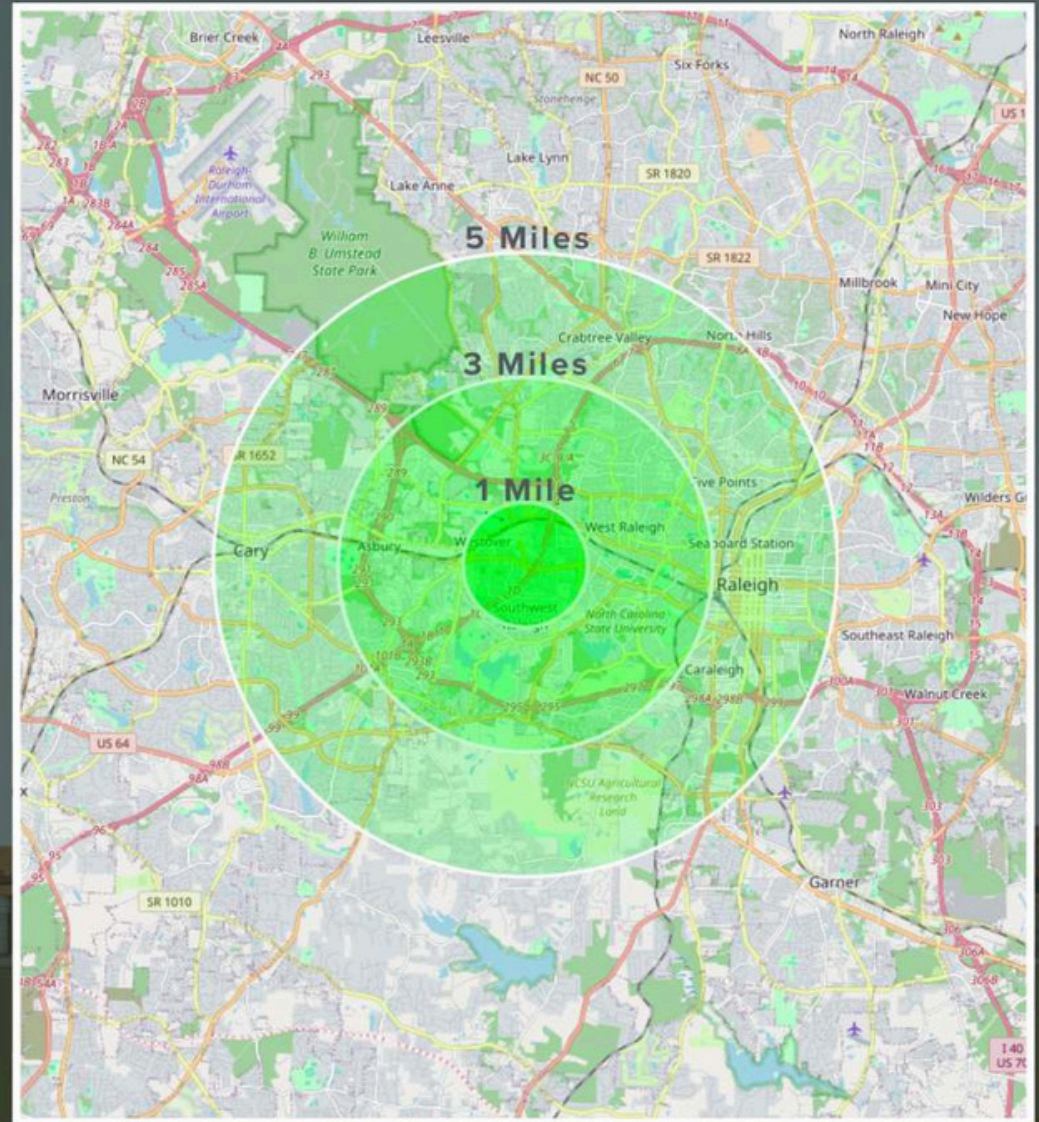

Executive Team



NIKITA ZHITOV

Nikita Zhitov is a highly successful commercial real estate investor and developer based in Raleigh, NC. Over his 20 year career in CRE, he amassed a large portfolio of properties both in the US and abroad, including notable landmarks, mixed-use developments, and millions of square feet of industrial & retail properties. Nikita is a recognized business leader, philanthropist, and motivational speaker, featured in prestigious publications like Forbes and Fortune, Entrepreneur and Inc.



VINCENZO VERDINO

Vincenzo Verdino, Principal at CityPlat with over a decade of real estate experience, specializes in structured debt and equity finance. Before his real estate career, he excelled in sales at The Corporate Executive Board in Washington DC. Vincenzo holds a Bachelor's degree in Political Science from Georgetown University and founded businesses in Italy before returning to Raleigh, North Carolina, in 2004.



PAT MOORE

Pat Moore, Principal at CityPlat, brings 13+ years of real estate experience with a focus on land. Pat's expertise also extends to architecture, civil engineering, student 1 housing, ground-up development, adaptive reuse, and rezoning cases. Pat holds a bachelor's degree in Urban Planning from the University of Pittsburgh and actively participates in his community.



GAURAV PATEL

Gaurav "G" Patel, an entrepreneur with diverse experience across industries, started his journey in India and values hard work and moral ethics. Over 15 years, he has weathered the challenges of entrepreneurship, impacting his community through various ventures. G is now a husband, father, entrepreneur, and mentor, driven by a strong work ethic to add value to individuals and businesses.



J. SCOTT SCHEEL

J. Scott Scheel, with 35 years in Commercial Real Estate, leads a portfolio of 8 million sq. ft. across 13 states. He specializes in diverse sectors and multi-billion dollar projects. Founder of the Diamond Inner Circle and Commercial Academy, he's a key thought leader, speaker, and Fox Business contributor. Also a film producer and business owner, he focuses on community impact and inspiring success.