

For Sale

2nd Floor Strata Retail Opportunity in Denman Village



#210 - 911 Denman Street

Vancouver BC

The Opportunity



ADDRESS #210 - 911 Denman Street

AREA 2,906 SF

STRATA LOT SL8

MONTHLY STRATA FEES \$2,202.40

ZONING C-5

TENANCY Contact Agent

ASKING PRICE \$3,488,000



CBRE Limited is pleased to present the opportunity to acquire #210 - 911 Denman Street, a 2,906 square foot, prime second floor strata retail unit located in a beautiful landmark heritage building, formerly known as the Bay Theatre. This opportunity offers exceptional exposure to both vehicular and pedestrian traffic year-round, and is surrounded by a culturally diverse and vibrant amenity offering.

The Subject Property features large bay windows, elevator access, exceptional frontage and signage opportunities, and plenty of natural light.

Space Features

-  Denman Street Signage Opportunity
-  Strong Pedestrian and Vehicular Traffic
-  Ample Natural Light
-  Vibrant Amenity Base
-  800 AMP Power
-  Classic “Art Moderne” Style



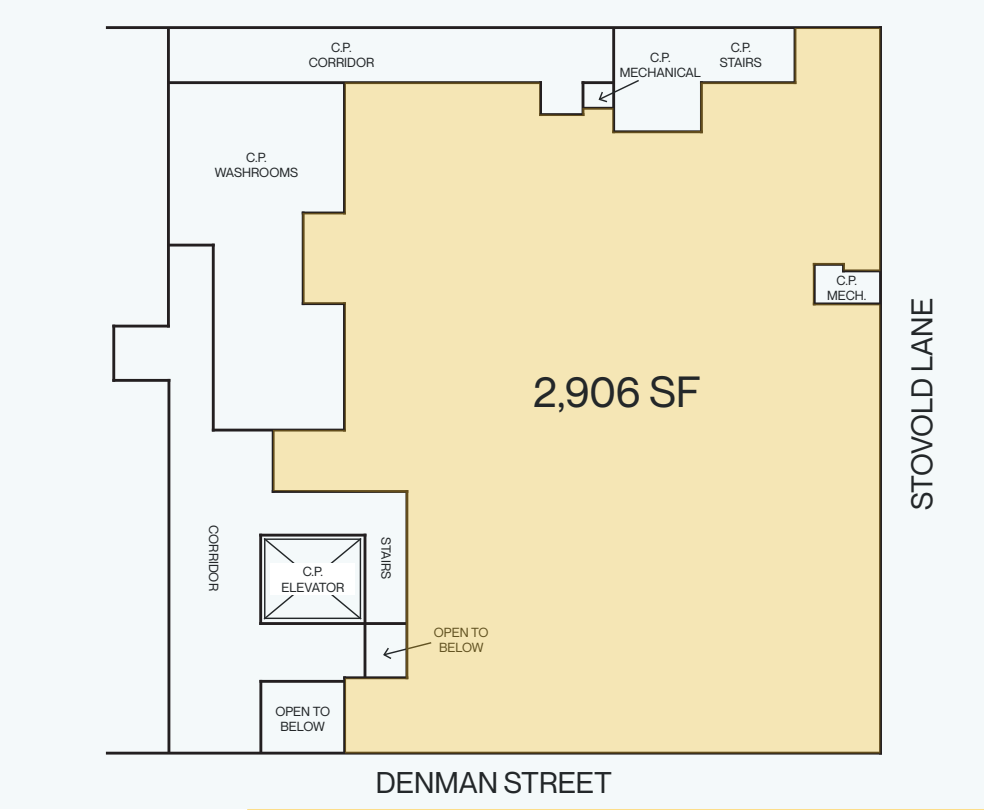

The Space



The Subject Property is located near the corner of Denman Street and Barclay Street in Vancouver's sought-after West End neighbourhood - a vibrant, diverse, and densely populated community. Located just steps from English Bay Beach and Stanley Park and within walking distance of Downtown Vancouver's Central Business District, #210 - 911 Denman Street offers excellent walkability to numerous restaurants, cafes, services, beaches, and the seawall.



Neighbourhood *Tenants*

- | | | | |
|-------------------------|---------------------------------|-----------------------|------------------------------|
| + Cactus Club Cafe | + Papi's Seafood and Oyster Bar | + Anytime Fitness | + Tavola |
| + CRAFT Beer Market | + The Three Brits Public House | + Dollarama | + Nook |
| + London Drugs | + Oakberry | + The Jungle Room | + Safeway |
| + McDonald's | + Hook Restaurant | + Kingyo | + BC Liquor |
| + Noah's Cafe | + Kin's Farm Market | + Blenz Coffee | + Banana Leaf Malaysian Cafe |
| + Delany's Coffee House | + Marble Slab Creamery | + True Confections | + Guu with Garlic |
| + Tim Hortons | + Peaked Pies | + Breka Bakery & Cafe | + Starbucks |

For Sale



#210 - 911 Denman Street

Vancouver BC

Please Contact

Adrian Beruschi

Personal Real Estate Corporation

Senior Vice President
Retail Properties
604 662 5138
adrian.beruschi@cbre.com

Darren Starek

Senior Vice President
Advisory & Transaction Services
604 662 5175
darren.starek@cbre.com

Chloe Hamelin

Associate
Retail Properties
604 662 5166
chloe.hamelin@cbre.com

This disclaimer shall apply to CBRE Limited, Real Estate Brokerage, and to all other divisions of the Corporation; to include all employees and independent contractors ("CBRE"). The information set out herein, including, without limitation, any projections, images, opinions, assumptions and estimates obtained from third parties (the "Information") has not been verified by CBRE, and CBRE does not represent, warrant or guarantee the accuracy, correctness and completeness of the Information. CBRE does not accept or assume any responsibility or liability, direct or consequential, for the Information or the recipient's reliance upon the Information. The recipient of the Information should take such steps as the recipient may deem necessary to verify the Information prior to placing any reliance upon the Information. The Information may change and any property described in the Information may be withdrawn from the market at any time without notice or obligation to the recipient from CBRE. CBRE and the CBRE logo are the service marks of CBRE Limited and/or its affiliated or related companies in other countries. All other marks displayed on this document are the property of their respective owners. All Rights Reserved.

Mapping Sources: Canadian Mapping Services canadamapping@cbre.com; DMTI Spatial, Environics Analytics, Microsoft Bing, Google Earth.

CBRE Limited | 1021 West Hastings Street | Suite 2500 | Vancouver, BC | V6E 0C3
www.cbre.ca

CBRE