

DEPICTIVE FLOOR PLAN
SCALE 1/4" = 1'-0"

KEYED NOTES

- 1 PREFABRICATED WALK-IN COOLER AND FREEZER. FREEZER ON RECESSED CONCRETE SLAB.
- 2 NEW MOP SINK
- 3 NEW HAND SINK
- 4 INFILL WITH 2X FRAMING AND GYP. BD. TO MATCH EXISTING. NEW EIFS TO MATCH EXISTING.
- 5 SOFFIT ABOVE - REFER TO 1/A-3 FOR ADDITIONAL INFORMATION.
- 6 SELF-SERVICE COUNTER PROVIDED BY VENDOR, INSTALLED BY G.C. - REFER TO T-1 FOR VENDOR CONTACT INFORMATION.
- 7 KITCHEN HOODS - REFER EQUIPMENT AND MECHANICAL DRAWINGS FOR LOCATION AND ADDITIONAL INFORMATION.
- 8 MENU BOARDS - SEE INTERIOR ELEVATION 1/A-8.2 FOR ADDITIONAL INFORMATION.
- 9 AWNINGS - CONTACT AWNING VENDOR FOR MORE INFORMATION.
- 10 ALUMINUM ENTRY CANOPY - CONTACT AWNING VENDOR FOR MORE INFORMATION.
- 11 ALUMINUM DRIVE-THRU CANOPY - CONTACT AWNING VENDOR FOR MORE INFORMATION.
- 12 EXISTING ROOF LADDER
- 13 P.O.S. STATIONS - G.C. TO COORDINATE POWER AND DATA REQUIREMENTS.
- 14 DRIVE-THRU WINDOW - REFER TO A-11 FOR ADDITIONAL INFORMATION.
- 15 TRASH AND RECYCLE CONTAINER
- 16 NEW SIDING, REFER TO A-4.0 AND A-4.1 FOR ADDITIONAL INFORMATION.
- 17 REFERENCE SITE PLANS FOR EXTENTS OF EXTERIOR CONCRETE LANDINGS, SIDEWALKS, AND FRONT PATIO.
- 18 OPEN
- 19 3'-6" TRENCH DRAIN - REFER TO A-10 FOR ADDITIONAL INFORMATION.
- 20 EXISTING ROOF DOWNSPOUT - REFER TO EXTERIOR ELEVATIONS A-4 & A-4.1 FOR ADDITIONAL INFORMATION

GENERAL NOTES

1. SEE DIMENSIONED FLOOR PLAN FOR WALL TYPES AND DIMENSIONS.
2. SEE SHEET A-11 FOR ALL WINDOW AND DOOR SCHEDULES AND DETAILS
3. OPEN
4. SEE INTERIOR AND EXTERIOR ELEVATIONS FOR WALL FINISHES.
5. SEE REFLECTED CEILING PLAN FOR CEILING FIXTURES, MATERIALS, AND CEILING HEIGHTS.
6. OPEN
7. SEE EQ-1 AND EQ-11 FOR KITCHEN EQUIPMENT AND SCHEDULES.
8. SEE CIVIL PLANS FOR SITE LAYOUT AND ASSOCIATED UTILITIES.
9. PROVIDE 2" MINIMUM CLEAR SPACE BETWEEN COOLER/FREEZER AND FINISHED WALL. CONTRACTOR TO VERIFY EXACT LOCATION WITH COOLER/FREEZER MANUFACTURER AND PROVIDE ALL FINAL CONNECTIONS.
10. G.C. TO INSTALL STAINLESS STEEL CORNER GUARDS AND WALL CAPS AT ALL EXPOSED CORNERS IN SERVING LINE (105), COOK LINE (106), PREP (107), DISHWASH (116), AND OFFICE (115) - SEE DETAILS 3/A-1. CORNER GUARDS PROVIDED IN STAINLESS STEEL WALL PROTECTION PACKAGE.
11. SELECTED BOOTH TABLES TO BE ATTACHED TO ADJACENT WALL - REFER TO 1/A-7.1 FOR LOCATIONS AND 2/A-7.1 FOR ADDITIONAL INFORMATION, TYP.

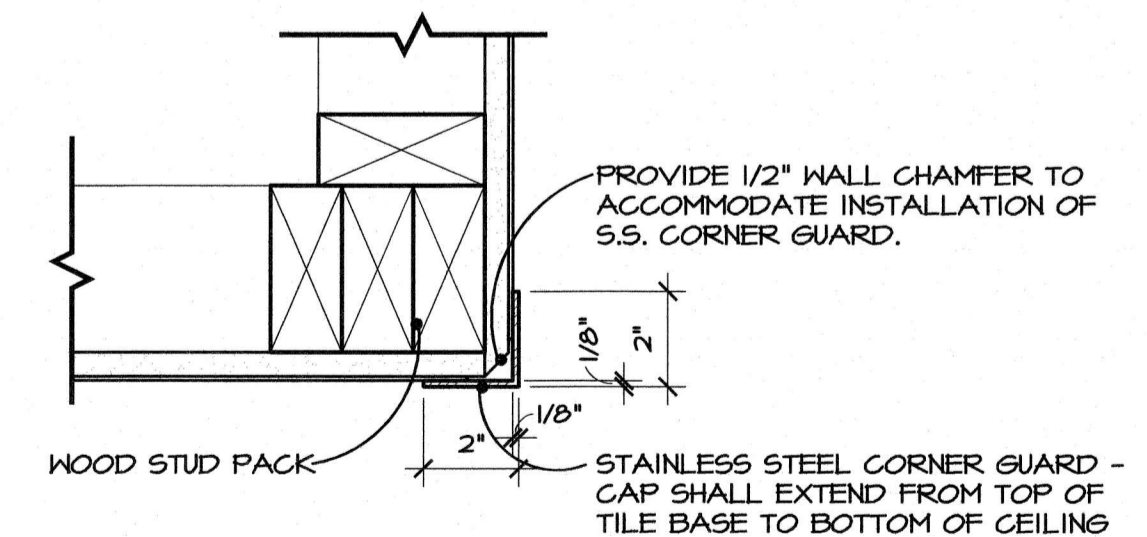

3/A-1 S.S. CORNER GUARD
SCALE 1/2" = 1'-0"

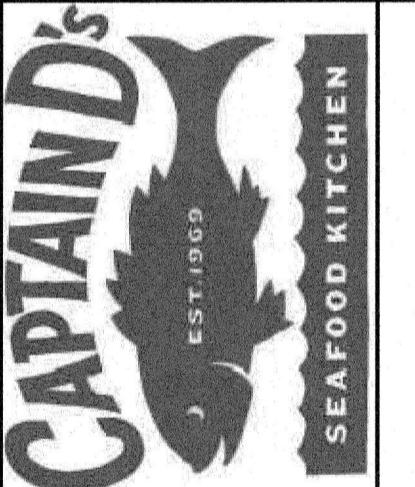

Job Number:
68C-0157
Revisions:

MAY 18, 2017

A-1
DEPICTIVE FLOOR PLAN