

OFFICE/INDUSTRIAL FOR LEASE 8229 CLOVERLEAF DRIVE

8229 Cloverleaf Dr., Millersville, MD 21108

Available: 3,244 - 11,605 SF



LISTING DATA

AVAILABLE SF: 3,244 - 11,605 SF
OFFICE SF: 41036

ECONOMIC DATA

LEASE RATE: Call for information

PROPERTY INFORMATION

COUNTY: Anne Arundel
MARKET: Baltimore
SUBMARKET: I-97

BUILDING DATA

TOTAL BUILDING SF: 39,574 SF
YEAR BUILT: 1998
ZONING: C4

PROPERTY OVERVIEW

For Lease: 3,244 - 11,605 SF Flex Space, 120 free surface parking spaces, and dock loading

PROPERTY HIGHLIGHTS

- **Unit 420:** 3,244 SF 100% Office, 100% HVAC
- **Unit 440:** 6,477 SF Industrial, Dock Loaded, 100% HVAC
- **Unit 450:** 5,128 SF Industrial, Dock Loaded, 100% HVAC
- **Units 440-450:** 11,605 SF, Dock Loaded, 100% HVAC

Kate Jordan, SIOR
Principal
410.336.5314
kjordan@lee-associates.com

Marley Welsh, SIOR
Principal
443.741.4050
mwelsh@lee-associates.com

All information furnished regarding property for sale, rental or financing is from sources deemed reliable, but no warranty or representation is made to the accuracy thereof and same is submitted to errors, omissions, change of price, rental or other conditions prior to sale, lease or financing or withdrawal without notice. No liability of any kind is to be imposed on the broker herein.

OFFICE/INDUSTRIAL FOR LEASE 8229 CLOVERLEAF DRIVE

8229 Cloverleaf Dr., Millersville, MD 21108

Available: 3,244 - 11,605 SF

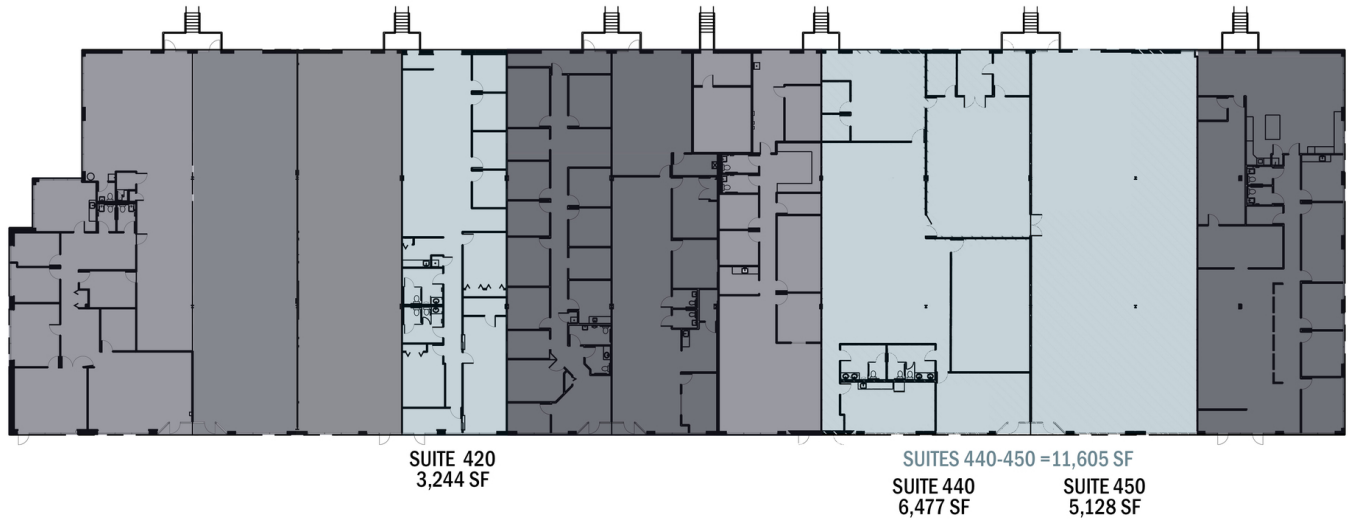

AVAILABLE SPACES

SUITE	SIZE (SF)	LEASE TYPE	LEASE RATE	DESCRIPTION
Suite 420	3,244 SF	NNN	Call for information	Office
Suite 440	6,477 SF	NNN	Call for information	Industrial
Suite 450	5,128 SF	NNN	Call for information	Industrial
Suites 440-450	6,477 - 11,605 SF	NNN	Call for information	Industrial

Kate Jordan, SIOR
Principal
410.336.5314
kjordan@lee-associates.com

Marley Welsh, SIOR
Principal
443.741.4050
mwelsh@lee-associates.com

All information furnished regarding property for sale, rental or financing is from sources deemed reliable, but no warranty or representation is made to the accuracy thereof and same is submitted to errors, omissions, change of price, rental or other conditions prior to sale, lease or financing or withdrawal without notice. No liability of any kind is to be imposed on the broker herein.