

FOR LEASE

Alico Business Park

16281-16291 Domestic Ave. Fort Myers, FL 33912



CUSHMAN &
WAKEFIELD

COMMERCIAL
PROPERTY
SOUTHWEST FLORIDA



Cushman & Wakefield | Commercial Property Southwest Florida is pleased to present the leasing of Alico Business Park. The property is an industrial park consisting of four total buildings. Buildings were constructed in 2020-2022. All units are equipped with 2 restrooms with 3 phase power. The park is located in a very active industrial development area. Alico Business Park is located two miles from I-75, providing quick and easy access to the interstate.

Property Highlights

Address 16281-16291 Domestic Avenue
Fort Myers, FL 33912

Year Built 2020 / 2021 / 2022

Total Bldgs Four (4)

Total Bldg. SF 174,600 SF

Land Area 24 Acres

Available SF 7,275-58,200 SF

Lease Rate \$14.00 - 15.00 NNN

CAM \$3.29 / SF

Submarket S Fort Myers / San Carlos

Property Type (2) Dock High Industrial
(2) Grade-Level Industrial

Clear Height 18' Grade Level

Roll Up Doors

16 per building (12' x 14')

Zoning

IPD
(Industrial Planned
Development)



Alico Business Park

Grade Level and Dock High Available



CUSHMAN & WAKEFIELD

COMMERCIAL
PROPERTY
SOUTHWEST FLORIDA

Unit	SF	Lease Rate	CAM	Monthly Total Taxes not included
16291	29,100 SF	\$15.00 NNN	\$3.29 / SF	\$44,353.25



Unit has 16 Grade Level Doors 12'x14'

Unit	SF	Lease Rate	CAM	Monthly Total Taxes not included
16321	58,200 SF	\$14.00 NNN	\$3.29 / SF	\$83,856.50

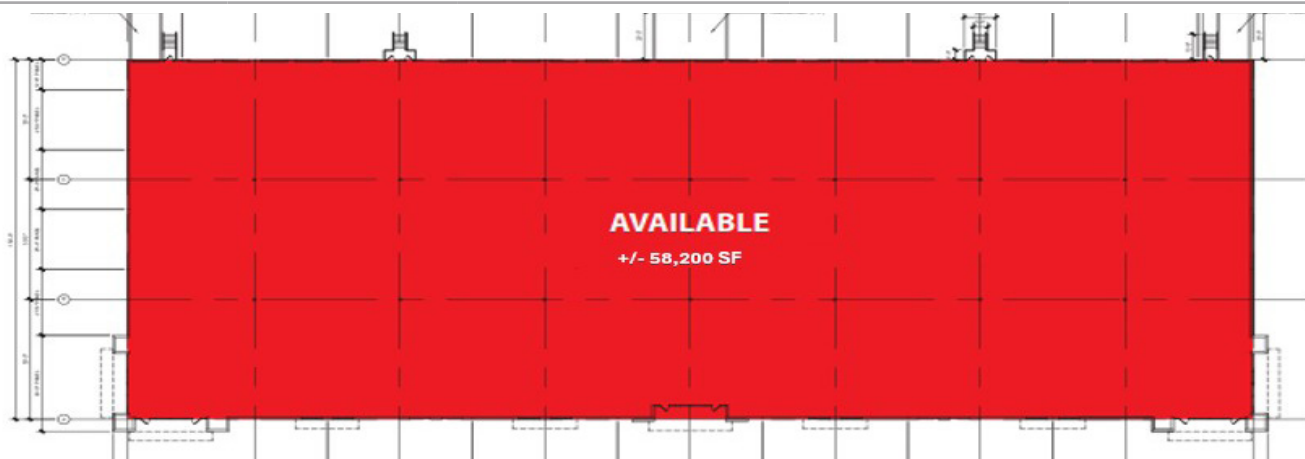

Unit has 22 Dock Doors, 3 Ramps, with +/- 2,500 SF of Office

Alico Business Park is a prime location in a high-density industrial corridor. Domestic Ave. connects to Alico Rd. which leads to I-75 and is located just minutes from the Southwest Florida International Airport.

Alico Business Park is strategically positioned with easy access for multi-modal shipping. The proximity to I-75 and the Southwest Florida International Airport is beneficial for manufacturing and distribution.

Gary Tasman
CEO & Principal Broker
+1 239 489 3600
gtasman@cpswfl.com



Shawn Stoneburner
Senior Director
+1 239 489 3600
sstoneburner@cpswfl.com



5220 Summerlin Commons Blvd. Suite 500
Fort Myers, FL 33907
239 489 3600
www.cpswfl.com