

# JENDOCO REAL ESTATE

**TRY OUR  
NEW WEBVISION**

**jendoco-re.com**

## **Parkway West Business Park**

**1405 Parkway View Drive**

**5,825 Total Square Feet**

**1,643 Square Feet of Finished Office**



### **MAIN FEATURES**

- Clear Height: 16ft. Above finished floor to underside of structural steel
- Exterior: Insulated wall panel
- Glass wall system at offices

### **UTILITIES**

- Electric: 120/208 volt, three phase four wire
- Natural Gas: Equitable
- Water & Sewage: Robinson Twp.

### **MISCELLANEOUS**

- Ample truck access and maneuvering
- 4 ft. high loading docks
- 24 hour, 7 day a week access



**Contact** Meredith Calfe and Pierre Brun - **T** 412-361-4509 **F** 412-361-4790 - **Internet** [www.jendoco-re.com](http://www.jendoco-re.com)

All information furnished regarding properties for rent or sale are subject to errors, omissions, change of price or rental and change or withdraw without notice. Rental terms, all dimensions and specifications are approximate and subject to change without notice.

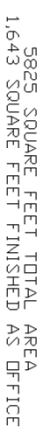

TYPICAL WALL SECTION  
N.T.S.

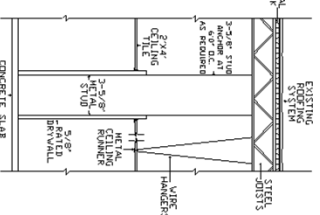

Phone: (412) 361 - 4509  
Fax: (412) 361 - 4790

## PWBP-1405

NORTH