

CANADY HEURS
S40795

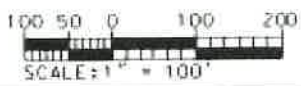

MOVE
3280771



CBSKO
240-1002

TRUE WORLD WYRME, LLC
2820/789
FENCE ENCROACHES 12



IT PROPERTY

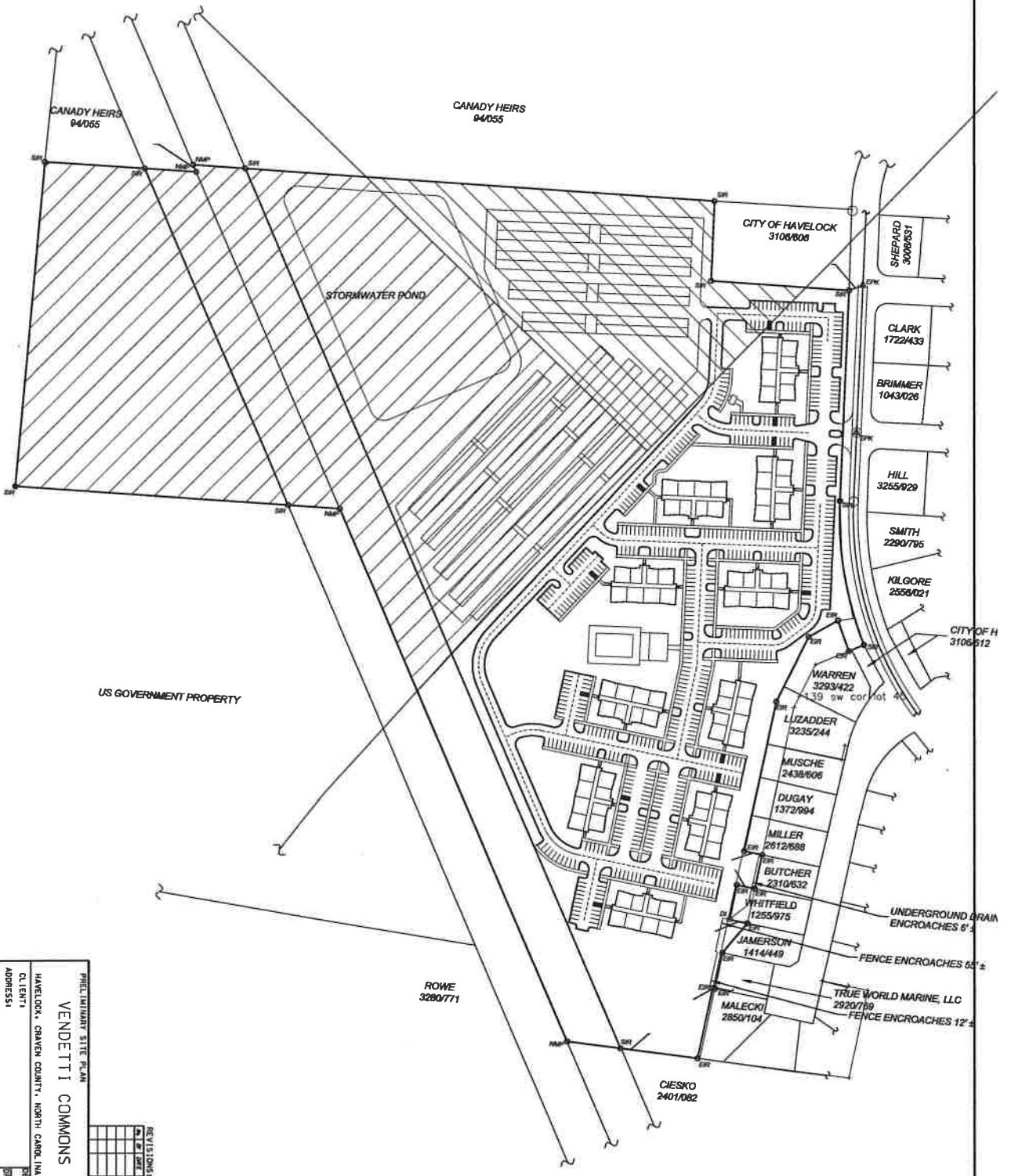

US GOVERNMENT PROPERTY

CANADY HEIRS
94/055

CANADY HEIRS
94/055

CITY OF HAVELOCK
3106/808

SHEPARD
3008/631

CLARK
1722/433

BRIMMER
1043/026

HILL
3255/829

SMITH
2290/795

KILGORE
2558/021

CITY OF H
3106/512

WARREN
3293/422

LIZADDER
3235/244

MUSCHE
2438/606

DUGAY
1372/694

MILLER
2612/688

BUTCHER
2310/632

WHITFIELD
1255/975

JAMERSON
1414/448

MALECKI
2850/104

CIESKO
2401/082

ROWE
3280/771

UNDERGROUND GRAM
ENCROACHES 6' ±

FENCE ENCROACHES 6' ±

TRUE WORLD MARINE, LLC
2920/789
FENCE ENCROACHES 12' ±

PRELIMINARY SITE PLAN

VENETTI COMMONS

HAVELOCK, GRANVILLE COUNTY, NORTH CAROLINA

CLIENT:

ADDRESS:

PHONE:

DATE:

SCALE:

DESIGNED BY:

DRAWN BY:

CHECKED BY:

APPROVED BY:

DATE:

SCALE:

THE QUAPPEN GROUP, P.A.
1000 W. HARRIS STREET, SUITE 200
HARRISVILLE, NC 28541
PHONE: 773-5083 FAX: 773-5084
LICENSE NO. C-448

RONALD D. COLLIER, P.E.

NO.	DATE	REVISIONS

THOMAS ENGINEERING, PA est 1983
 civil engineering • land development • project management
 P. O. Box 1309, New Bern, NC 28563
 www.ThomasEngineeringPA.com
 Office: 252.637.2727 Fax: 252.636.2448



R7 STANDARD LOT SIZE
 60' X 125'

GRAPHIC SCALE
 1" = 100'

PROJECT NUMBER	DATE

1/2" = 1" (Scale)
 Not for construction. This drawing is for informational purposes only.

SITE PLAN

R7 CONCEPT
 CLARK BELL TOWN

DRAWN BY	CHECKED BY
DATE PLOTTED	SCALE
PROJECT #	SHEET #

