

AVAILABILITY

FOR SALE

31,799 SF Office /Warehouse

Part of a Larger Building

2101-2115 Tempel Drive, Libertyville IL.

RRD REALTY LLC

COMMERCIAL REAL ESTATE

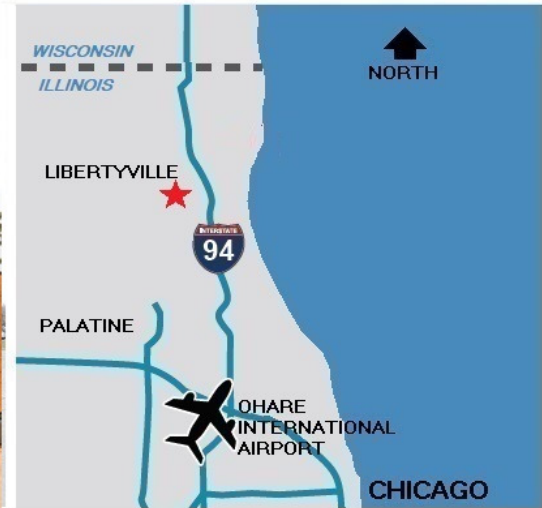

Building Specifications:

- ◆ **Approx.: 31,799 SF 50% of the building**
- ◆ **LED Lighting**
- ◆ **Masonry Construction**
- ◆ **Air-Conditioned Offices**
- ◆ **Fire Sprinklers**
- ◆ **Ample Parking**
- ◆ **Frontage on US Route 45**
- ◆ **Taxes: \$1.40 PSF**
- ◆ **20' Clear Ceilings**
- ◆ **4 Ext. Loading Docks & 1 DID**
- ◆ **Sale Price: Subject to Offer**

Contact Us

Rick Delisle
847 812 8180
rrdrealty@gmail.com



No warranty or representation is made with respect to the accuracy of the information contained in this brochure. Terms of a sale or lease and availability is subject to change or withdrawal without notice.

RRD Realty LLC
165 N Archer,
Mundelein IL. 60060

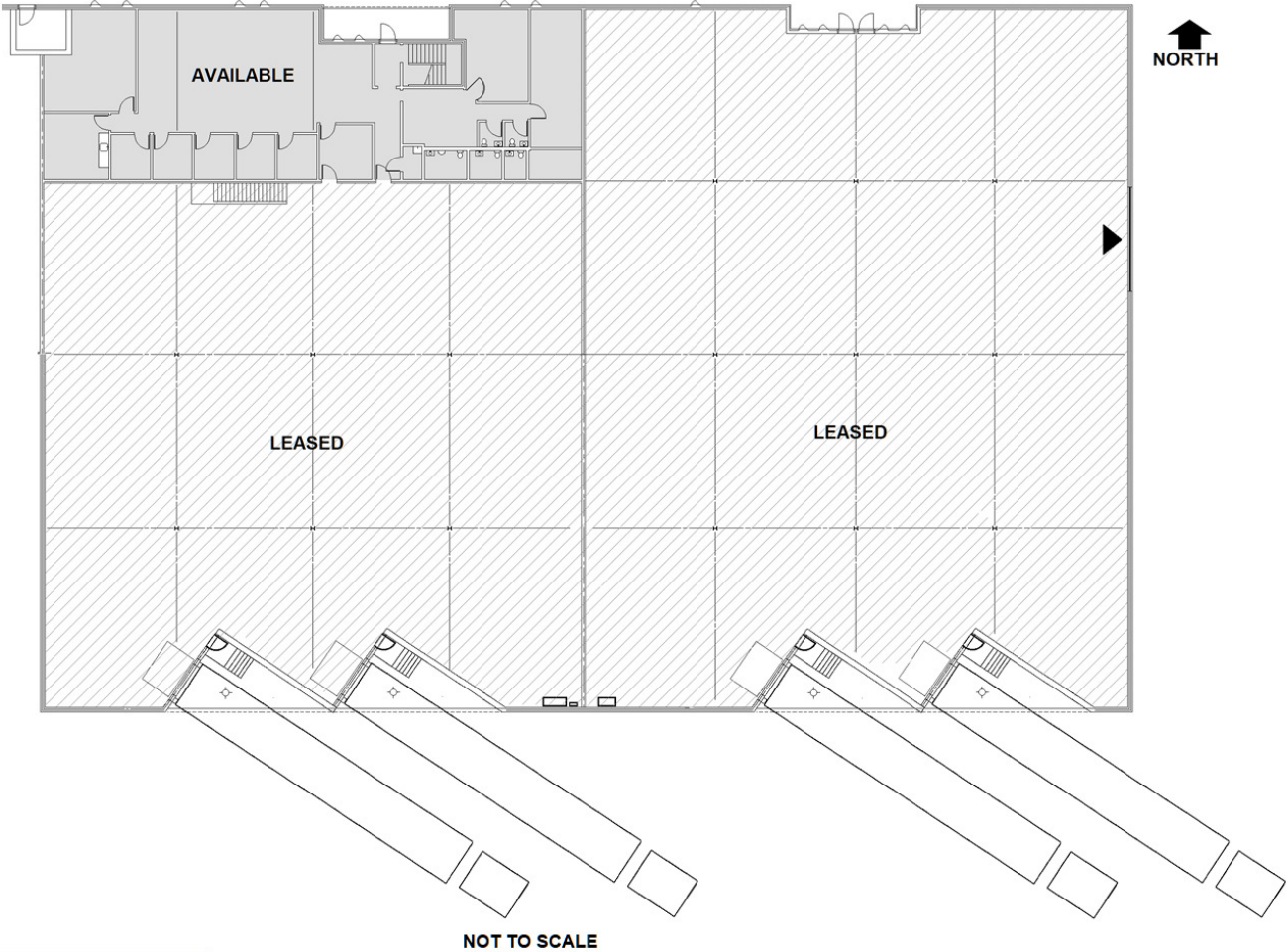
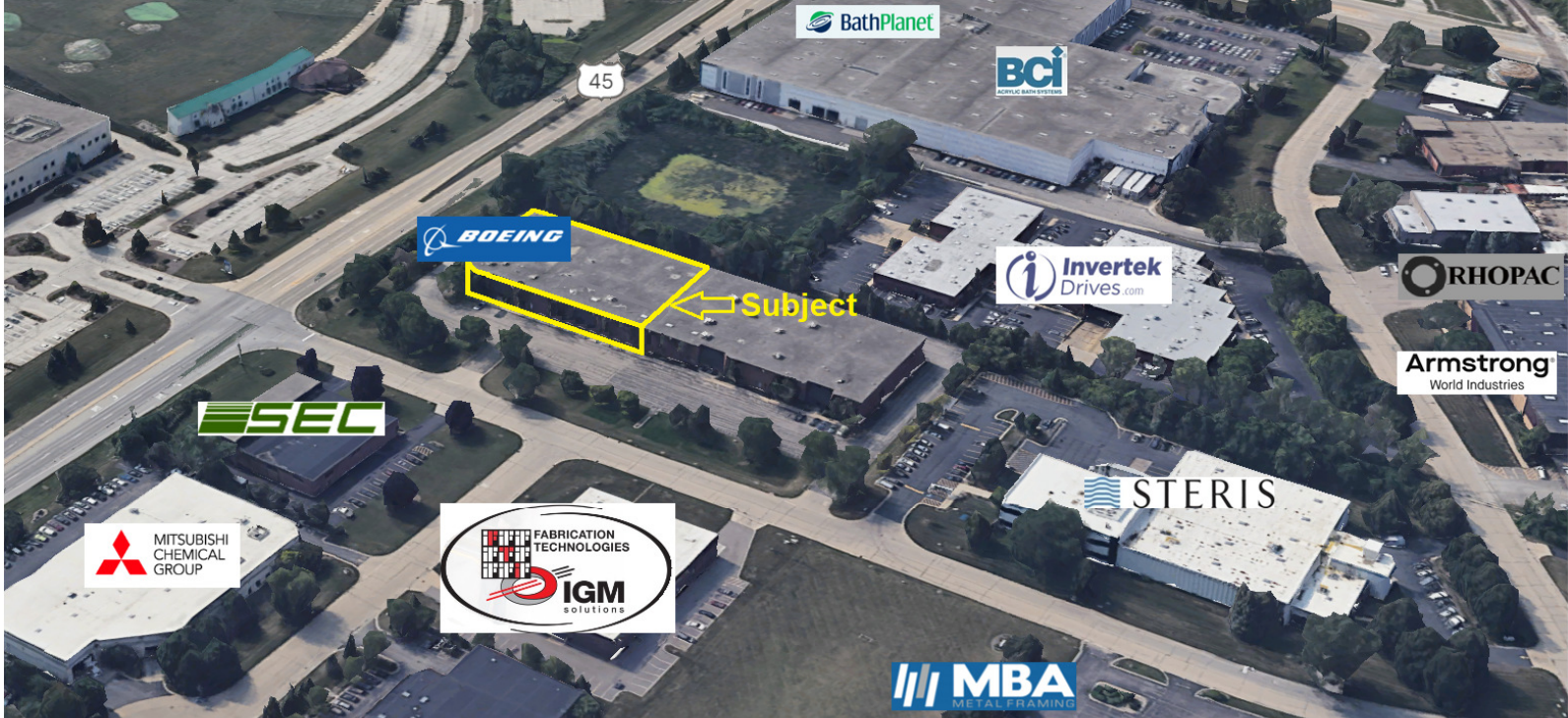

NOT TO SCALE

Rick Delisle
 847 812 8180
 rdelisle@rdstrategic.com

RD Strategic
 165 Archer
 Mundelein IL 60060

No warranty or representation is made with respect to the accuracy of the information contained in this brochure.
 Terms of a sale or lease and availability subject to change or withdrawal without notice.

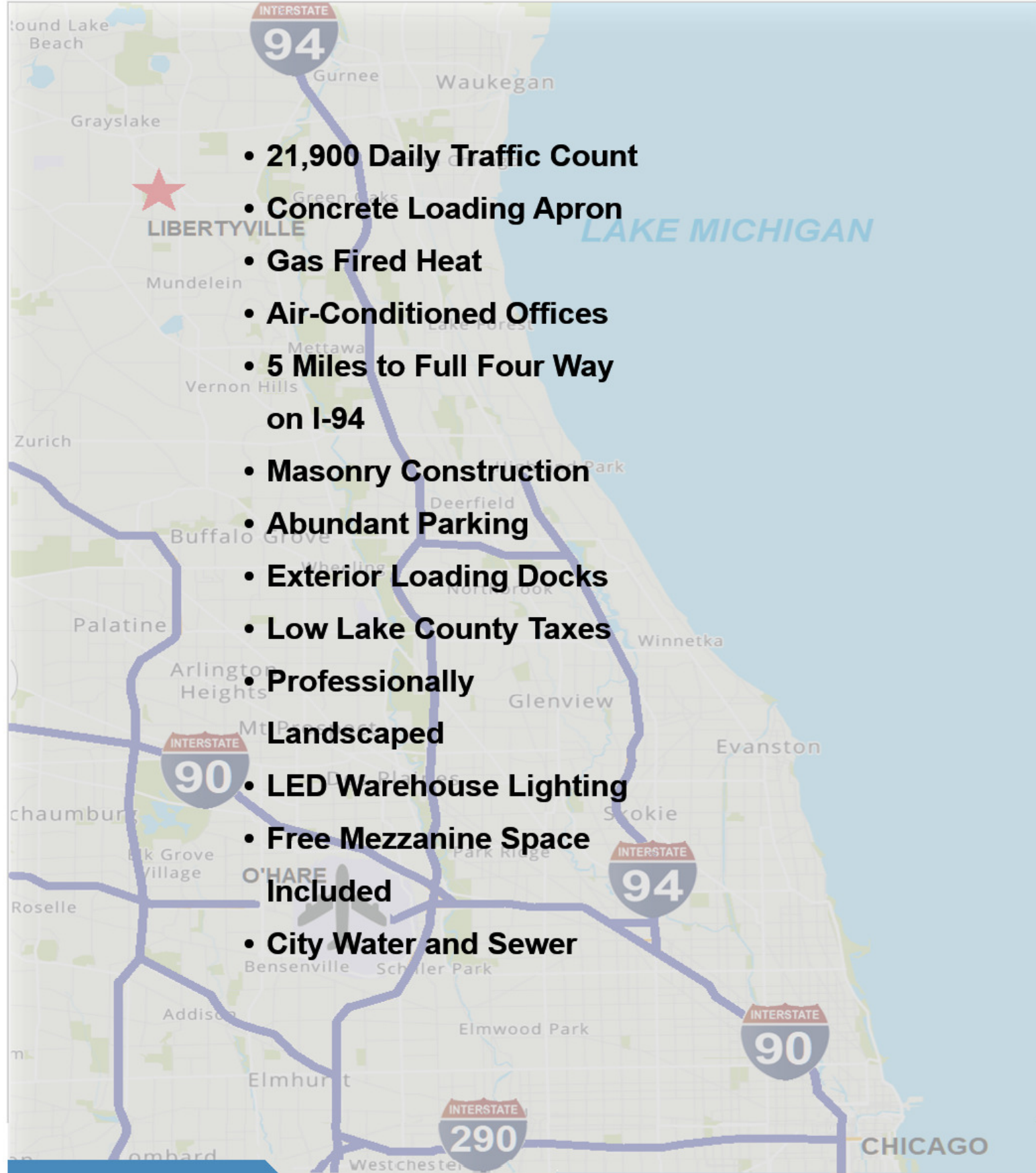

- **21,900 Daily Traffic Count**
- **Concrete Loading Apron**
- **Gas Fired Heat**
- **Air-Conditioned Offices**
- **5 Miles to Full Four Way on I-94**
- **Masonry Construction**
- **Abundant Parking**
- **Exterior Loading Docks**
- **Low Lake County Taxes**
- **Professionally Landscaped**
- **LED Warehouse Lighting**
- **Free Mezzanine Space Included**
- **City Water and Sewer**

Rick Delisle
847 812 8180
rdelisle@rdstrategic.com

RD Strategic
165 Archer
Mundelein IL 60060

No warranty or representation is made with respect to the accuracy of the information contained in this brochure. Terms of a sale or lease and availability subject to change or withdrawal without notice.