

3500

INDUSTRIAL ROAD

HARRISBURG, PA



±87,500 SF

AVAILABLE

FOR SUBLEASE

Gerry Blinebury
Executive Vice Chairman
+1 717 231 7291
gerry.blinebury@cushwake.com

Allie Gaeta
Senior Director
+1 717 231 7461
allie.gaeta@cushwake.com



Cushman & Wakefield Copyright 2025. No warranty or representation, express or implied, is made to the accuracy or completeness of the information contained herein, and same is submitted subject to errors, omissions, change of price, rental or other conditions, withdrawal without notice, and to any special listing conditions imposed by the property owner(s). As applicable, we make no representation as to the condition of the property (or properties) in question.

LOCATION

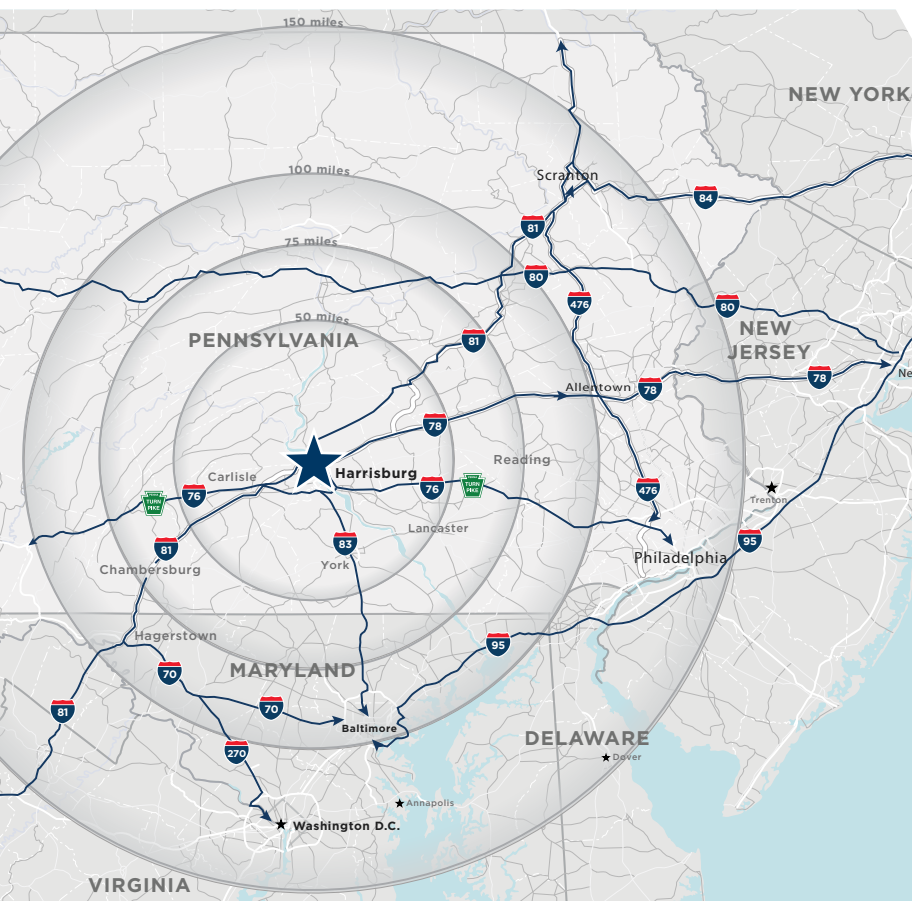

DRIVE TIMES

I-81
2.5 MILES

HARRISBURG, PA
25 MILES

BALTIMORE, MD
80 MILES

WASHINGTON, D.C.
120 MILES

I-83
5 MILES

YORK, PA
25 MILES

PHILADELPHIA, PA
110 MILES

NEW YORK, NY
170 MILES

LOCAL TENANTS



NEARBY TENANTS



SITE ADVANTAGES



PRIME LOCATION Direct Access to Interstate 81



RACKING SYSTEM Existing Racking Available To Subtenant If Interested



SIZABLE LABOR MARKET characterized by a skilled and diverse workforce. The region's strategic location and excellent transportation infrastructure make it a prime choice for industrial operations, ensuring a steady supply of qualified employees.

BUILDING SPECS

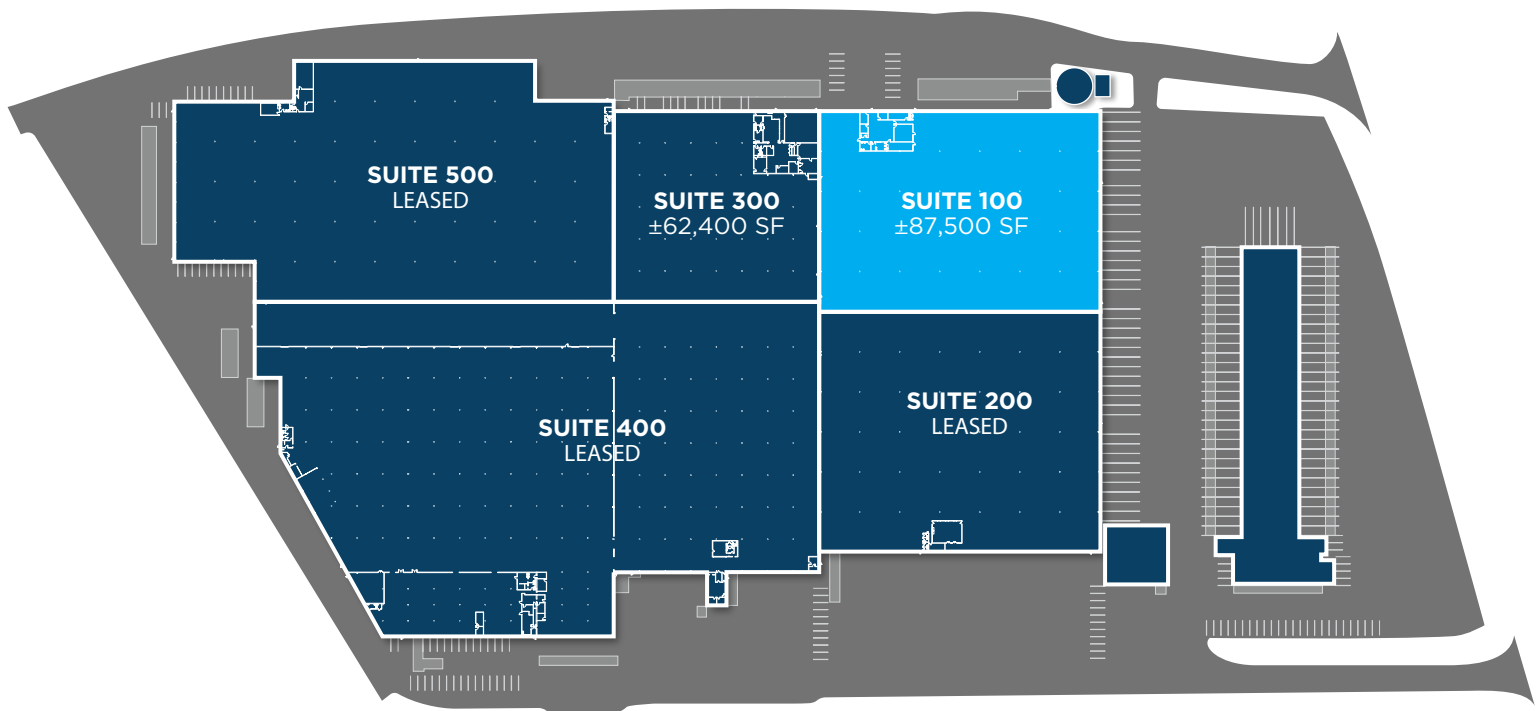

±87,500

SQUARE
FEET

±10

DOCK
DOORS

25'

CLEAR
HEIGHT

90'

TRUCK
COURT

SUITE 100	
AVAILABLE SF	±87,500 SF
OFFICE AREA	±4,000 SF
YEAR BUILT	1970
COLUMN SPACING	50' x 50'
CLEAR HEIGHT	25'
TRUCK COURT	90'
DOCK DOORS	10
POWER	600amp, 3-phase, 277/470 v
LIGHTING	T-5
FIRE PROTECTION	Wet Sprinkler System

Gerry Blinebury
Executive Vice Chairman
+1 717 231 7291
gerry.blinebury@cushwake.com

Allie Gaeta
Senior Director
+1 717 231 7461
allie.gaeta@cushwake.com

