

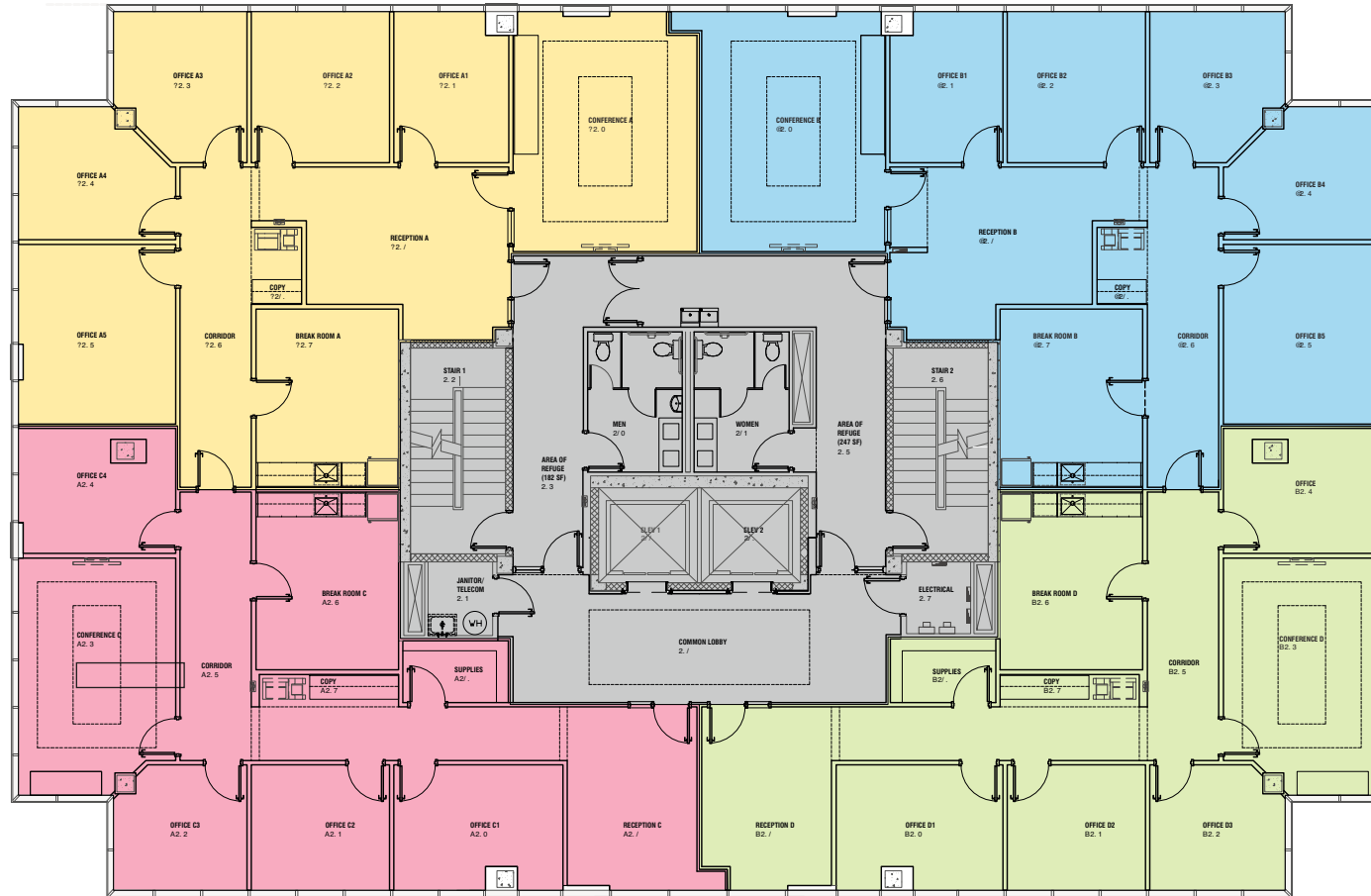





FIRST HORIZON BANK BUILDING- 4TH FLOOR

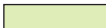

	USF	LOAD FACTOR	RSF
 SUITE A	1,727 SF		
 SUITE B	1,737 SF		
 SUITE C	1,535 SF		
 SUITE D	1,530 SF		
 COMMON	1,669 SF		

Usable Square Footage (USF): The actual, physical space a tenant occupies, measured from the center of shared walls to the inside finish of exterior walls.

Rentable Square Footage (RSF): The USF plus a proportional share of common areas, which serves as the basis for rent payments.

Load Factor (or Common Area Factor): The percentage by which the Usable Area is multiplied to calculate the Rentable Area. It represents the inefficiency ratio (e.g., a 15% load factor means a 1.15 multiplier).