

FORMER CARL'S JR. FOR LEASE OR SALE

3380 N. Hayden Road, Scottsdale, AZ 85251



**± 4,180 SF Freestanding
Drive-Thru Building**

**DRIVE
THRU**

N

- ± 4,180 SF Freestanding Drive-Thru Building available for Lease or Sale!
- Big traffic counts with over 44,000 VPD at the intersection.
- Excellent ingress/egress with multiple full-access points to the PAD.
- Shopping center anchored by Harbor Freight Tools, Dollar Tree and Big 5 Sporting Goods.
- National and regional credit tenants including Starbucks, Salon Centric, The UPS Store, Arizona Federal Credit Union and Livingston Hearing Aids.
- Proximity to the HonorHealth Osborn Medical Center, the newly renovated Giants Spring Training Stadium and Old Town Scottsdale.
- Significant daytime population and excellent demographics

FORMER CARL'S JR. FOR LEASE OR SALE

3380 N. Hayden Road, Scottsdale, AZ 85251

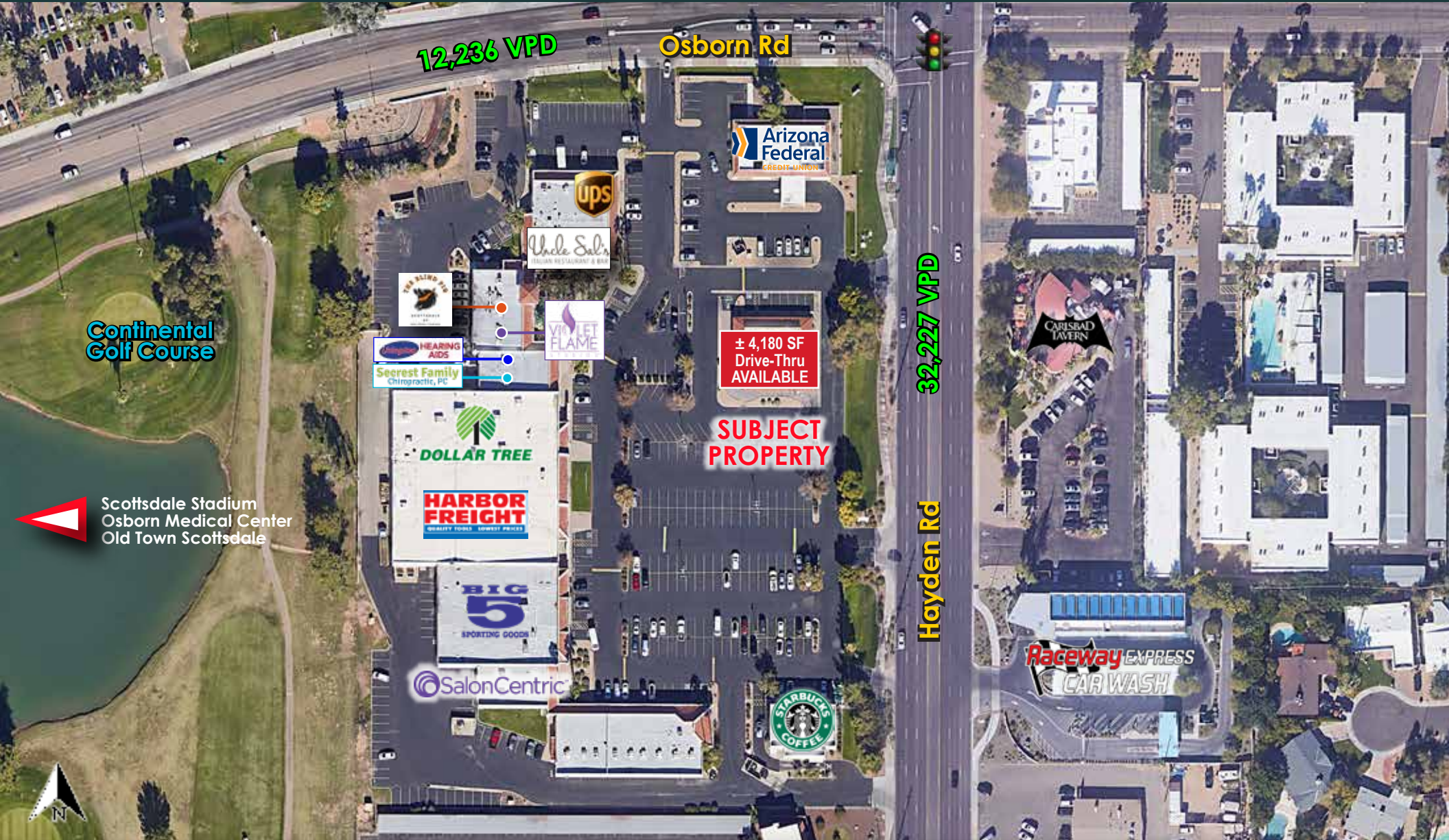

7339 E McDonald Drive
Scottsdale, AZ 85250
(O) 480.947.8800
www.dpcr.com

BRANDON VASQUEZ | (C) 480.620.4738
brandon.vasquez@dpcr.com

The information contained herein has been obtained from sources believed reliable. While we do not doubt its accuracy, we have not verified it and make no guarantee, warranty or representation about it. It is your responsibility to independently confirm its accuracy and completeness. Any projections, opinions, assumptions or estimates used for example only, and do not represent the current or future performance of the property. The value of this transaction to you depends on tax and other factors which should be evaluated by your tax, financial & legal advisors. You and your advisors should conduct a careful, independent investigation of the property to determine, to your satisfaction, the suitability of the property for your needs.

FORMER CARL'S JR. FOR LEASE OR SALE

3380 N. Hayden Road, Scottsdale, AZ 85251

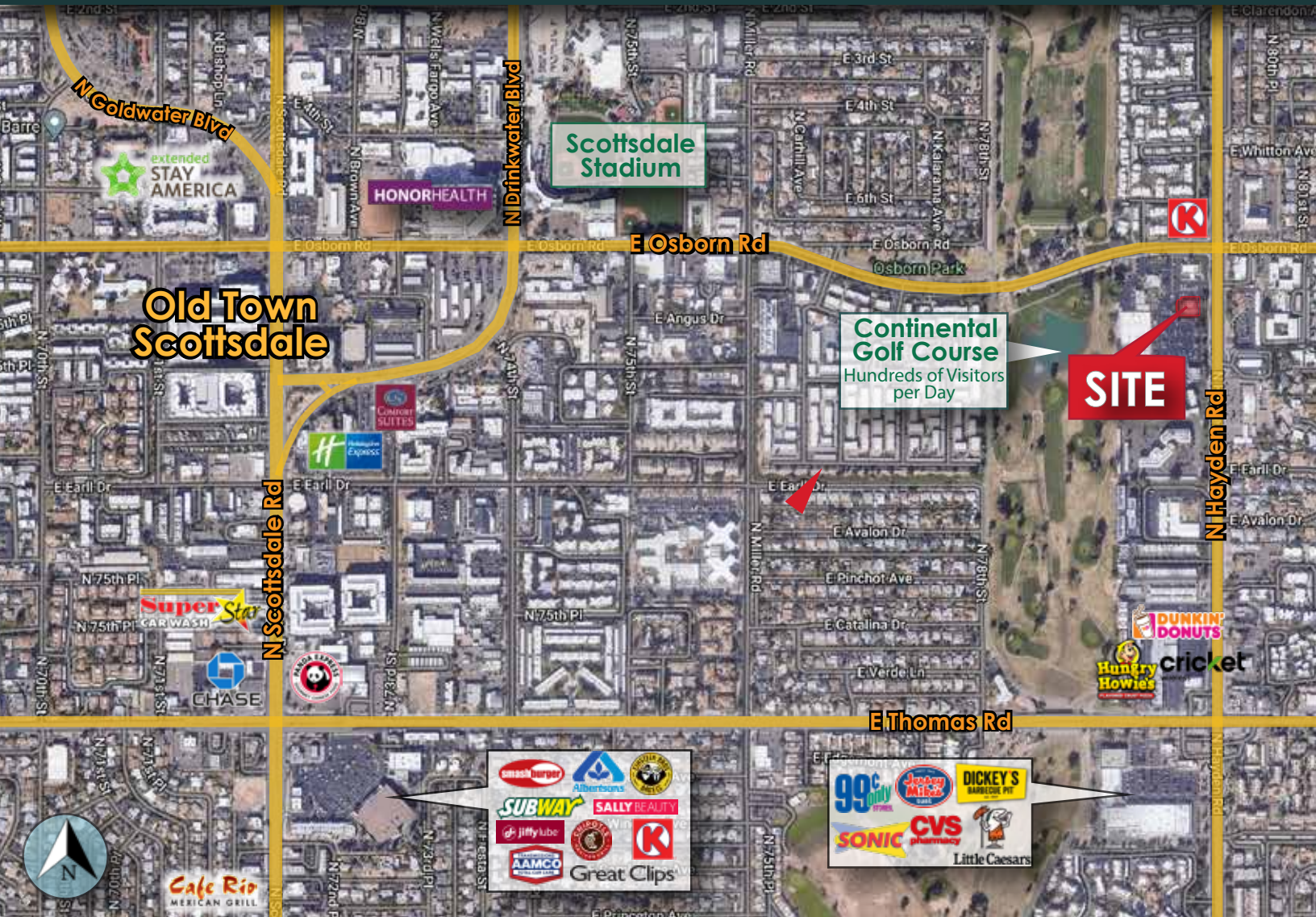

DEMOGRAPHICS 2024

Source: SitesUSA

<p>POPULATION</p>	1 MILE	19,790	<p>HOUSEHOLDS</p>	1 MILE	10,538	<p>AVG. HH INCOME</p>	1 MILE	\$123,078
	3 MILES	100,539		3 MILES	51,630		3 MILES	\$138,522
	5 MILES	222,212		5 MILES	107,186		5 MILES	\$128,398
<p>MEDIAN AGE</p>	1 MILE	37.6	<p>DAYTIME POPULATION</p>	1 MILE	17,290	<p>TRAFFIC COUNTS</p>	Vehicles per Day	
	3 MILES	40.5		3 MILES	86,007		N HAYDEN RD	32,227
	5 MILES	36.8		5 MILES	211,886		E OSBORN RD	12,236

Source: CoStar Group 2024

FORMER CARL'S JR. FOR LEASE OR SALE

3380 N. Hayden Road, Scottsdale, AZ 85251

4,180 SF w/ Drive - Thru

FOR MORE INFORMATION, PLEASE CONTACT:



BRANDON VASQUEZ

Cell: 480.620.4738

brandon.vasquez@dpcr.com



7339 E. McDonald Drive
Scottsdale, AZ 85250
(O) 480.947.8800 | (F) 480.947.8830
www.dpcr.com