

For Sale

1015 Crocker St #R-17
Los Angeles, CA 90021

Commercial Condo Unit in San Pedro Wholesale Mart Annex

For more information, please contact:

Daniel Park

(213) 446-0396

Danielpark777@hotmail.com

DRE# 01227056

PARK INDUSTRIAL

SPECIALIZING IN INDUSTRIAL REAL ESTATE SERVICES

Park Industrial Realty
800 McGarry St, 5th Floor
Los Angeles, CA 90021
Corporation DRE# 01983713

Property Information

1015 Crocker St, #R-17, Los Angeles, CA 90021

Unit SF: 629 SF

Year Built: 2003

Clear Height: 12 feet

Opportunity Zone: Yes

Zoning: M2

Sale Price: \$295,000

Sale Price/SF: \$469.00/SF

- Commercial condo unit in DTLA San Pedro Wholesale Mart Annex
- In the heart of Fashion District
- Second floor unit located third from the elevator
- Great opportunity for owner user
- Dedicated on-site covered parking

All information has been furnished from sources which we deem reliable, but for which we assume no liability. All measurements are approximate. Broker/Owner do not warrant its accuracy. Buyer/Lessee must verify all information.

Area Map

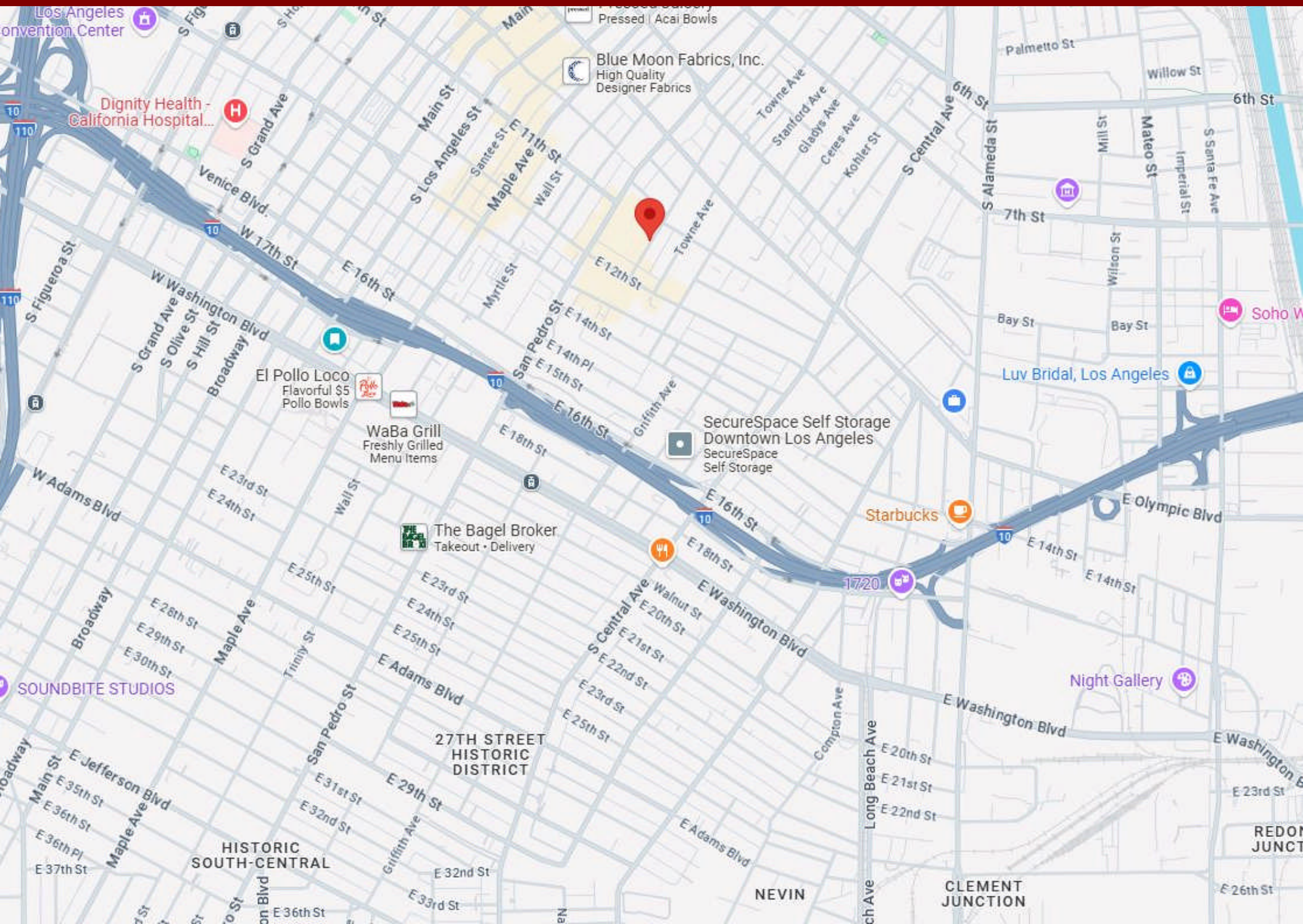

Floor Map

LOWER BASEMENT LEVEL

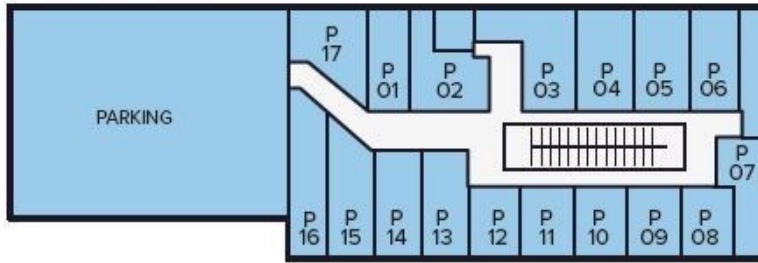

GROUND LEVEL

CROCKER ST

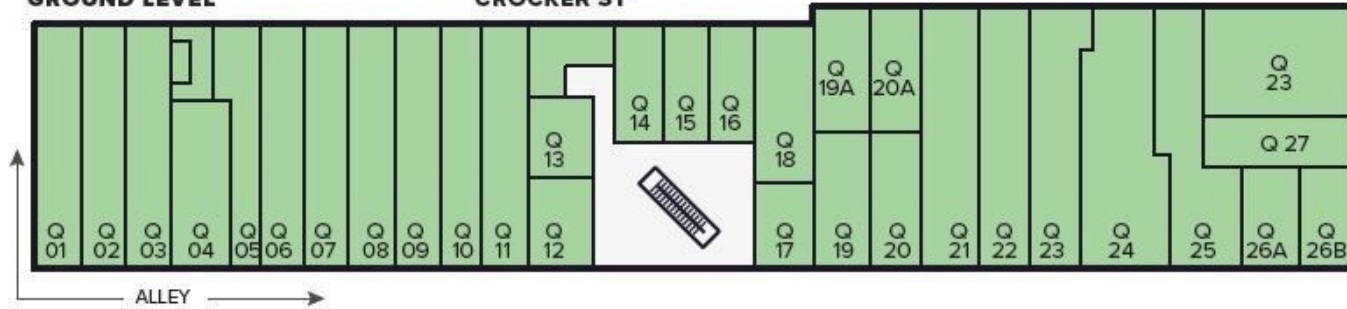

SECOND LEVEL

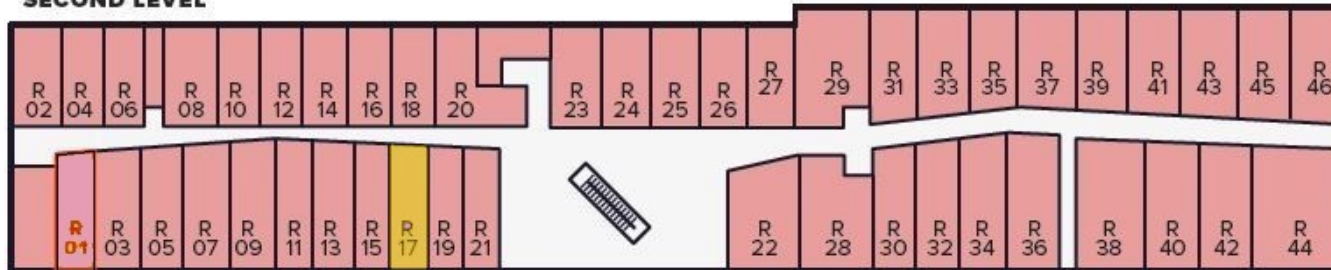

BRIDGE ACCESS

THIRD LEVEL

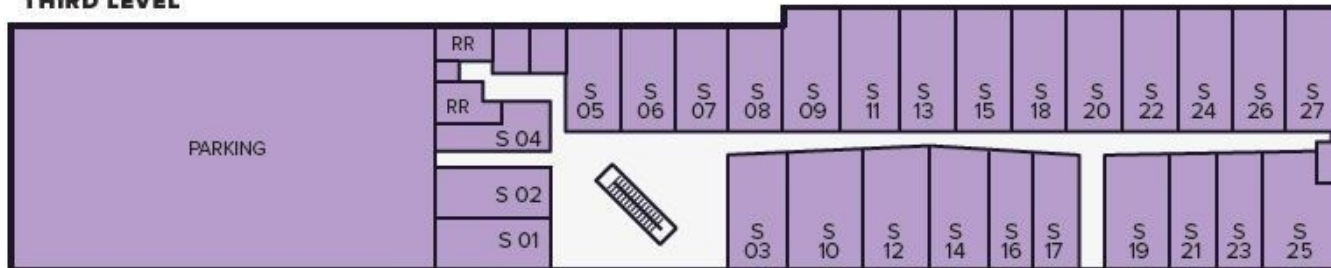

BRIDGE ACCESS

Property Photo



Property Photo



Property Photo

