

LAND FOR SALE

3455 SE GATEWAY DR GRIMES, IA 50111



OFFERING SUMMARY

Lot	Lot Size	Price PSF	Total Price
Lot 1	2.0 Acres	\$14.00 PSF	\$1,220,000
Lot 2	1.6 Acres	\$10.00 PSF	\$700,000
Lots 1 & 2	3.6 Acres	\$12.25 PSF	\$1,920,000

PROPERTY HIGHLIGHTS

- 1.6 - 3.6 acres available
- Flexible lot sizes to meet user needs
- Located in rapidly growing Grimes
- High visibility location with over 36,800 VPD
- Highway 141 frontage
- Excellent access to I-80 / I-35 (1/4 mile south)
- Zoning: M-1A (Light Industrial)
- Adjacent to Canoyer's Garden Center
- Ideal for light industrial, service, flex, or commercial

3455 SE GATEWAY DR

GRIMES, IA 50111

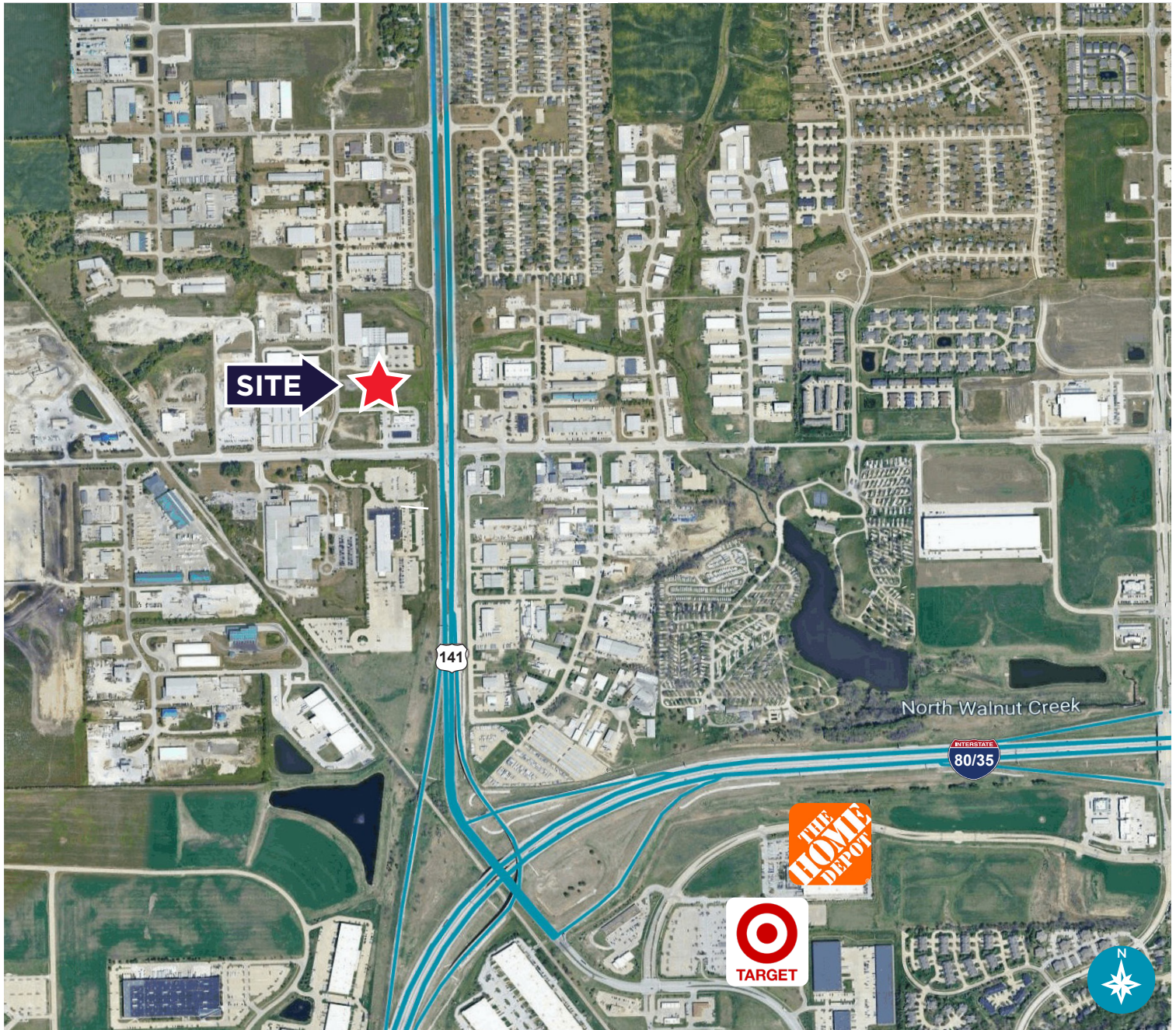

CONTACT

CHRISTOPHER STAFFORD, CCIM

515 554 0999
cstafford@iowaca.com

KURT MUMM, CCIM

515 778 8794
kmumm@iowaca.com

DEMOGRAPHICS

	1 Mile	3 Mile	5 Mile
Total Households:	743	34,311	125,649
Total Population:	1,985	88,271	307,520
Avg HH Income:	\$92,850	\$98,184	\$84,854

Independently Owned and Operated / A Member of the Cushman & Wakefield Alliance

©2025 Cushman & Wakefield. All rights reserved. The information contained in this communication is strictly confidential. This information has been obtained from sources believed to be reliable but has not been verified. NO WARRANTY OR REPRESENTATION, EXPRESS OR IMPLIED, IS MADE AS TO THE CONDITION OF THE PROPERTY (OR PROPERTIES) REFERENCED HEREIN OR AS TO THE ACCURACY OR COMPLETENESS OF THE INFORMATION CONTAINED HEREIN, AND SAME IS SUBMITTED SUBJECT TO ERRORS, OMISSIONS, CHANGE OF PRICE, RENTAL OR OTHER CONDITIONS, WITHDRAWAL WITHOUT NOTICE, AND TO ANY SPECIAL LISTING CONDITIONS IMPOSED BY THE PROPERTY OWNER(S). ANY PROJECTIONS, OPINIONS OR ESTIMATES ARE SUBJECT TO UNCERTAINTY AND DO NOT SIGNIFY CURRENT OR FUTURE PROPERTY PERFORMANCE.