

**CAPE MAY COURT HOUSE, NJ - PAD SITE**

1301 ROUTE 9 SOUTH, CAPE MAY COURT HOUSE, NJ 08210



**OFFERING SUMMARY**

Available SF: 2,500 - 4,000 SF

Lease Rate: Call For Details

**NEIGHBORING TENANTS**



**PROPERTY OVERVIEW**

Available Immediately: Land for Lease Adjacent to Peace Token Fishing Tackle and near Home Depot

**PROPERTY HIGHLIGHTS**

- Available Immediately
- Pad Site on 3.05 Acre Parcel
- Anchored by Peace Token Fishing Tackle
- Excellent for Bank or Medical Use
- Prime Retail Site at Signalized Intersection
- Great Visibility
- Convenient Access to Garden State Parkway

FOR MORE INFORMATION CONTACT:

**JOHN T. OSTROWSKI**  
201.703.9700 x121  
jostrowski@thegoldsteingroup.com



THEGOLDSTEINGROUP.COM

Licensed Real Estate Broker | 45 EISENHOWER DRIVE | SUITE 246 | PARAMUS, NJ 07652

All information is from sources deemed reliable and is submitted subject to errors, omissions, change of price, terms, rental, prior sale and withdrawal without notice.

**CAPE MAY COURT HOUSE, NJ - PAD SITE**

1301 ROUTE 9 SOUTH, CAPE MAY COURT HOUSE, NJ 08210



FOR MORE INFORMATION CONTACT:

**JOHN T. OSTROWSKI**  
201.703.9700 x121  
jostrowski@thegoldsteingroup.com

Licensed Real Estate Broker | 45 EISENHOWER DRIVE | SUITE 246 | PARAMUS, NJ 07652

All information is from sources deemed reliable and is submitted subject to errors, omissions, change of price, terms, rental, prior sale and withdrawal without notice.



THEGOLDSTEINGROUP.COM

**CAPE MAY COURT HOUSE, NJ - PAD SITE**

1301 ROUTE 9 SOUTH, CAPE MAY COURT HOUSE, NJ 08210



Google

Imagery ©2024 Airbus, Landsat / Copernicus, Maxar Technologies, U.S. Geological Survey, USDA/FPAC/GEO

FOR MORE INFORMATION CONTACT:

**JOHN T. OSTROWSKI**  
201.703.9700 x121  
jostrowski@thegoldsteingroup.com

Licensed Real Estate Broker | 45 EISENHOWER DRIVE | SUITE 246 | PARAMUS, NJ 07652

All information is from sources deemed reliable and is submitted subject to errors, omissions, change of price, terms, rental, prior sale and withdrawal without notice.



THEGOLDSTEINGROUP.COM

**CAPE MAY COURT HOUSE, NJ - PAD SITE**  
1301 ROUTE 9 SOUTH, CAPE MAY COURT HOUSE, NJ 08210

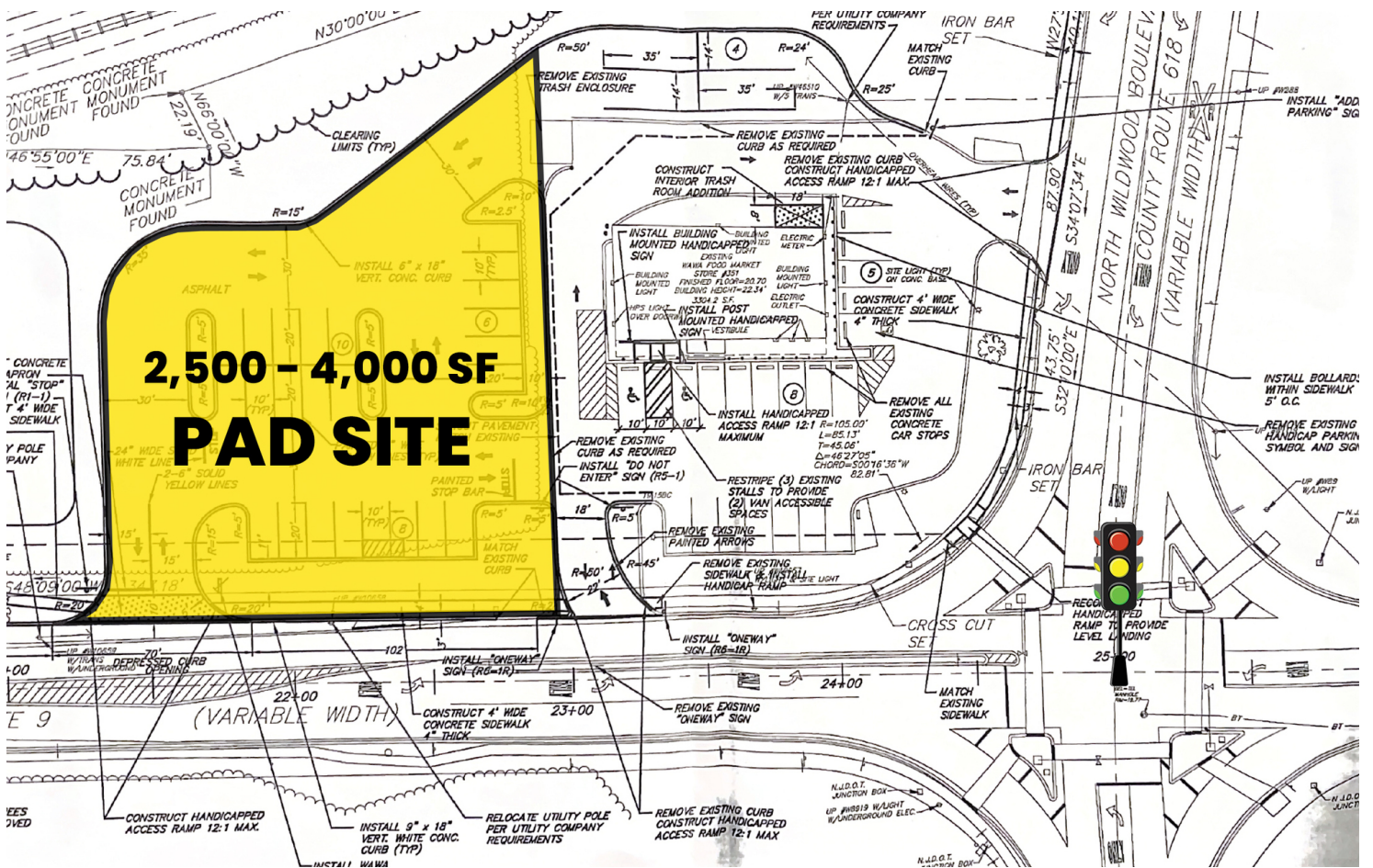

FOR MORE INFORMATION CONTACT:

**JOHN T. OSTROWSKI**  
201.703.9700 x121  
jostrowski@thegoldsteingroup.com

Licensed Real Estate Broker | 45 EISENHOWER DRIVE | SUITE 246 | PARAMUS, NJ 07652

All information is from sources deemed reliable and is submitted subject to errors, omissions, change of price, terms, rental, prior sale and withdrawal without notice.



THEGOLDSTEINGROUP.COM

**CAPE MAY COURT HOUSE, NJ - PAD SITE**

1301 ROUTE 9 SOUTH, CAPE MAY COURT HOUSE, NJ 08210

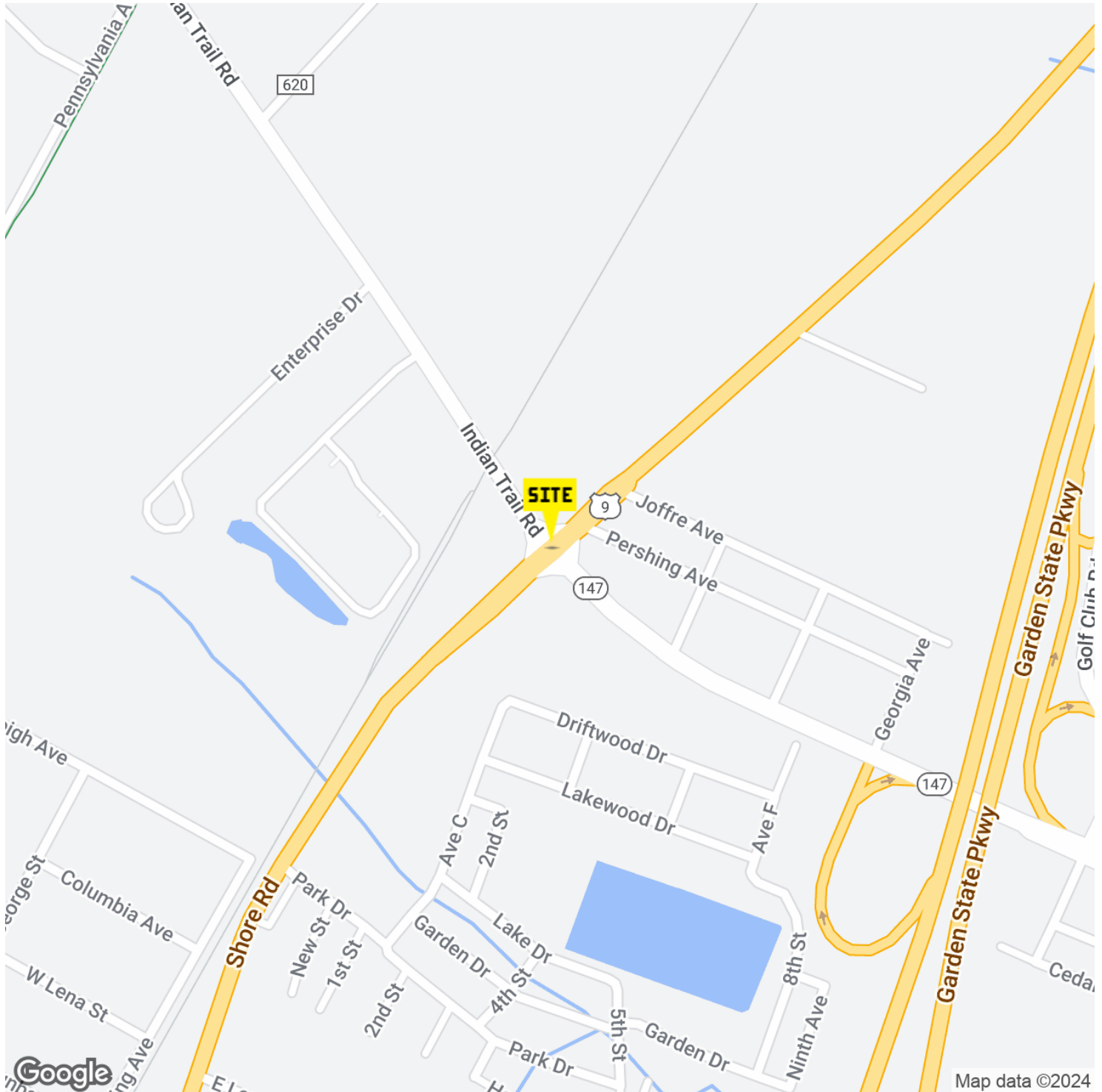

FOR MORE INFORMATION CONTACT:

**JOHN T. OSTROWSKI**  
201.703.9700 x121  
jostrowski@thegoldsteingroup.com

Licensed Real Estate Broker | 45 EISENHOWER DRIVE | SUITE 246 | PARAMUS, NJ 07652

All information is from sources deemed reliable and is submitted subject to errors, omissions, change of price, terms, rental, prior sale and withdrawal without notice.



THEGOLDSTEINGROUP.COM

**CAPE MAY COURT HOUSE, NJ - PAD SITE**

1301 ROUTE 9 SOUTH, CAPE MAY COURT HOUSE, NJ 08210

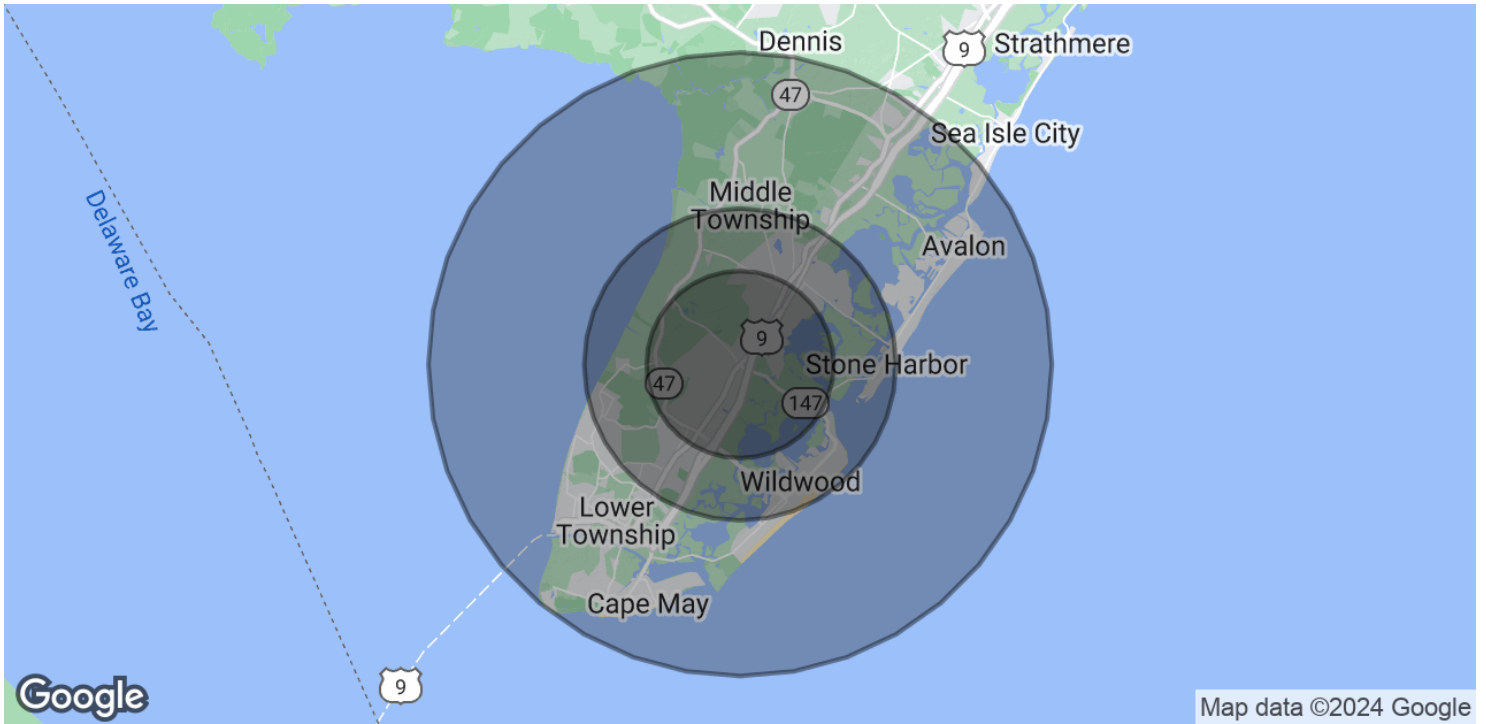

POPULATION	3 MILES	5 MILES	10 MILES
Total Population	9,932	34,723	62,182
Average Age	43.2	46.3	48.3
Average Age (Male)	41.2	44.7	46.1
Average Age (Female)	43.6	47.0	50.1
HOUSEHOLDS & INCOME	3 MILES	5 MILES	10 MILES
Total Households	5,668	33,905	64,374
# of Persons per HH	1.8	1.0	1.0
Average HH Income	\$61,851	\$40,086	\$40,099
Average House Value	\$241,665	\$292,569	\$361,868

\* Demographic data derived from 2020 ACS - US Census

FOR MORE INFORMATION CONTACT:

**JOHN T. OSTROWSKI**  
201.703.9700 x121  
jostrowski@thegoldsteingroup.com

Licensed Real Estate Broker | 45 EISENHOWER DRIVE | SUITE 246 | PARAMUS, NJ 07652

All information is from sources deemed reliable and is submitted subject to errors, omissions, change of price, terms, rental, prior sale and withdrawal without notice.



THEGOLDSTEINGROUP.COM