

Area Analysis performed in accordance with ANSI/BOMA Z65.1 - 2017 Method A Standard.

Project: C21-1318

Date	Action
12/27/2021	Initial Site Measure
C21-1318	

Client:

Key Choice Comml Real Estate
6116 211th St SW Suite 203
Lynnwood, WA 98036

Site:

Office Building
210 Morris St
La Conner, WA 98257

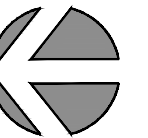

Lease Plan

2

Floor

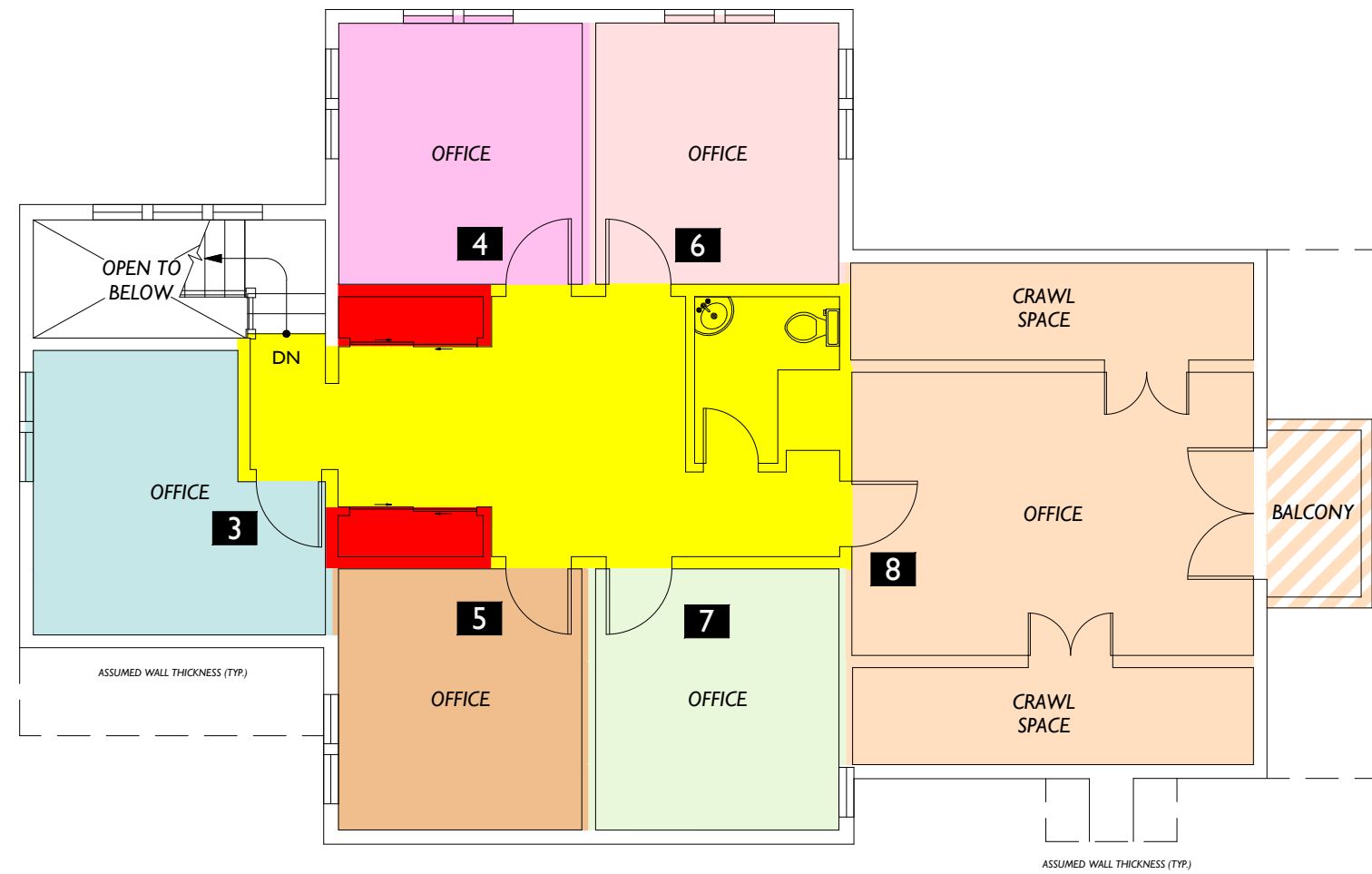

Morris St

Floor Summary	SQ. FT.
Total Rentable Area	2,865.61
Total Occupant Area	1,181.08
Load Factor	2.426259
Floor Service Area	299.17
Building Service Area	41.89

Suite #	Occupant Area	Rentable Area
Suite 3	153.60	372.67
Suite 4	139.41	338.24
Suite 5	138.63	336.35
Suite 6	139.54	338.56
Suite 7	140.47	340.82
Suite 8*	469.43	1,138.96

Area Analysis performed in accordance with ANSI/BOMA Z65.1 - 2017 Method A Standard.
*Area includes a Limited Headspace Area (186.79 sq. ft.)

