



PARKWAY EAST BUSINESS PARK

14.344 +/- Acres



RODI PLAZA I, II, & III

RODI ROAD

ROUTE 376 PARKWAY EAST

PRIME COMMERCIAL LAND

FOR SALE

Rodi Road & Purity Road
Pittsburgh PA 15235

David Hanley • Broker • 412.261.6532 x237 • david@prudentialrealty.com

Michael Damian • Commercial Brokerage • 412.261.6532 x253 • michael@prudentialrealty.com

PROPERTY HIGHLIGHTS

FEATURES:

- Prime commercial property consisting of 14.344 +/- acres on Rodi Road & Purity Road right off the Parkway East Exit at Rodi Road
- Approximately 26,000-64,000 vehicles per day
- Zoning: M - Mixed Use

SIZE:

14.344 +/- acres
undeveloped land

LOT & BLOCK:

451-N-375 | 451-P-398 | 451-N-366

SALE PRICE:

REDUCED SALE PRICE: \$1,700,000 or
\$118,516 per acre

CONTACT:

David Hanley - 412.261.6532 x237

Michael Damian - 412.261.6532 x253

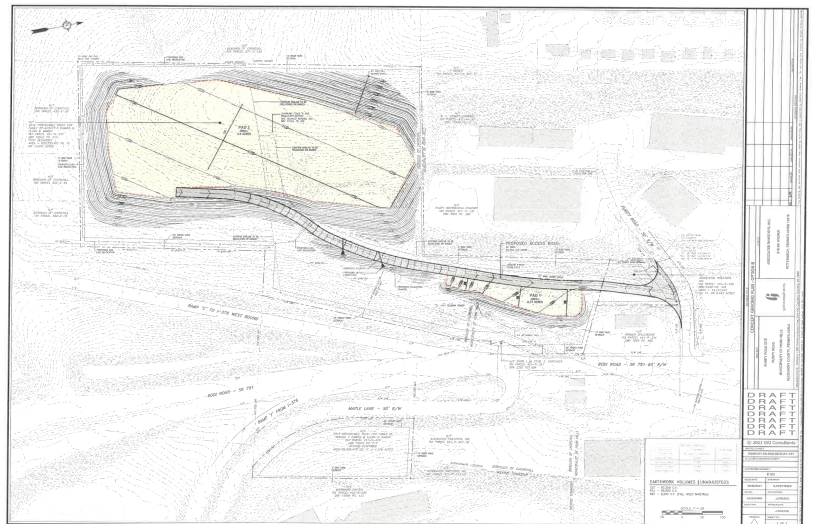
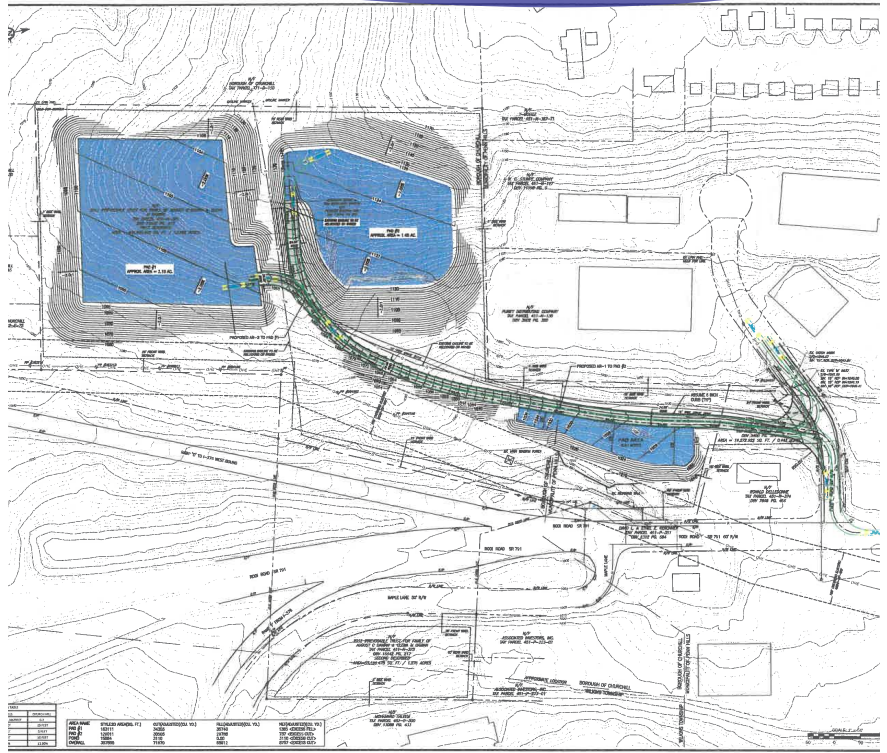

All information furnished regarding this property for sale, rental, or financing is from sources deemed reliable but no warranty or representation is made as to the accuracy thereof and same is submitted subject to errors, omissions, change of price, rental or other conditions prior to sale, lease, financing or withdrawal without notice. PRC Commercial will make no representation and assume no obligation regarding the presence or absence of toxic or hazardous waste or substances or other undesirable material on or about the property that will ultimately be leased or purchased.

LOCATION & DEMOGRAPHICS

DEMOGRAPHICS:	1 MILE	3 MILES	5 MILES
2024 Population	6,044	80,060	209,846
Median HH Income	\$65,854	\$54,757	\$56,272

