

FOR LEASE

43 CHASNER STREET HEMPSTEAD, NEW YORK



TOTAL BUILDING SIZE:

9,000 +/- Sq. Ft.

SPACE AVAILABLE

5,880 +/-

OFFICE SPACE:

YES

LEASE PRICE:

\$19.50 PSF.

CEILING HEIGHT:

14' +/- CEILINGS

POWER:

SEPARATELY METERED

HEAT:

GAS- SEPARATELY METERED

LOADING:

1 OVERHEAD DOOR

COMMENTS:

- CLOSE TO SOUTHERN STATE PARKWAY
- JUST OFF HEMPSTEAD TURNPIKE & WEST PENINSULA BOULEVARD
- NEAR BUSES

FOR INFORMATION AND INSPECTION,
PLEASE CALL, EXCLUSIVE AGENTS:

JOSHUA BROTTOR

AMOS BROTTOR

jbrotter@douglaspayton.com

(516) 829-7400

DOUGLAS, PAYTON & COMPANY, INC. 505 NORTHERN BOULEVARD, GREAT NECK, NEW YORK 11021

COMMERCIAL REAL ESTATE SERVICES

All information is submitted subject to errors, omissions, change of rental price, sale price, or other conditions, prior sale, lease or financing, or withdrawn from the market with out notice.

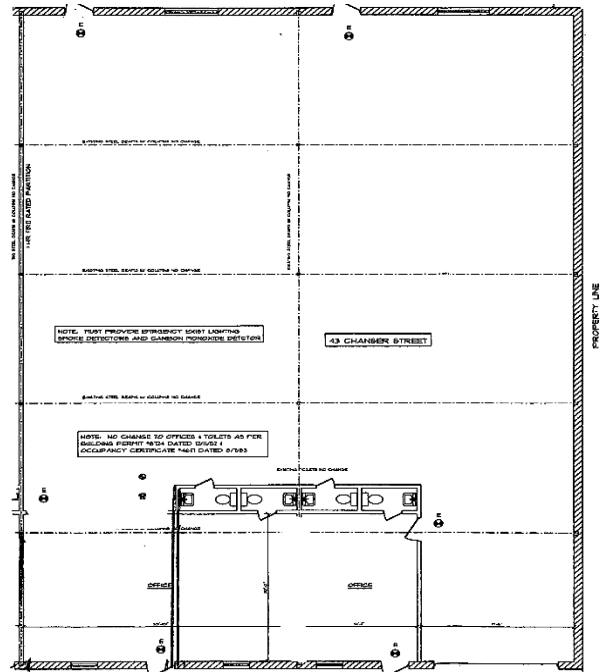

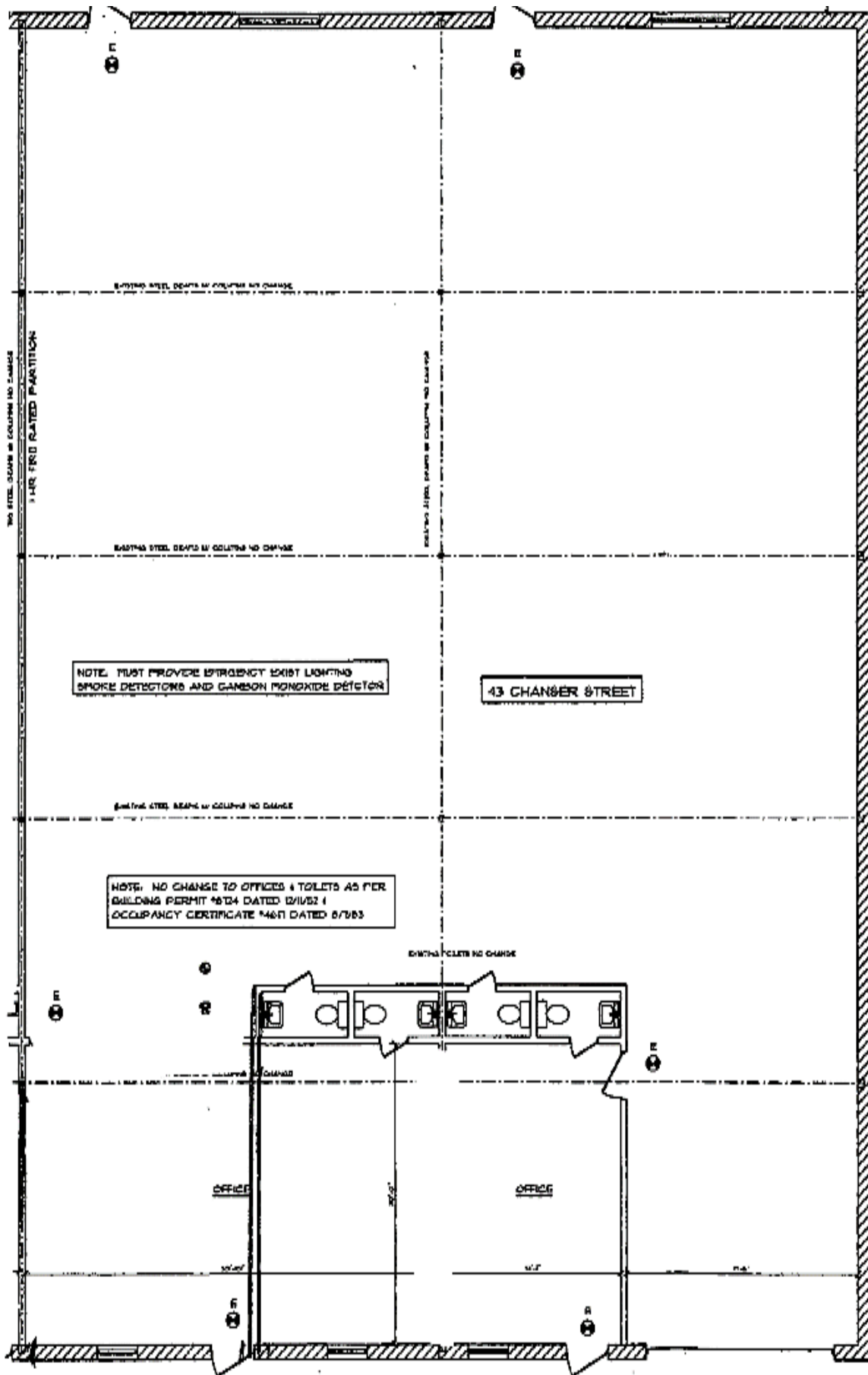

NO STEEL BEAMS IN COLUMN NO CHANGE
 1 HR FIRE RATED PARTITION

EXISTING STEEL BEAMS IN COLUMN NO CHANGE

EXISTING STEEL BEAMS IN COLUMN NO CHANGE

EXISTING STEEL BEAMS IN COLUMN NO CHANGE

NOTE: MUST PROVIDE EXISTING LIGHTING SMOKE DETECTORS AND CARBON MONOXIDE DETECTOR

43 CHAMBER STREET

EXISTING STEEL BEAMS IN COLUMN NO CHANGE

NOTE: NO CHANGE TO OFFICES & TOILETS AS PER BUILDING PERMIT #024 DATED 02/11/02 & OCCUPANCY CERTIFICATE #4611 DATED 07/03

EXISTING TOILETS NO CHANGE

PROPERTY LINE

OFFICE

OFFICE