



Retail, Medical, & Office | For Lease | 11,015 SF Available | 10 Units

VILLAGE ON MAIN

Contact for Pricing | 161 South Riverfront Drive
Jenks, OK 74037



DREW DOSSEY

Sales Associate

918.740.7707

ddossey@mcgrawcp.com

PATRICK HALLOCK

Sales Associate

918.294.6377

phallock@mcgrawcp.com

Property Highlights

Desirable Tenant Mix

- Hatch Restaurant & Sidecar wine bar Anchors
- Located within Downtown Jenks
- Multiple spaces available with TI allowance
- Landlord to deliver space in warm shell condition
- 727 Lofts, Thrive Jenks Apartments, and First Oklahoma Bank within walking distance
- Easy access to Tulsa Premium Outlets and Aquarium Drive Possible development potential with LOMR-F
- Jenks Riverwalk Access
- Ample of Parking
- Turnkey Office / Retail / Medical Office

Retail, Medical, & Office | For Lease | Contact for Pricing

PROPERTY PHOTOS

161 SOUTH RIVERFRONT DRIVE | JENKS, OK 74037



DREW DOSSEY
Sales Associate
918.740.7707
ddossey@mcgrawcp.com

PATRICK HALLOCK
Sales Associate
918.294.6377
phallock@mcgrawcp.com

Retail, Medical, & Office | For Lease | Contact for Pricing

PROPERTY PHOTOS

161 SOUTH RIVERFRONT DRIVE | JENKS, OK 74037



DREW DOSSEY
Sales Associate
918.740.7707
ddossey@mcgrawcp.com

PATRICK HALLOCK
Sales Associate
918.294.6377
phallock@mcgrawcp.com

Retail, Medical, & Office | For Lease | Contact for Pricing

FLOORPLAN

161 SOUTH RIVERFRONT DRIVE | JENKS, OK 74037

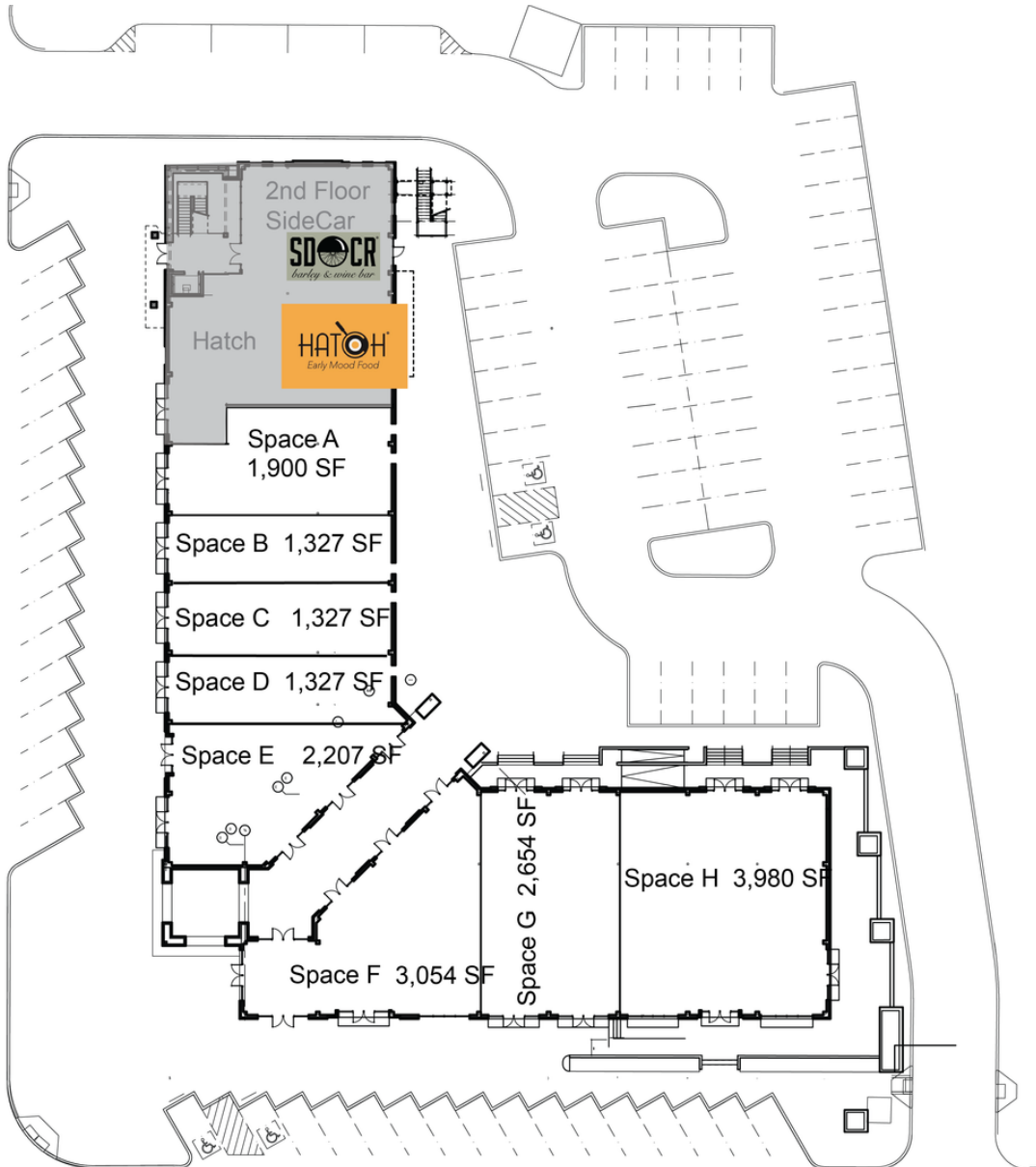

DREW DOSSEY
Sales Associate
918.740.7707
ddossey@mcgrawcp.com

PATRICK HALLOCK
Sales Associate
918.294.6377
phallock@mcgrawcp.com

Retail, Medical, & Office | For Lease | Contact for Pricing

LOCATION OVERVIEW

161 SOUTH RIVERFRONT DRIVE | JENKS, OK 74037

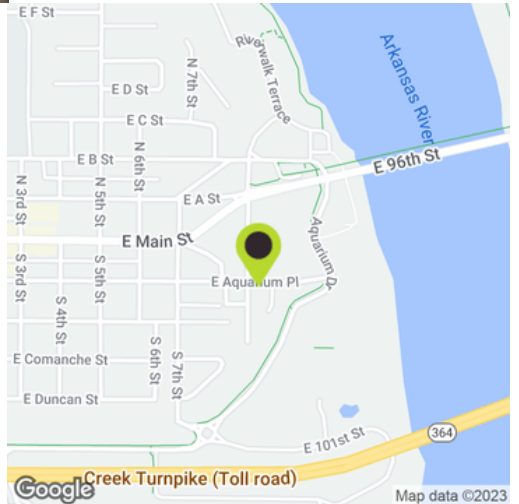

DREW DOSSEY
Sales Associate
918.740.7707
ddossey@mcgrawcp.com

PATRICK HALLOCK
Sales Associate
918.294.6377
phallock@mcgrawcp.com

Retail, Medical, & Office | For Lease | Contact for Pricing

COMMUNITY OVERVIEW

161 SOUTH RIVERFRONT DRIVE | JENKS, OK 74037

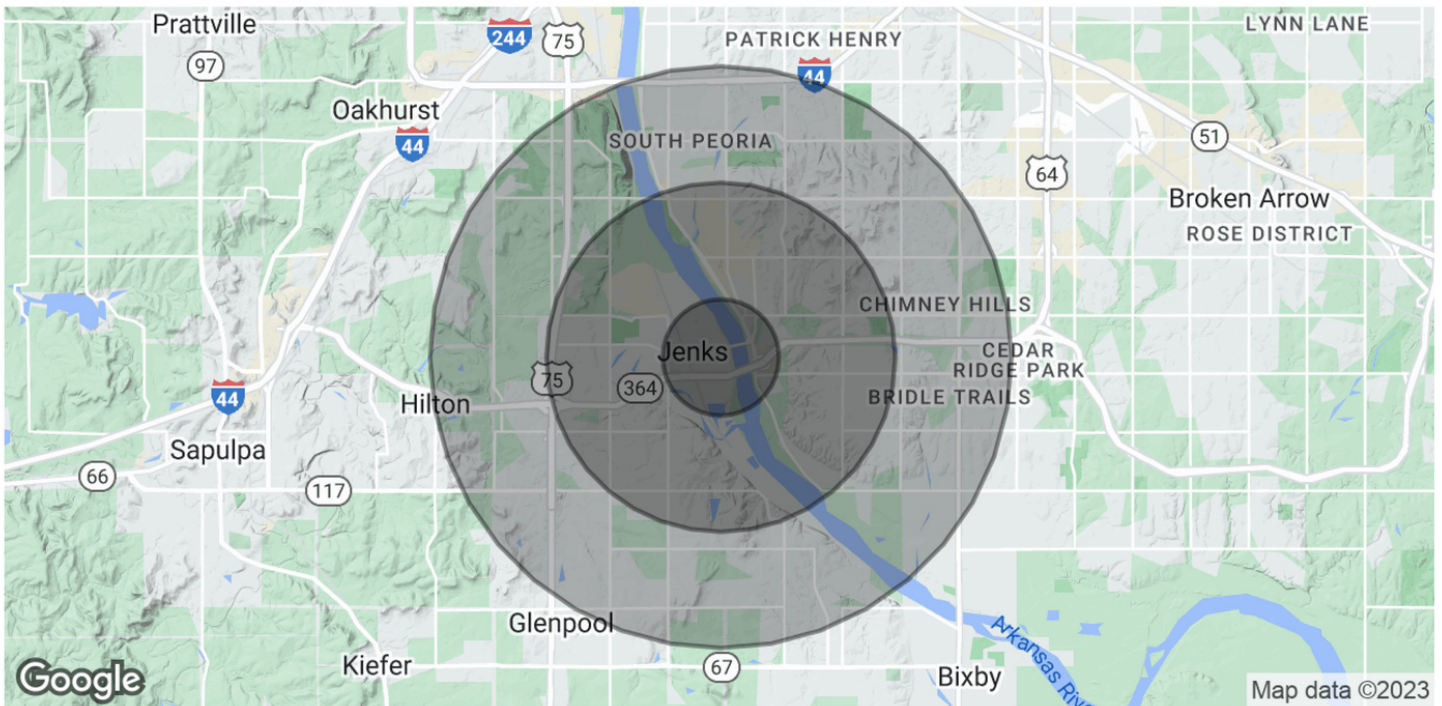

POPULATION	1 MILE	3 MILES	5 MILES
Total Population	4,352	53,237	149,474
Average Age	32.6	37.4	38.6
Average Age (Male)	32.2	36.6	37.5
Average Age (Female)	34.3	38.5	39.7
HOUSEHOLDS & INCOME	1 MILE	3 MILES	5 MILES
Total Households	2,332	22,015	65,961
# of Persons per HH	1.9	2.4	2.3
Average HH Income	\$57,943	\$98,963	\$91,594
Average House Value	\$100,010	\$214,902	\$213,759

* Demographic data derived from 2020 ACS - US Census



DREW DOSSEY
Sales Associate
918.740.7707
ddossey@mcgrawcp.com

PATRICK HALLOCK
Sales Associate
918.294.6377
phallock@mcgrawcp.com