

LOCATION

1427 Youngstown Rd SE, Warren, OH 44484

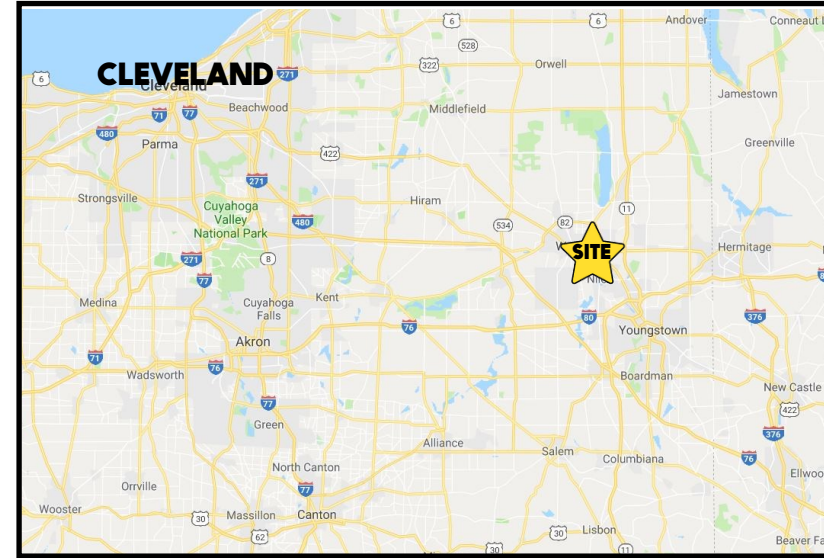

3D TOUR [Tour](#)

HIGHLIGHTS

- Highly Desirable Trumbull County Location
- Easy Access to Route 11, I-76, I-80
- Currently occupied. Tenant may be willing to extend or, ideally suited for Owner occupant
- Investors: Building could be split in to smaller spaces for easier rental

CONTACT

DON THOMAS

501.269.3827

dthomas@platzrealtygroup.com

Office: 330.757.4889 | Fax: 330.294.5622 | 3830 Starr Centre Dr, Suite 2, Canfield, OH 44406

www.PLATZREALTYGROUP.com



Office: 330.757.4889 | Fax: 330.294.5622 | 3830 Starr Centre Dr, Suite 2, Canfield, OH 44406

www.PLATZREALTYGROUP.com

The information presented was obtained from sources believed to be true and reliable. The Platz Realty Group makes no warranties or guarantees to the accuracy of the information.

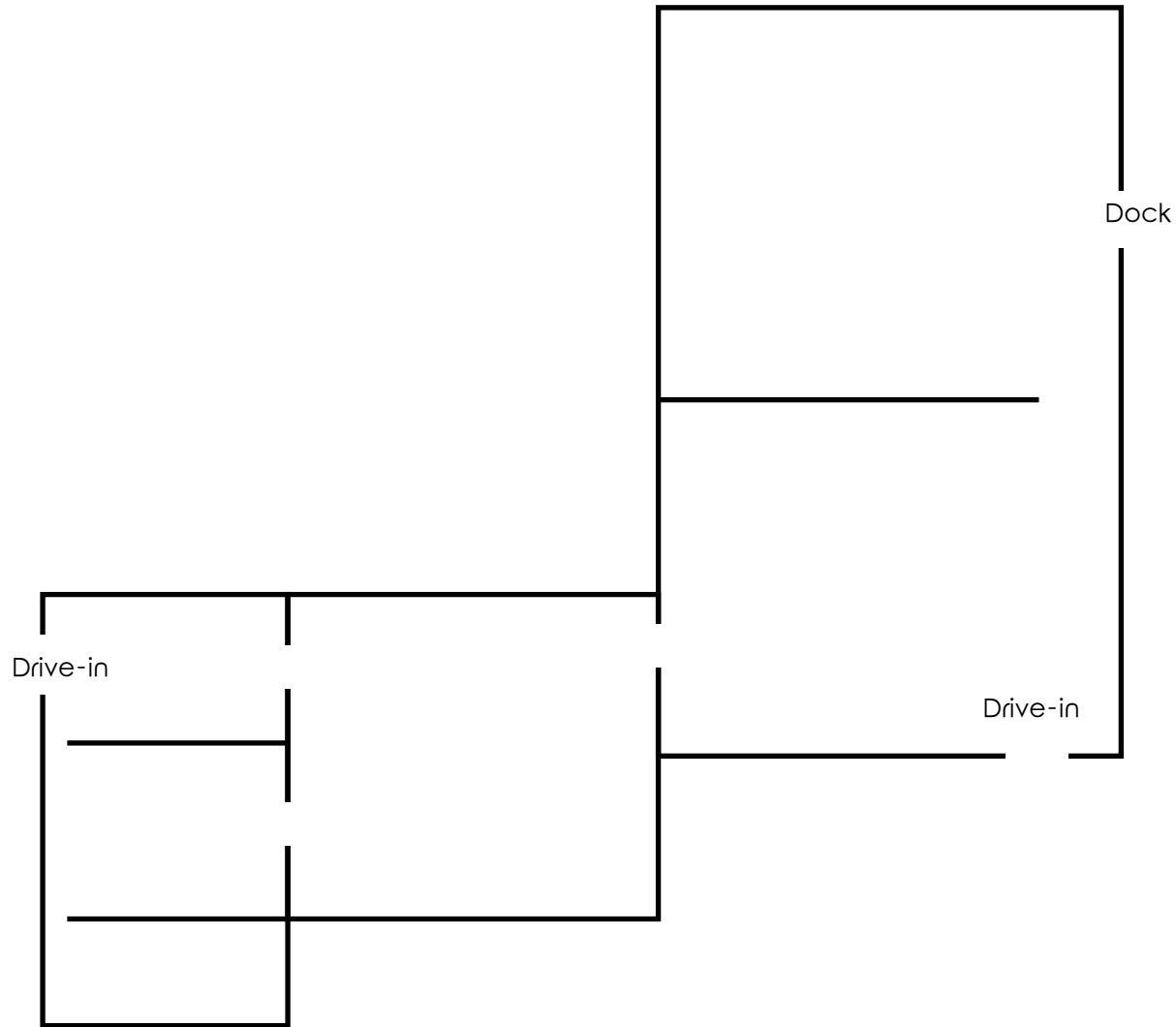

Office: 330.757.4889 | Fax: 330.294.5622 | 3830 Starr Centre Dr, Suite 2, Canfield, OH 44406

www.PLATZREALTYGROUP.com

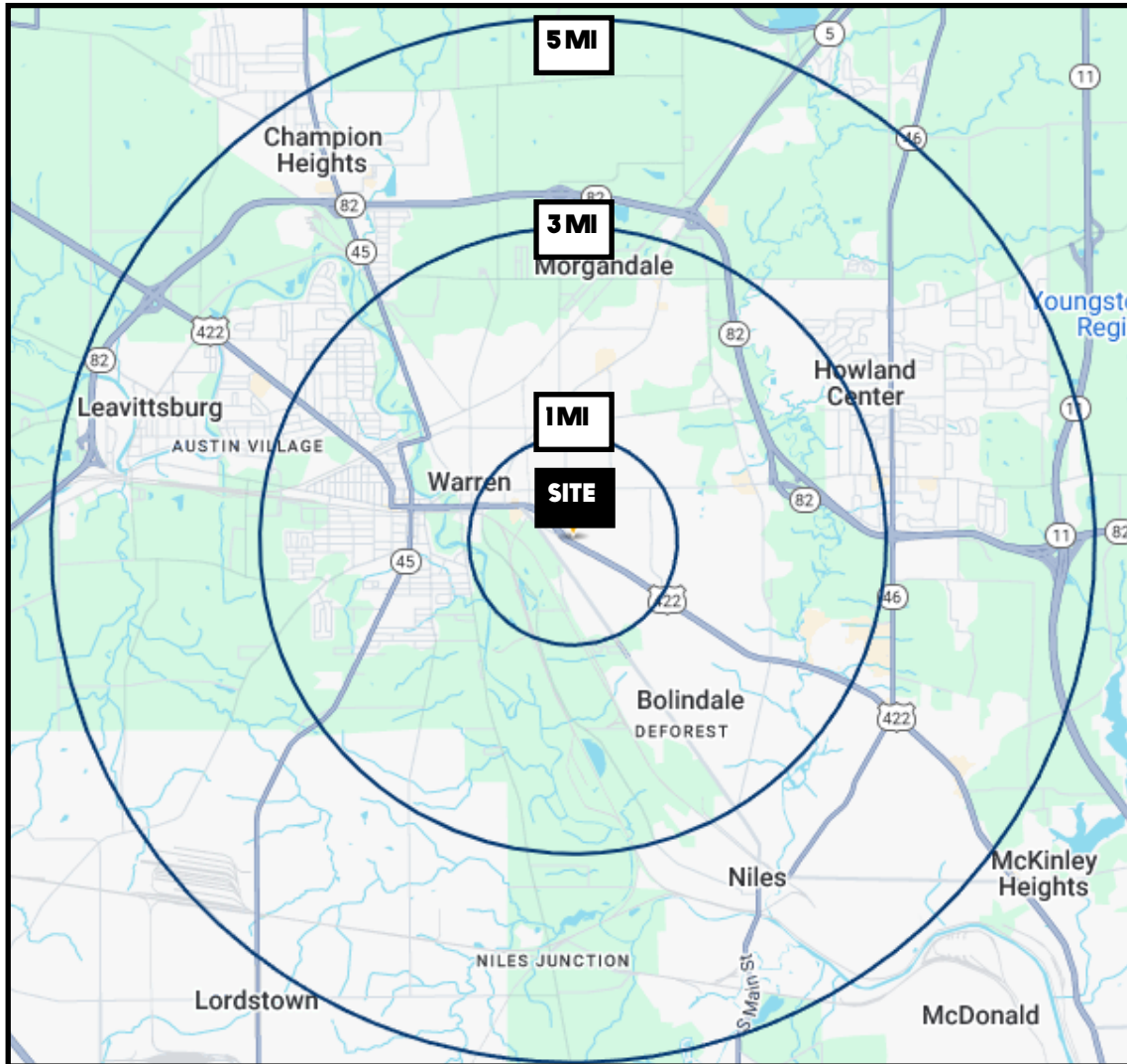

DEMOGRAPHICS	1 MI	3 MI	5 MI
POPULATION	8,928	47,248	90,129
HOUSEHOLDS	3,788	20,316	38,982
MEDIAN AGE	38	41	42
AVERAGE HH INCOME	\$45,646	\$46,583	\$58,069

SITE INFORMATION	
LOCATION	Warren City Trumbull County
PARCELS	38-519250, 38-519370, 38-519300, 38-452525
SIZE	17,942 SF on .6 acres
CEILING HEIGHT	12' -14'
YEAR BUILT	1936, 1971, 1980
POWER	400 amp / 220 / Single
REAL ESTATE TAXES	\$7,522/year
PRICE	\$549,000 REDUCED \$499,500

Office: 330.757.4889 | Fax: 330.294.5622 | 3830 Starr Centre Dr, Suite 2, Canfield, OH 44406