



INDUSTRIAL PROPERTY FOR LEASE

**2235 & 2239 OLD MIDDLEFIELD WAY
MOUNTAIN VIEW, CA 94043**

ERIC JONG

(669) - 300 - 6048

eric@guggenheimrgi.com

CalDRE #01486494

AL GUGGENHEIM

(669) - 300 - 6041

al@guggenheimrgi.com

CalDRE #00943363

(669) - 300 - 6040 GUGGENHEIMRGI.COM CalDRE #01792244

"No warranty or representation expressed or implied is made as to the accuracy of the above information. This information is submitted subject to errors, omissions, change of price, rental rates or other conditions, withdrawal notice, and any special listing conditions."



LEASE RATE
\$2.25 SF/MO NNN

AVAILABLE SF
2,400 SF - 5,228 SF

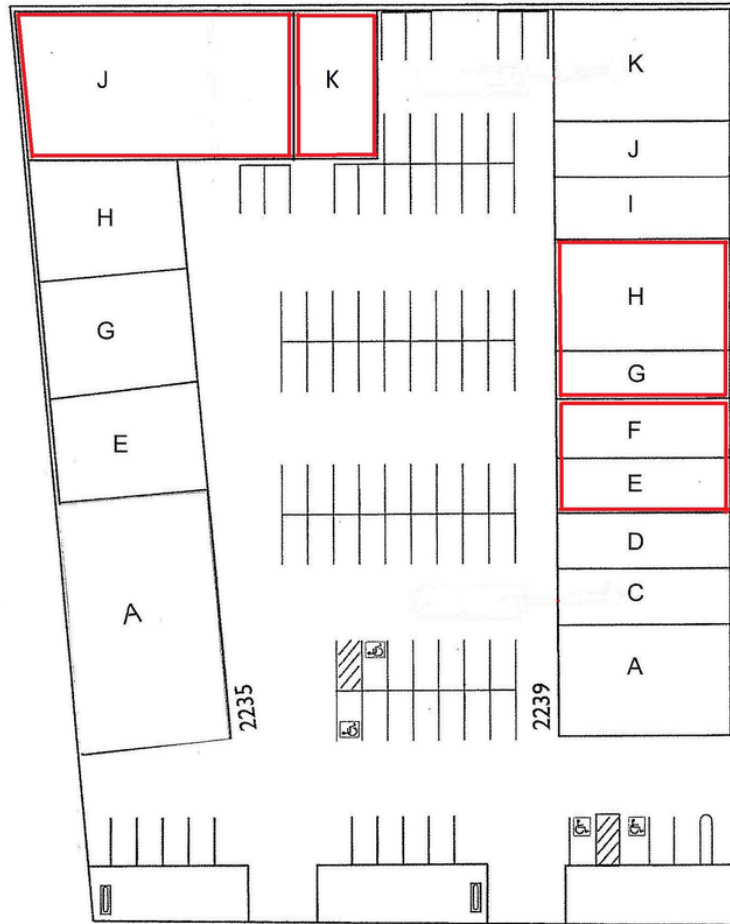

2235 Old Middlefield Way

Site Plan Not To Scale

2239 Old Middlefield Way

OFFERING SUMMARY

Lease Rate: \$2.25 SF/month NNN

Building Size: 2235 Old Middlefield 18,677 SF
2239 Old Middlefield 15,672 SF

Available SF: 2,400 to 5,228 SF Suites

Year Built: 1968

Zoning: MM-40

PROPERTY OVERVIEW

- Property is conveniently located near Hwy 101, 85 and 237
- Grade level doors
- NNN expenses est. \$0.50/sf

BUILDING	SUITE	LEASE RATE	SPACE SIZE
2235	J	\$2.25 SF/MO NNN	5,228 SF
2235	K	\$2.25 SF/MO NNN	2,400 SF
2239	H & G	\$2.25 SF/MO NNN	3,636 SF
2239	E & F	\$2.25 SF/MO NNN	2,400 SF

(669) - 300 - 6040 GUGGENHEIMRGI.COM CaDRE #01792244

"No warranty or representation expressed or implied is made as to the accuracy of the above information. This information is submitted subject to errors, omissions, change of price, rental rates or other conditions, withdrawal notice, and any special listing conditions."